

INSET MAP
TOWN OF GLEN TAX MAP
MONTGOMERY COUNTY NY
SECT. 52.0-4

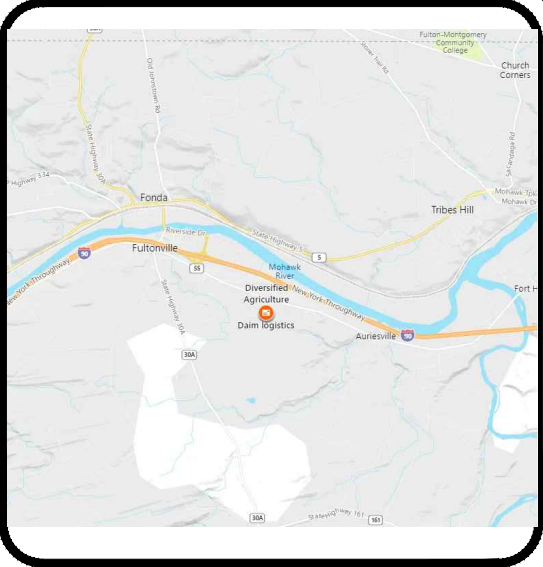

SITE LOCATION MAP
SCALE: N.T.S.

PROJECT INFORMATION:

OWNER/APPLICANT:
DAIM LOGISTICS, INC.
128 PARK DRIVE
FULTONVILLE, NY 12072

PROPERTY TAX MAP NUMBER
52.-4-3.111

PARCEL AREA:
4.6± AC

MUNICIPALITY:
TOWN OF GLEN,
MONTGOMERY COUNTY

ZONING:
INDUSTRIAL - I

SETBACKS:
REQUIRED:
FRONT: 50 FT
SIDE: 20/50 FT
REAR: 30 FT

GENERAL NOTES:

- ALL SURVEY INFORMATION IS REFERENCED TO:
1.1. MAP ENTITLED "SITE PLAN DAIM LOGISTICS, LOT 3 GLEN CANAL VIEW BUSINESS PARK" PREPARED BY ABD ENGINEERS DATED FEBRUARY 2009 AND LAST REVISED MARCH 27, 2009.
1.2. SURVEY UPDATE PREPARED BY GERALD R. GRAY PLS. FROM A FEBRUARY 2021 FIELD SURVEY OF ADJOINING LOT 3. OTHER PLANIMETRIC AND UTILITY FEATURES SHOWN ARE BASED UPON MAP REFERENCE 1.
1.3. OWNER PROVIDED POINT DATA FROM AN AUGUST 2023 EXISTING CONDITION.
- THIS MAP IS NOT A SURVEY. INFORMATION SHOWN IS FROM MAP REFERENCES ABOVE AND FOR GENERAL INFORMATION AND DESIGN PURPOSES ONLY. A LICENSED LAND SURVEYOR SHALL STAKE OUT ANY BUILDINGS OR SEPTIC AREAS TO CONFIRM THE SETBACKS INDICATED.
- NORTH IS REFERENCED TO NAD 83 NEW YORK STATE PLANES EAST ZONE. ELEVATIONS ARE BASED ON MAP REFERENCE 1.
- SUBJECT TO ALL RIGHTS, EASEMENTS, COVENANTS OR RESTRICTION; RECORDED OR UNRECORDED.
- SUBJECT TO ANY STATEMENT OF FACT CONTAINED IN AN UP TO DATE TITLE REPORT OR ABSTRACT OF TITLE
- UNDERGROUND UTILITIES IF SHOWN HEREON ARE BASED ON VISIBLE PHYSICAL EVIDENCE. THEY SHOULD BE CONSIDERED SCHEMATIC ONLY AND ARE SHOWN TO DEPICT GENERAL UTILITY CONNECTIONS RATHER THAN EXACT UNDERGROUND LOCATIONS. NO CERTIFICATION IS MADE AS TO THE ACCURACY OF THE UNDERGROUND UTILITY LOCATIONS AND OTHER UTILITIES MAY EXIST THAT ARE NOT SHOWN ON THIS MAP. CALL DIG SAFE FOR FURTHER VERIFICATION.
- DUE TO SNOW COVERED CONDITIONS AT THE TIME OF THE FIELD SURVEY, CERTAIN BOUNDARY, PLANIMETRIC AND UTILITY FEATURES MAY NOT HAVE BEEN VISIBLE. THEREFORE ARE NOT SHOWN ON THIS MAP.

No.	Revision	Description	Date
1		REVISED PER TDE COMMENTS DTD: 11/17/23	11/22/23

PRIOR TO ANY EARTH DISTURBANCE THE CONTRACTOR SHALL CALL IN A TICKET TO DIG SAFE NY AND OBTAIN A CLEAR TO DIG

IT IS A VIOLATION OF SECTION 7209 OF THE NYS EDUCATION LAW FOR ANY PERSON TO ALTER ANY ITEM ON THIS PLAN IN ANY WAY UNLESS HE/SHE IS ACTING UNDER THE DIRECT SUPERVISION OF A PROFESSIONAL ENGINEER.

CHRISTOPHER D. LONGO, PE
N.Y.S. LIC. # 095840

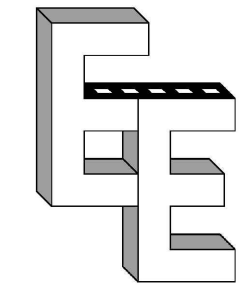

EMPIRE ENGINEERING, PLLC
1900 DUANESBURG ROAD
DUANESBURG, NY 12056
PH: (518) 280-1371
EMAIL: CLONGO@EMPIREENG.NET

PROJECT
LOT 3D PARK DRIVE
GLEN CANAL VIEW PARK
TOWN OF GLEN
MONTGOMERY COUNTY

EXISTING CONDITIONS
MAP
Date: 11/22/2023
Scale: 1"=40'
Job#: 22051
Sheet 1 of 7

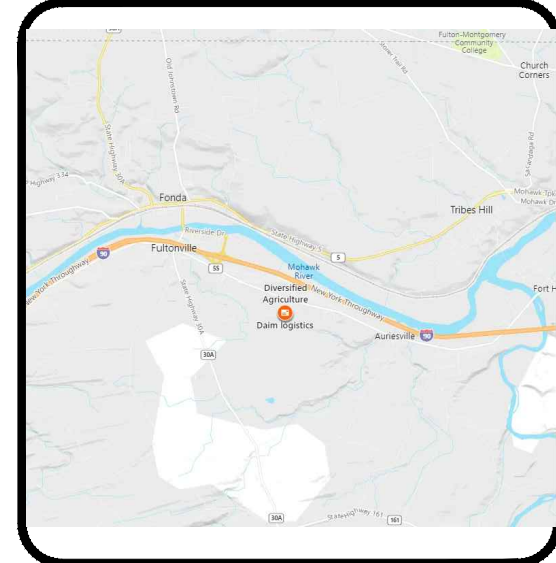
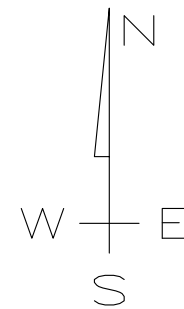

SITE LOCATION MAP
SCALE: N.T.S.

PROJECT INFORMATION:

OWNER/APPLICANT:
DAIM LOGISTICS, INC.
128 PARK DRIVE
FULTONVILLE, NY 12072

PROPERTY TAX MAP NUMBER
52.-4-3.111

PARCEL AREA
4.6± AC

MUNICIPALITY:
TOWN OF GLEN,
MONTGOMERY COUNTY

ZONING: INDUSTRIAL - I

HEIGHT:
REQUIRED: NO MINIMUM
PROPOSED: 32 FT (1 STORY)

AREA:
REQUIRED: NO MINIMUM
EXISTING: 4.6 ACRES

LOT COVERAGE:
REQUIRED: 30 % MAXIMUM
PROPOSED: 12 %

WIDTH/FRONTAGE:
REQUIRED: NO MINIMUM
EXISTING: 655.02 FT

SETBACKS:
REQUIRED:
FRONT: 50 FT
SIDE: 20/50 FT
REAR: 30 FT
PROPOSED:
FRONT: 55 FT
SIDE: 22 FT / 383 FT
REAR: 32 FT

PARKING:
REQUIRED STALL SIZE: 9' X 20'
PROPOSED: 9' X 20'
TOTAL OF 4 EMPLOYEES

PROPOSED: 5 SPACES

PROPOSED DEVELOPMENT:
50,000 SF WAREHOUSE WITH ASSOCIATED LOADING AND PARKING
STEEL FRAME CONSTRUCTION
200' x 250' x 32'
ROOF PANEL: 24 GA. GALVALUME
WALL PANEL: 26 GA. GALVALUME

GENERAL NOTES:

1. ALL SURVEY INFORMATION IS REFERENCED TO:
1.1. MAP ENTITLED "SITE PLAN DAM LOGISTICS, LOT 3 GLEN CANAL VIEW BUSINESS PARK" PREPARED BY ABE ENGINEERS DATED FEBRUARY 2009 AND LAST REVISED MARCH 27, 2009.
2. SURVEY UPDATE PREPARED BY GERALD R. GRAY, PLS. FROM A FEBRUARY 2021 FIELD SURVEY OF ADJOINING LOT 3. OTHER PLANIMETRIC AND UTILITY FEATURES SHOWN ARE BASED UPON MAP REFERENCE 1.
3. OWNER PROVIDED POINT DATA FROM AN AUGUST 2023 EXISTING CONDITION.
4. THIS MAP IS NOT A SURVEY. INFORMATION SHOWN IS FROM MAP REFERENCES ABOVE AND FOR GENERAL INFORMATION AND DESIGN PURPOSES ONLY. A LICENSED LAND SURVEYOR SHALL STAKE OUT ANY EXISTING OR SET BACK AREAS TO CONFIRM THE SETBACKS INDICATED.
5. NORTH IS REFERENCED TO NAD 83 NEW YORK STATE PLAINS EAST ZONE. ELEVATIONS ARE BASED ON MAP REFERENCE 1.
6. SUBJECT TO ALL RIGHTS, EASEMENTS, COVENANTS OR RESTRICTION, RECORDED OR UNRECORDED.
7. SUBJECT TO ANY STATEMENT OF FACT CONTAINED IN AN UP TO DATE TITLE REPORT OR ABSTRACT OF TITLE
8. UNDERGROUND UTILITIES IF SHOWN HEREON ARE BASED ON VISIBLE PHYSICAL EVIDENCE. THEY SHOULD BE CONSIDERED SCHEMATIC ONLY AND ARE SHOWN TO DEPICT GENERAL UTILITY CONNECTIONS RATHER THAN EXACT LOCATIONS. NO CERTIFICATION IS MADE AS TO THE ACCURACY OF THE UNDERGROUND UTILITY LOCATIONS AND OTHER UTILITIES MAY EXIST THAT ARE NOT SHOWN ON THIS MAP. CALL DIG SAFE FOR FURTHER VERIFICATION.
9. DUE TO SNOW COVERED CONDITIONS AT THE TIME OF THE FIELD SURVEY, CERTAIN BOUNDARY, PLANNIMETRIC AND UTILITY FEATURES MAY NOT HAVE BEEN VISIBLE. THEREFORE ARE NOT SHOWN ON THIS MAP.

PRIOR TO ANY EARTH
DISTURBANCE THE CONTRACTOR
SHALL CALL IN A TICKET TO
DIG SAFE NY AND OBTAIN A
CLEAR TO DIG

IT IS A VIOLATION OF SECTION 7209 OF THE NYS EDUCATION LAW FOR ANY PERSON TO ALTER ANY ITEM ON THIS PLAN IN ANY WAY UNLESS HE/SHE IS ACTING UNDER THE DIRECT SUPERVISION OF A PROFESSIONAL ENGINEER.

CHRISTOPHER D. LONGO, PE
N.Y.S. LIC. # 095840

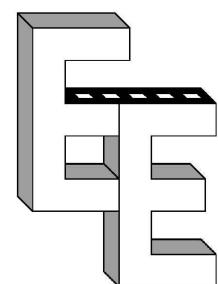

EMPIRE ENGINEERING, PLLC
1900 DUANESBURG ROAD
DUANESBURG, NY 12056
PH: (518) 280-1371
EMAIL: CLONGO@EMPIREENG.NET

EMAIL: CLONGO@EMPIREENG.NET

PROJECT

LOT 3D PARK DRIVE
GLEN CANAL VIEW PARK

TOWN OF GLEN
MONTGOMERY COUNTY

Title
**SITE LAYOUT & UTILITY
PLAN**

Date _____

11/22/2023

Scale

1 = 40

Sheet

1. *Journal of Management Studies*, 1997, 34, 1, 1-14.

C101

C101

1998, 1999, 2000, 2001, 2002, 2003, 2004, 2005, 2006, 2007, 2008, 2009, 2010, 2011, 2012, 2013, 2014, 2015, 2016, 2017, 2018, 2019, 2020, 2021, 2022, 2023, 2024, 2025, 2026, 2027, 2028, 2029, 2030, 2031, 2032, 2033, 2034, 2035, 2036, 2037, 2038, 2039, 2040, 2041, 2042, 2043, 2044, 2045, 2046, 2047, 2048, 2049, 2050, 2051, 2052, 2053, 2054, 2055, 2056, 2057, 2058, 2059, 2060, 2061, 2062, 2063, 2064, 2065, 2066, 2067, 2068, 2069, 2070, 2071, 2072, 2073, 2074, 2075, 2076, 2077, 2078, 2079, 2080, 2081, 2082, 2083, 2084, 2085, 2086, 2087, 2088, 2089, 2090, 2091, 2092, 2093, 2094, 2095, 2096, 2097, 2098, 2099, 2100, 2101, 2102, 2103, 2104, 2105, 2106, 2107, 2108, 2109, 2110, 2111, 2112, 2113, 2114, 2115, 2116, 2117, 2118, 2119, 2120, 2121, 2122, 2123, 2124, 2125, 2126, 2127, 2128, 2129, 2130, 2131, 2132, 2133, 2134, 2135, 2136, 2137, 2138, 2139, 2140, 2141, 2142, 2143, 2144, 2145, 2146, 2147, 2148, 2149, 2150, 2151, 2152, 2153, 2154, 2155, 2156, 2157, 2158, 2159, 2160, 2161, 2162, 2163, 2164, 2165, 2166, 2167, 2168, 2169, 2170, 2171, 2172, 2173, 2174, 2175, 2176, 2177, 2178, 2179, 2180, 2181, 2182, 2183, 2184, 2185, 2186, 2187, 2188, 2189, 2190, 2191, 2192, 2193, 2194, 2195, 2196, 2197, 2198, 2199, 2200, 2201, 2202, 2203, 2204, 2205, 2206, 2207, 2208, 2209, 2210, 2211, 2212, 2213, 2214, 2215, 2216, 2217, 2218, 2219, 2220, 2221, 2222, 2223, 2224, 2225, 2226, 2227, 2228, 2229, 2230, 2231, 2232, 2233, 2234, 2235, 2236, 2237, 2238, 2239, 2240, 2241, 2242, 2243, 2244, 2245, 2246, 2247, 2248, 2249, 2250, 2251, 2252, 2253, 2254, 2255, 2256, 2257, 2258, 2259, 2260, 2261, 2262, 2263, 2264, 2265, 2266, 2267, 2268, 2269, 2270, 2271, 2272, 2273, 2274, 2275, 2276, 2277, 2278, 2279, 2280, 2281, 2282, 2283, 2284, 2285, 2286, 2287, 2288, 2289, 2290, 2291, 2292, 2293, 2294, 2295, 2296, 2297, 2298, 2299, 2300, 2301, 2302, 2303, 2304, 2305, 2306, 2307, 2308, 2309, 2310, 2311, 2312, 2313, 2314, 2315, 2316, 2317, 2318, 2319, 2320, 2321, 2322, 2323, 2324, 2325, 2326, 2327, 2328, 2329, 2330, 2331, 2332, 2333, 2334, 2335, 2336, 2337, 2338, 2339, 2340, 2341, 2342, 2343, 2344, 2345, 2346, 2347, 2348, 2349, 2350, 2351, 2352, 2353, 2354, 2355, 2356, 2357, 2358, 2359, 2360, 2361, 2362, 2363, 2364, 2365, 2366, 2367, 2368, 2369, 2370, 2371, 2372, 2373, 2374, 2375, 2376, 2377, 2378, 2379, 2380, 2381, 2382, 2383, 2384, 2385, 2386, 2387, 2388, 2389, 2390, 2391, 2392, 2393, 2394, 2395, 2396, 2397, 2398, 2399, 2400, 2401, 2402, 2403, 2404, 2405, 2406, 2407, 2408, 2409, 2410, 2411, 2412, 2413, 2414, 2415, 2416, 2417, 2418, 2419, 2420, 2421, 2422, 2423, 2424, 2425, 2426, 2427, 2428, 2429, 2430, 2431, 2432, 2433, 2434, 2435, 2436, 2437, 2438, 2439, 2440, 2441, 2442, 2443, 2444, 2445, 2446, 2447, 2448, 2449, 2450, 2451, 2452, 2453, 2454, 2455, 2456, 2457, 2458, 2459, 2460, 2461, 2462, 2463, 2464, 2465, 2466, 2467, 2468, 2469, 2470, 2471, 2472, 2473, 2474, 2475, 2476, 2477, 2478, 2479, 2480, 2481, 2482, 2483, 2484, 2485, 2486, 2487, 2488, 2489, 2490, 2491, 2492, 2493, 2494, 2495, 2496, 2497, 2498, 2499, 2500, 2501, 2502, 2503, 2504, 2505, 2506, 2507, 2508, 2509, 2510, 2511, 2512, 2513, 2514, 2515, 2516, 2517, 2518, 2519, 2520, 2521, 2522, 2523, 2524, 2525, 2526, 2527, 2528, 2529, 2530, 2531, 2532, 2533, 2534, 2535, 2536, 2537, 2538, 2539, 2540, 2541, 2542, 2543, 2544, 2545, 2546, 2547, 2548, 2549, 2550, 2551, 2552, 2553, 2554, 2555, 2556, 2557, 2558, 2559, 2560, 2561, 2562, 2563, 2564, 2565, 2566, 2567, 2568, 2569, 2570, 2571, 2572, 2573, 2574, 2575, 2576, 2577, 2578, 2579, 2580, 2581, 2582, 2583, 2584, 2585, 2586, 2587, 2588, 2589, 2590, 2591, 2592, 2593, 2594, 2595, 2596, 2597, 2598, 2599, 2600, 2601, 2602, 2603, 2604, 2605, 2606, 2607, 2608, 2609, 2610, 2611, 2612, 2613, 2614, 2615, 2616, 2617, 2618, 2619, 2620, 2621, 2622, 2623, 2624, 2625, 2626, 2627, 2628, 2629, 2630, 2631, 2632, 2633, 2634, 2635, 2636, 2637, 2638, 2639, 2640, 2641, 2642, 2643, 2644, 2645, 2646, 2647, 2648, 2649, 2650, 2651, 2652, 2653, 2654, 2655, 2656, 2657, 2658, 2659, 2660, 2661, 2662, 2663, 2664, 2665, 2666, 2667, 2668, 2669, 2670, 2671, 2672, 2673, 2674, 2675, 2676, 2677, 2678, 2679, 26

Sheet 2 of 7

Sheet 3 of 7

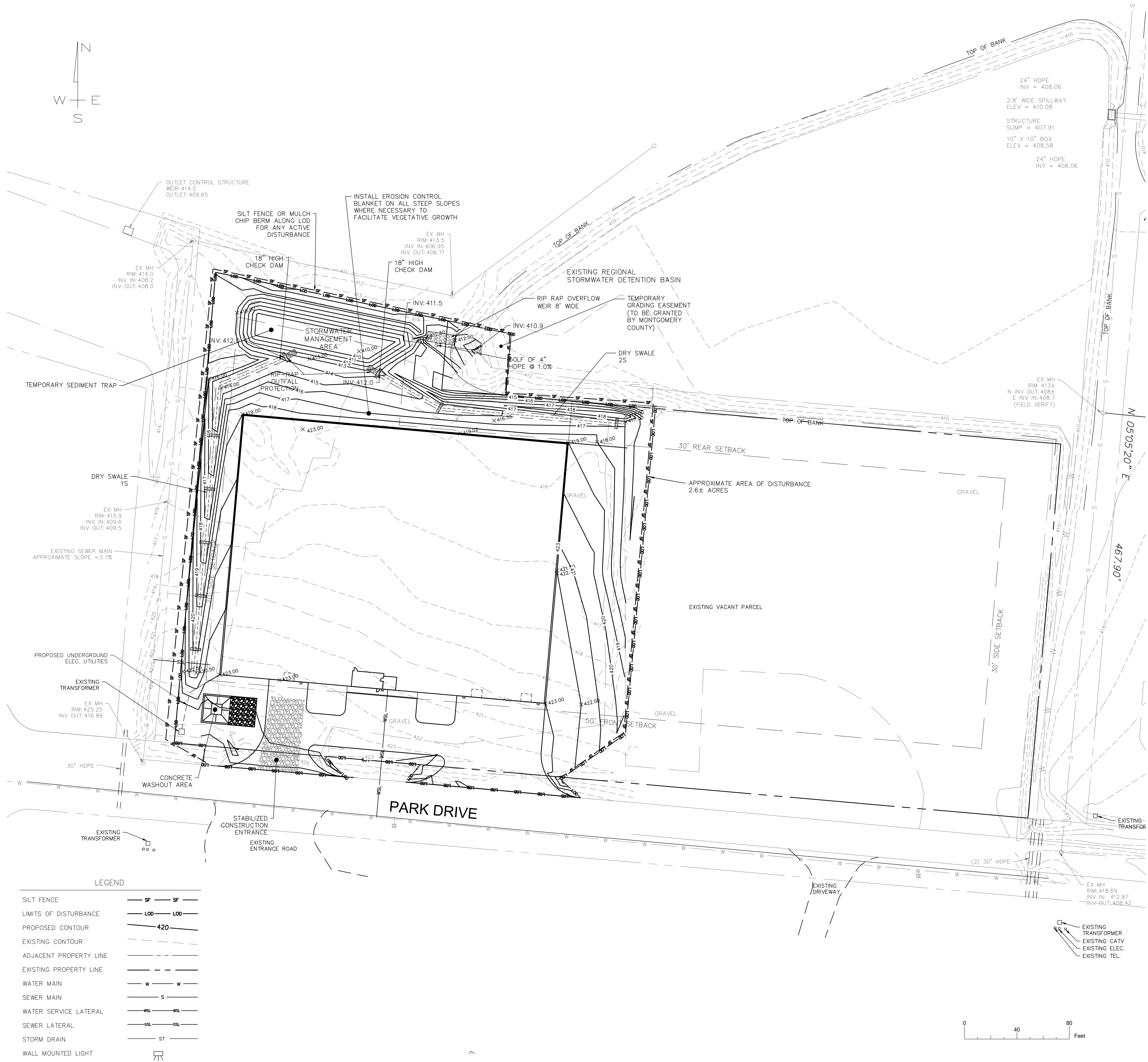

EROSION & SEDIMENT CONTROL GENERAL NOTES:

1. THIS PROJECT QUALIFIES FOR COVERAGE UNDER THE NYSDEC GENERAL PERMIT GP 0-20-001. A NOTICE OF INTENT (NOI) MUST BE FILED WITH THE NEW YORK STATE DEPARTMENT OF ENVIRONMENTAL CONSERVATION AND AUTHORIZATION RECEIVED PRIOR TO CONSTRUCTION ACTIVITIES.
2. A STORMWATER POLLUTION PREVENTION PLAN HAS BEEN PREPARED IN ACCORDANCE WITH THE NEW YORK STATE DEPARTMENT OF ENVIRONMENTAL CONSERVATION SPDES GENERAL PERMIT FOR STORMWATER DISCHARGES GP 0-20-001 AND SHALL BE CONSIDERED SUPPLEMENTAL TO THESE PLANS.
3. ANY CONTRACTOR INVOLVED IN ANY EARTHWORK ACTIVITY SHALL REVIEW ALL PLANS AND PERMIT CONDITIONS AND CERTIFY ACKNOWLEDGEMENT IN WRITING. IT IS THE CONTRACTOR'S RESPONSIBILITY TO IMPLEMENT ALL EROSION CONTROLS DESCRIBED IN GP 0-20-001, AND IT IS NOT THE INTENT OF THESE DRAWINGS TO REPLACE OR DISSEMINATE THE PERMIT REQUIREMENTS. THE CONTRACTOR SHALL REMAIN IN COMPLIANCE WITH THE PERMIT AT ALL TIMES.
4. NO MORE THAN FIVE (5) ACRES OF SITE SHALL BE DISTURBED AT ONE TIME. THE CONTRACTOR SHALL COORDINATE EARTHWORK ACTIVITIES AND IMPLEMENTATION OF SOIL STABILIZATION MEASURES TO ENSURE COMPLIANCE WITH THIS REQUIREMENT.
5. DISTURBED AREAS SHALL NOT BE LEFT UNSTABILIZED FOR MORE THAN 14 DAYS AFTER COMPLETION OR SUSPENSION OF GRADING OPERATIONS.
6. EROSION AND SEDIMENT CONTROL MEASURES SHALL BE IMPLEMENTED IN ACCORDANCE WITH THE LATEST EDITION OF NEW YORK STANDARDS AND SPECIFICATIONS FOR EROSION AND SEDIMENT CONTROL" (aka: THE BLUE BOOK) EROSION CONTROL DEVICES SHALL BE INSTALLED PRIOR TO ANY CONSTRUCTION ACTIVITIES.
7. EROSION CONTROL DEVICES SHALL NOT BE REMOVED UNTIL THE TOWN ENGINEER HAS APPROVED FINAL STABILIZATION.
8. SILT FENCE AND OTHER EROSION CONTROL DEVICES SHALL BE INSTALLED AND MAINTAINED IN ACCORDANCE WITH THESE DETAIL SHEETS AND SECTION 7A OF THE BLUE BOOK.
9. PRIOR TO ANY CONSTRUCTION ACTIVITY, THE STABILIZED CONSTRUCTION ENTRANCES SHALL BE INSTALLED.

TEMPORARY EROSION AND SEDIMENT CONTROL NOTES:

1. IT IS THE INTENT OF THESE PLANS AND NOTES TO BE USED AS A GUIDE BY THE CONTRACTOR TO ENSURE THAT NO ERODED MATERIAL MIGRATES FROM THE SITE OR ENTERS ANY WATER COURSE. IT IS THE CONTRACTOR'S RESPONSIBILITY TO ENSURE THAT THIS GOAL IS MET, BY IMPLEMENTING THESE PLANS AND ANY ADDITIONAL MEANS THAT MAY BE NECESSARY. FURTHER MEASURES MAY BE REQUIRED BY THE CITY, VILLAGE, OR TOWN ENGINEER. WHILE MANY OF THE EROSION CONTROL DETAILS CONTAINED WITHIN THESE PLANS ARE TAKEN DIRECTLY FROM THE BLUE BOOK, THE CONTRACTOR SHOULD CONSIDER ANY OF THE DETAILS CONTAINED IN SECTION 7A OF THE BLUE BOOK AS ACCEPTABLE PRACTICE IN THE APPROPRIATE APPLICATION.
2. THE OWNER/OPERATOR SHALL INSPECT AND MAINTAIN EROSION CONTROL MEASURES DAILY AND AFTER EACH RAINFALL EVENT THROUGH THE ENTIRE DEVELOPMENT PROCESS. TO ASSURE PROPER FUNCTION, SILTATION BARRIERS SHALL BE MAINTAINED IN GOOD CONDITION AND REINFORCED, EXTENDED, REPAIRED, RE-SEEDED AND PROTECTED FROM FURTHER EROSION. ALL SEDIMENT ACCUMULATED SHALL BE REMOVED AND CONTAINED IN APPROPRIATE SPOIL AREAS. WATER SHALL BE APPLIED TO NEWLY SEEDED AREAS AS NEEDED UNTIL GRASS COVER IS WELL ESTABLISHED. DURING THESE PERIODIC INSPECTIONS, THE FOLLOWING ITEMS SHOULD BE PAID PARTICULAR ATTENTION: A. SILT FENCING SHALL BE INSPECTED FOR UNDERMINING AND DETERIORATION. B. SEEDED/MULCHED AREAS SHALL BE INSPECTED TO SEE THAT A GOOD STAND IS MAINTAINED. AREAS SHALL BE REPAIRED AS NECESSARY.
3. PRIOR TO ANY CONSTRUCTION ACTIVITY, THE STABILIZED CONSTRUCTION ENTRANCES SHALL BE INSTALLED.
4. SILT FENCE AND OTHER EROSION CONTROL DEVICES SHALL BE INSTALLED AND MAINTAINED IN ACCORDANCE WITH THESE DETAIL SHEETS AND SECTION 7A OF THE BLUE BOOK. SILT FENCING SHALL BE INSTALLED AT THE PERIMETER OF ALL SLOPES TO BE GRADED, PRIOR TO GRADING OPERATIONS.
5. CLEARING OPERATIONS SHALL BE LIMITED TO ACTIVE WORK AREAS.
6. CARE SHALL BE TAKEN TO PRESERVE AS MUCH EXISTING VEGETATION AS POSSIBLE AND HEALTHY TREES OF DESIRABLE SPECIES SHALL BE PROTECTED.
7. CONSTRUCTION TRAFFIC SHALL NOT CROSS STREAMS OR DITCHES EXCEPT AT SUITABLE CROSSING FACILITIES. EQUIPMENT SHALL NOT OPERATE, UNNECESSARILY, WITHIN WATERWAYS OR DRAINAGE DITCHES.
8. EXISTING PAVEMENT AREAS SHALL BE CLEANED AT THE DIRECTION OF THE CITY, VILLAGE, OR TOWN ENGINEER.
9. WATER TRUCKS SHALL BE USED TO MINIMIZE DUST POLLUTION ON SITE, AND ON ADJACENT ROADWAY AREAS AS DIRECTED BY THE CITY, VILLAGE, OR TOWN ENGINEER.
10. ANY WATER PUMPED AS A RESULT OF DEWATERING ACTIVITIES SHALL BE PUMPED INTO A DEWATERING PIT.
11. ALL AREAS DISTURBED IN THE CONSTRUCTION PROCESS SHALL BE STABILIZED WITH SEED AND MULCH NO MORE THAN 14 DAYS AFTER THE COMPLETION OF WORK IN SUCH AREA. IT MAY BE NECESSARY TO SEED AND MULCH SOME AREAS SEVERAL TIMES TO MEET THIS REQUIREMENT.
12. ALL EROSION CONTROL DEVICES SHALL BE PLACED IN THE ENTIRE PHASE AS SHOWN ON THE EROSION CONTROL PLAN PRIOR TO ANY WORK ON SUCH PHASE.
13. STOCK PILES SHALL BE PROTECTED BY SILT FENCE AND SEEDED PER GP 0-15-002. THESE DEVICES SHALL BE MAINTAINED IN GOOD CONDITION UNTIL SAID STOCK PILES ARE REMOVED AND AREAS ARE PERMANENTLY STABILIZED.
14. WHEN RUNOFF IS COLLECTED AND FLOW IS CONCENTRATED IN A SWALE OR DRAINAGE DITCH, THEN CHECK DAMS SHALL BE INSTALLED TO REDUCE VELOCITY. UNTIL THE SWALE AND THE AREA DRAINING TO THE SWALE ARE STABILIZED, SEDIMENT SHALL BE REMOVED FROM THE DAM AS NEEDED TO ALLOW THE CHANNEL TO DRAIN THROUGH THE DAM AND PREVENT LARGE FLOWS FROM CARRYING SEDIMENT OVER THE DAM.
15. IN NO CASE SHALL ERODIBLE MATERIALS BE STOCKPILED WITHIN 25 FEET OF ANY DITCH, STREAM OR OTHER SURFACE WATER BODY.
16. THE CONTRACTOR SHALL MAINTAIN A CLEAN CONSTRUCTION AND EQUIPMENT ENTRANCE WHENEVER PRACTICABLE.
17. EROSION CONTROL DEVICES SHALL NOT BE REMOVED UNTIL THE CITY, VILLAGE OR TOWN ENGINEER HAS APPROVED FINAL STABILIZATION.

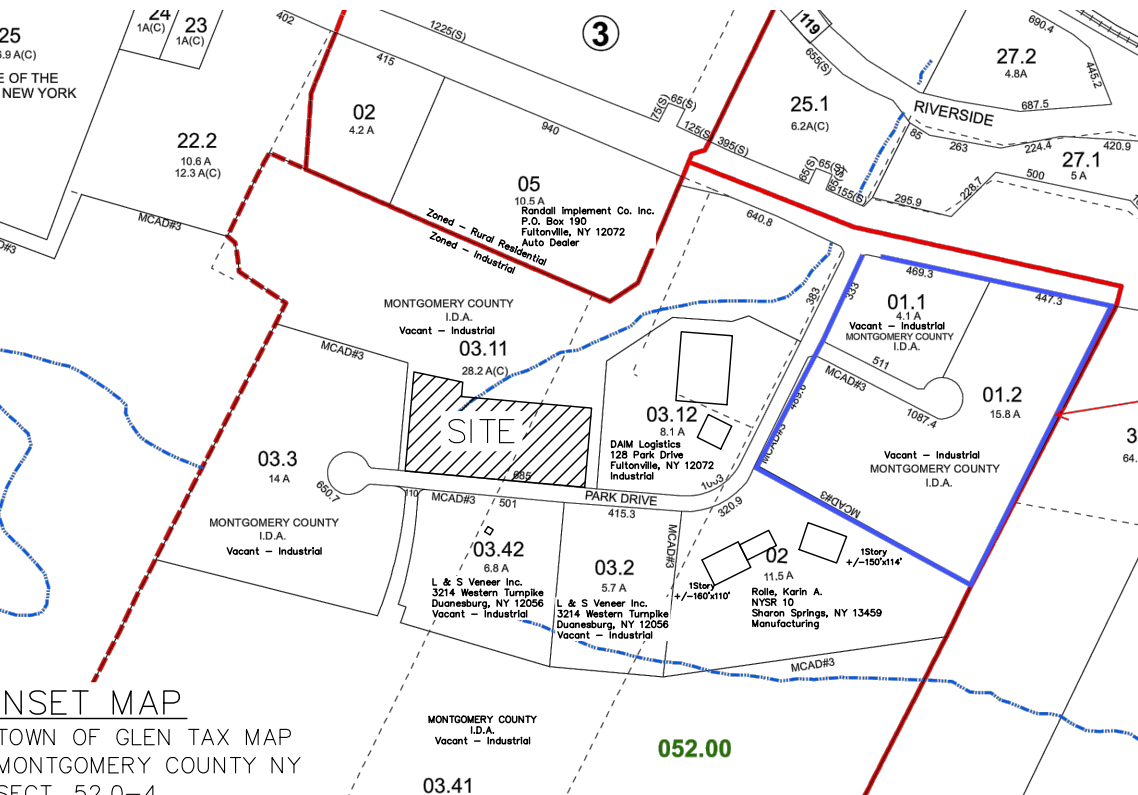

No.	Revision	Description	Date
1	REVISED PER TDE COMMENTS DTD.	10/17/23	10/30/23
2	REVISED PER TDE COMMENTS DTD.	11/17/23	11/22/23

PRIOR TO ANY EARTH DISTURBANCE THE CONTRACTOR SHALL CALL IN A TICKET TO DIG SAFE NY AND OBTAIN A CLEAR TO DIG

IT IS A VIOLATION OF SECTION 7209 OF THE NYS EDUCATION LAW FOR ANY PERSON TO ALTER ANY ITEM ON THIS PLAN IN ANY WAY UNLESS HE/SHE IS ACTING UNDER THE DIRECT SUPERVISION OF A PROFESSIONAL ENGINEER.

CHRISTOPHER D. LONGO, PE
N.Y.S. LIC. # 095840

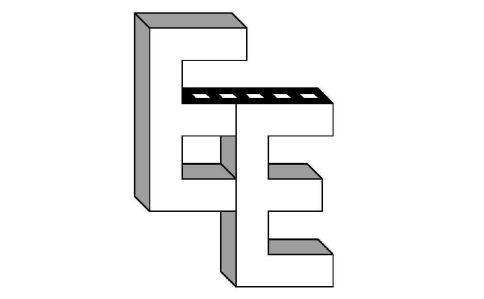

EMPIRE ENGINEERING, PLLC
1900 DUANESBURG ROAD
DUANESBURG, NY 12056
PH: (518) 280-1371
EMAIL: CLONGO@EMPIREENG.NET

PROJECT
LOT 3D PARK DRIVE
GLEN CANAL VIEW PARK
TOWN OF GLEN
MONTGOMERY COUNTY

Title
EROSION & SEDIMENT CONTROL PLAN
Date
11/22/2023
Scale
1"=40'
Job#
22051
Sheet
C103
Sheet 4 of 7

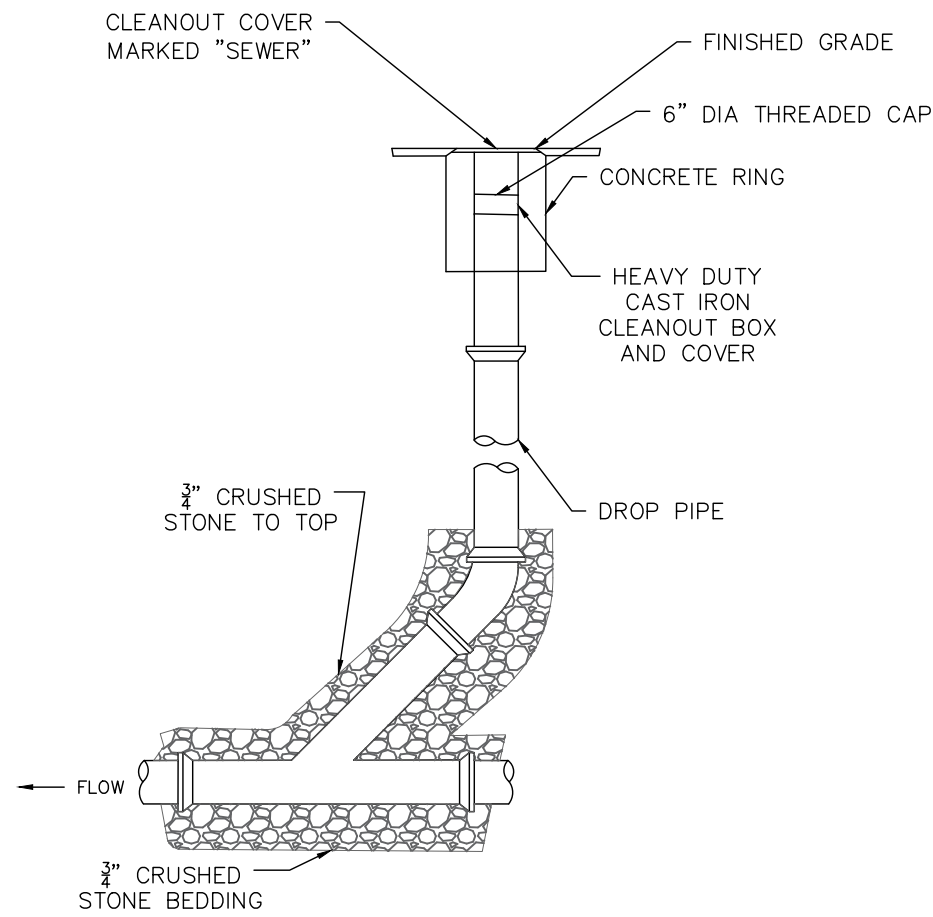

- NOTES:**
1. CLEANOUTS TO BE INSTALLED WHERE INDICATED ON THE PLANS.
 2. CLEANOUT PIPE TO BE THE SAME SIZE AND MATERIAL AS SEWER/DRAIN LINE UP TO 8"

1 SEWER CLEANOUT DETAIL
501 NOT TO SCALE

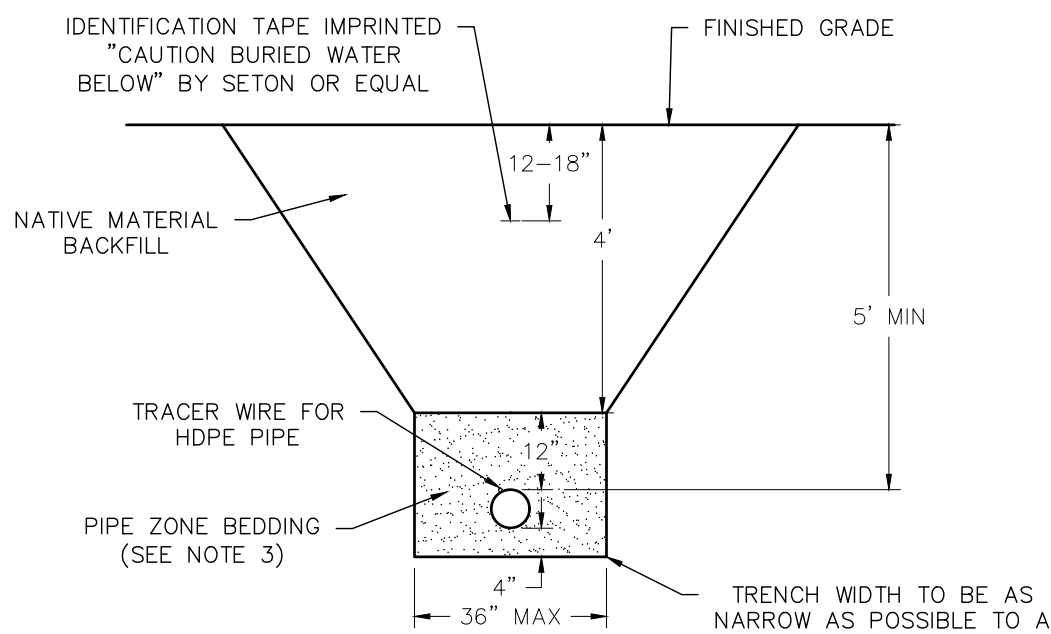

- NOTES:**
1. WATER SERVICE LATERAL SHALL BE INSTALLED IN ACCORDANCE WITH APPLICABLE MUNICIPAL SPECIFICATIONS.
 2. INDIVIDUAL SIZE SHALL BE DETERMINED BASED ON REQUIRED FLOW TO STRUCTURE.
 3. SAND SHALL BE FROM AN APPROVED SOURCE COMPACTED IN 6" LIFTS TO MINIMUM 12" ABOVE TOP OF PIPE.

3 WATER SERVICE DETAIL
501 NOT TO SCALE

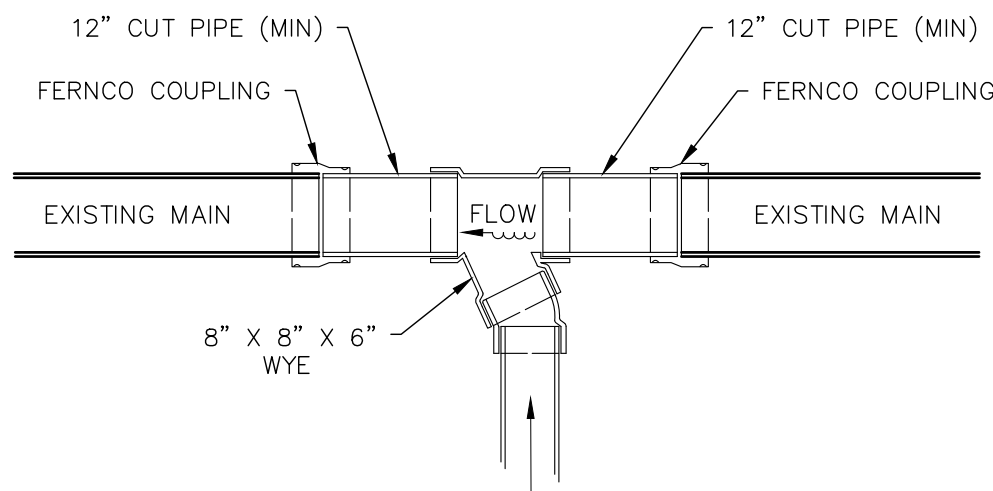

2 CUT-IN-WYE SEWER CONNECTION
501 NOT TO SCALE

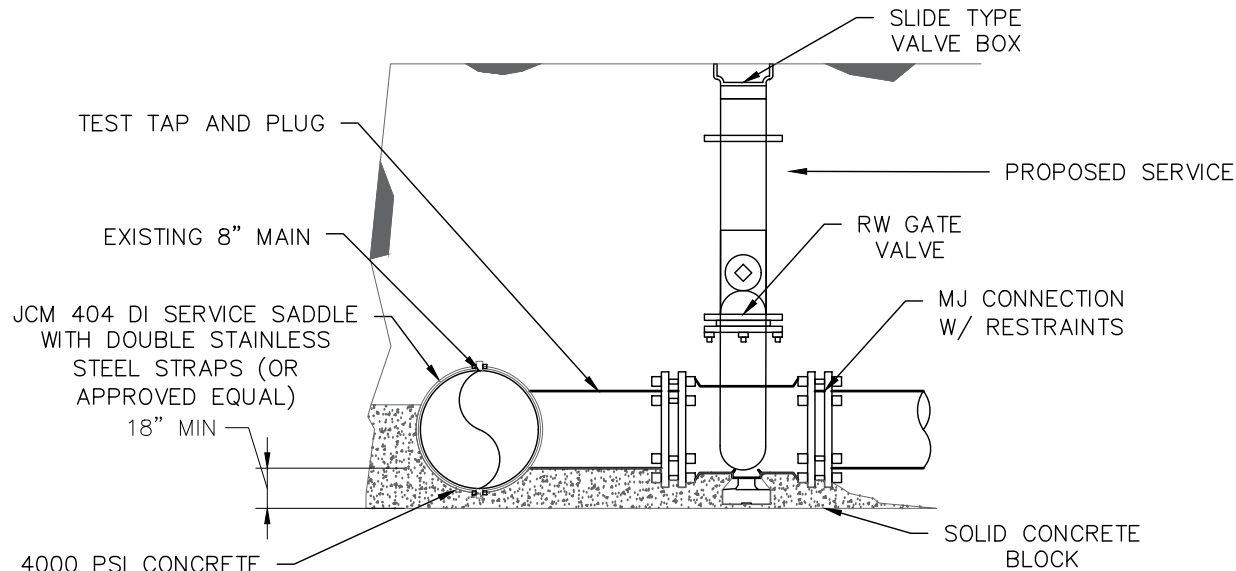

- NOTES:**
1. TEMPORARILY SUPPORT TAPPING SADDLE AND VALVE AND APPLY STANDARD HYDROSTATIC TEST.
 2. IF NO LEAKS, POUR INDICATED PERMANENT CONCRETE BLOCK AND SUPPORT PAD.
 3. MAKE TAP, LINE EXTENSION AND BACKFILL.
 4. COVER UP GLANDS AND BOLTS WITH HEAVY POLYETHYLENE SHEETING TO KEEP CONCRETE FROM BONDING. TYPICAL WHENEVER BOLTS OR GLANDS MAY BE "WRAPPED-UP" IN CONCRETE.
 5. COAT TAPPING SLEEVE AND BOLTS WITH AN APPROVED BITUMASTIC COATING BEFORE POURING CONCRETE. TYPICAL FOR ALL STEEL INCLUDING, RODS, COUPLINGS, STRAPS, AND OTHER BURIED STEEL.

4 TAPPING SLEEVE AND VALVE DETAIL
501 NOT TO SCALE

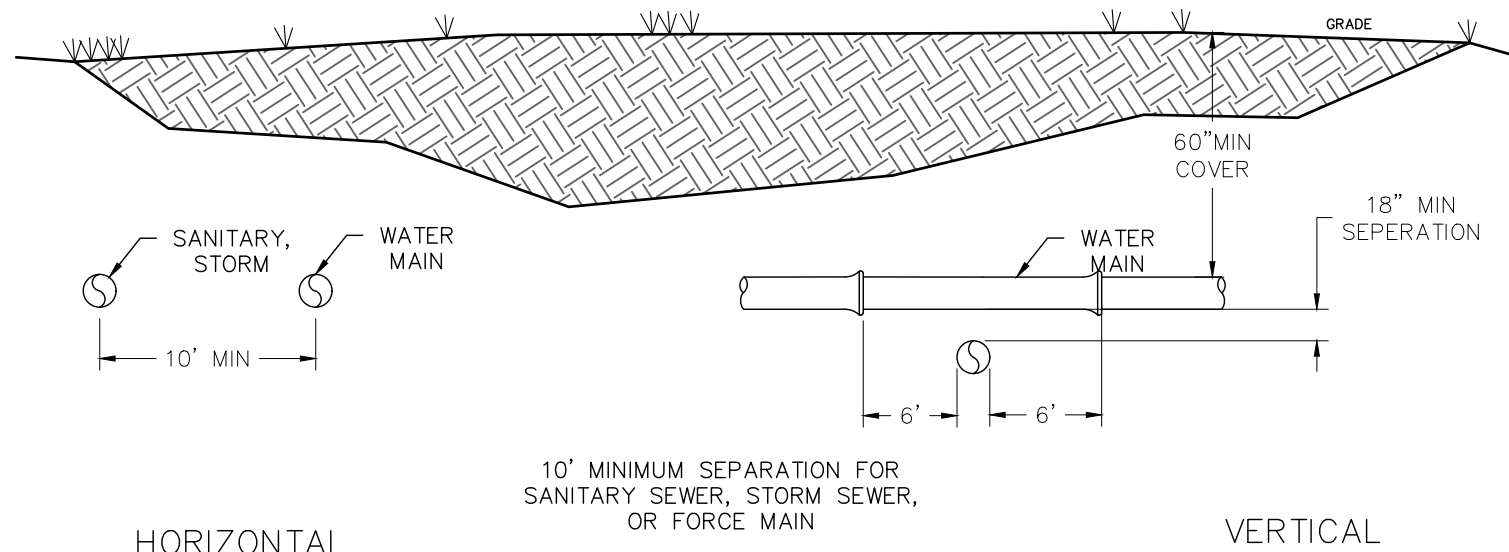

- NOTES:**
1. WATER MAINS SHALL BE SEPARATED FROM STORM SEWER, SANITARY SEWER, NON-POTABLE IRRIGATION MAINS, AND FORCE MAINS BY A MINIMUM CLEAR VERTICAL DISTANCE OF 18 INCHES MEASURED BETWEEN THE BOTTOM OF THE UPPER PIPE AND THE TOP OF THE LOWER PIPE. ALSO WATER MAINS MUST BE SEPARATED FROM STORM SEWERS, SANITARY SEWERS, AND FORCE MAINS BY 10 FEET AND FROM IRRIGATION MAINS BY 5 FEET MEASURED HORIZONTALLY BETWEEN OUTSIDE OF PIPES.
 2. ALL CROSSINGS WITH VERTICAL CLEARANCE LESS THAN 18 INCHES SHALL BE MADE USING THICKNESS CLASS 200 AWMA C-900 DR14, PVC (CLASS 165 AWMA C-905, DR 25, PVC FOR PIPES GREATER THAN 12" DIAMETER) OR DUCTILE IRON, PRESSURE CLASS 250 PIPE FOR A HORIZONTAL DISTANCE OF 10 FEET ON EACH SIDE OF THE CROSSING. WATER MAIN CONCRETE ENCASEMENT SHALL ONLY BE MADE AFTER WRITTEN APPROVAL OF THE WATER DIRECTOR OR HIS/HER DESIGNEE. (SEPARATION REQUIREMENTS ALSO APPLY TO WATER AND SEWER LATERALS).
 3. 18 INCHES CLEAR DISTANCE SHALL NOT BE REDUCED IN CASES WHERE WATER CROSSES UNDER SEWER LINE.
 4. WATER MAINS, SANITARY SEWERS, STORM SEWER, AND NON-POTABLE IRRIGATION MAINS SHALL BE IN SEPARATE TRENCHES.

5 PIPE SEPERATION DETAIL
501 NOT TO SCALE

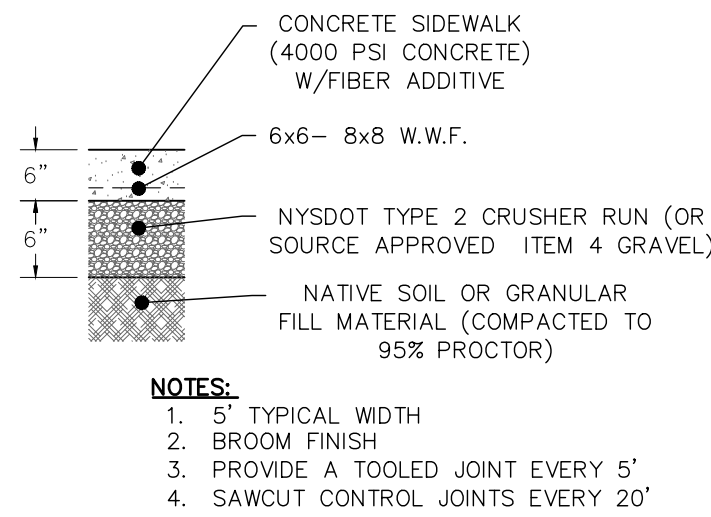

- NOTES:**
1. 3" TYPICAL WIDTH
 2. BROOM FINISH
 3. PROVIDE A TOOLED JOINT EVERY 5'
 4. SAWCUT CONTROL JOINTS EVERY 20'

6 CONCRETE DETAIL
501 NOT TO SCALE

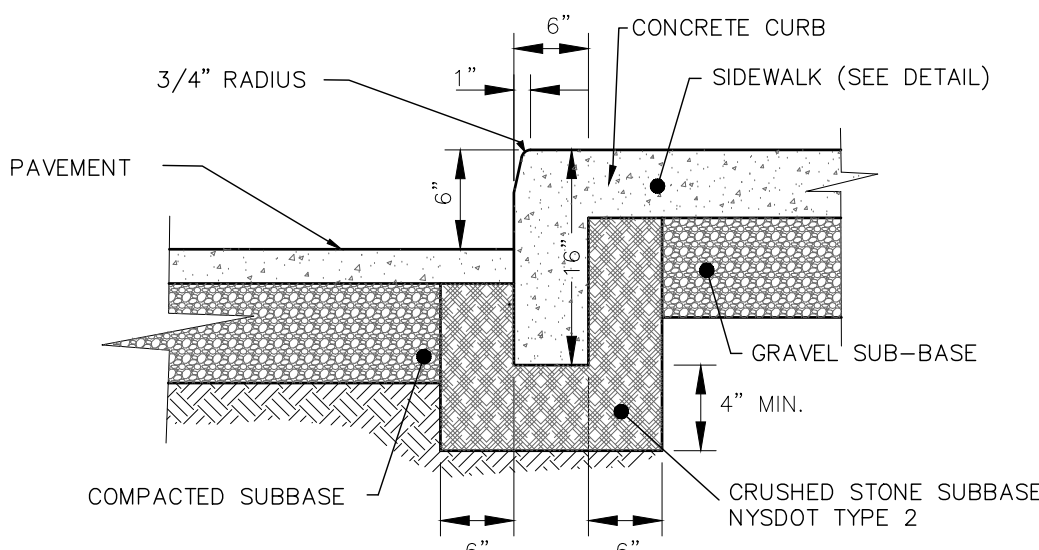

8 INTEGRAL CONCRETE CURB DETAIL
501 NOT TO SCALE

MUTCD	R7-8	R7-1	R7-8P	R1-1
SIZE	18"x9"	24"x30"	18"x9"	30"x30"
HT.	7'	7'	7'	7'

- NOTES:**
1. ALL SIGNS SHALL BE INSTALLED USING A TYPE 'A' SIGN POST.
 2. ALL SIGNS SHALL CONFORM TO THE FHWA MUTCD STANDARDS AND THE NYS SUPPLEMENT.
 3. H.C. SIGN POST SHALL BE SET IN BOLLARD PRIOR TO FILLING WITH CONCRETE.

10 SIGN TABLE
501 NOT TO SCALE

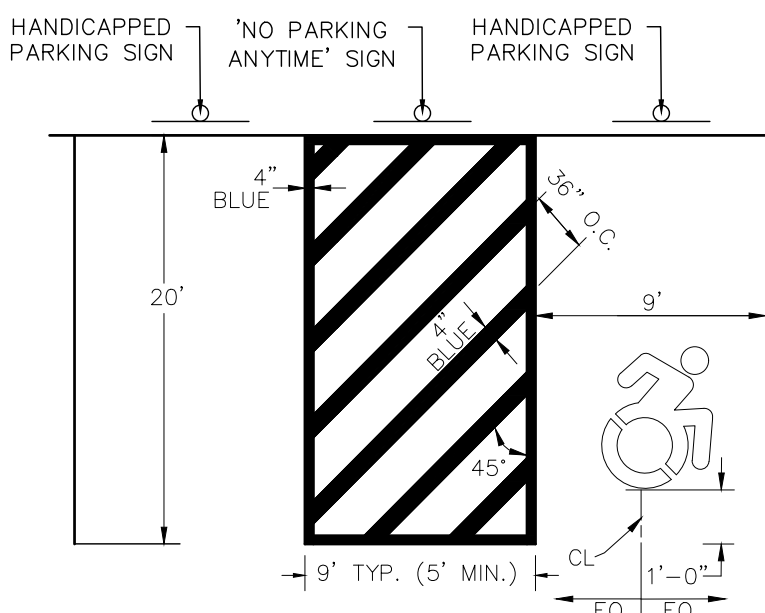

- NOTES:**
1. ALL DIMENSIONS SHALL BE IN ACCORDANCE WITH ADA STANDARDS AND CURRENT ZONING AND SITE REGULATIONS.
 2. PAINTED HANDICAP SYMBOL TO BE IN ACCORDANCE WITH ADA STANDARDS.
 3. SLOPE OF PAVEMENT SURFACE IN HANDICAP PARKING SHALL NOT EXCEED 2% IN ANY DIRECTION.
 4. SEE PLAN FOR ACTUAL LOCATION OF SIGNAGE.

12 TYPICAL HANDICAPPED SPACE DETAIL
501 NOT TO SCALE

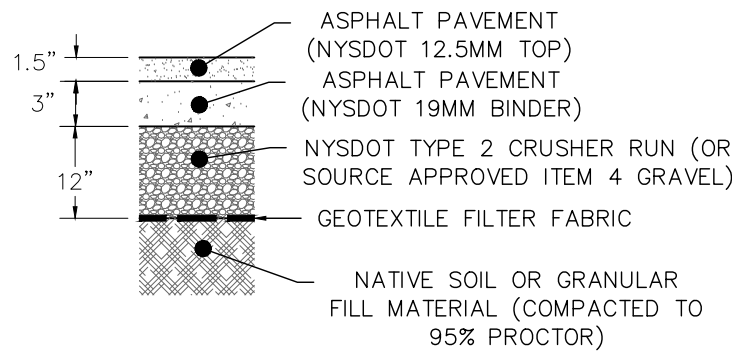

- NOTES:**
1. ITEM 4 GRAVEL MAY BE USED IN-LEU OF TYPE 2 CRUSHER RUN ONLY A.O.B.E.
 2. ALL IMPORTED MATERIAL SHALL BE COMPACTED TO 95% PROCTOR.

7 ASPHALT PAVEMENT DETAIL
501 NOT TO SCALE

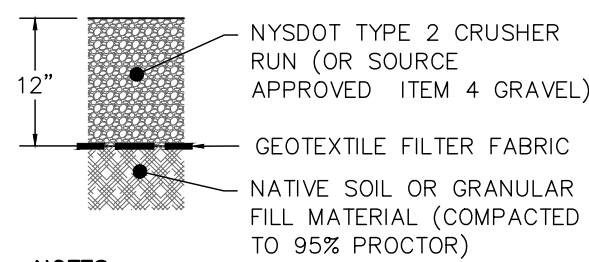

- NOTES:**
1. ITEM 4 GRAVEL MAY BE USED IN-LEU OF TYPE 2 CRUSHER RUN ONLY A.O.B.E.
 2. ALL IMPORTED MATERIAL SHALL BE COMPACTED TO 95% PROCTOR.

9 GRAVEL AREA DETAIL
501

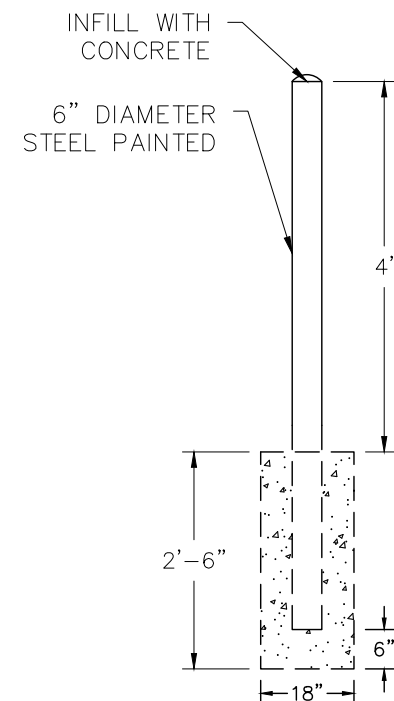

- NOTES:**
1. BOLLARDS SHALL BE PAINTED FOR HIGH VISIBILITY, AND FOR PREVENTION OF RUST.

11 BOLLARD DETAIL
501 NOT TO SCALE

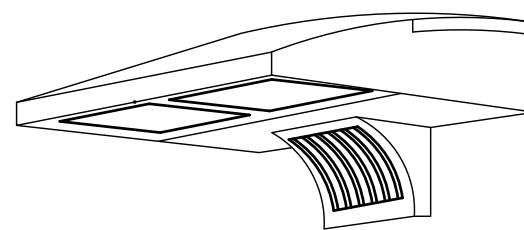

BUILDING MOUNTED LIGHTING
LIGHT FIXTURE:
LITHONIA LIGHTING.
14' MNT. HT.

LIGHTING SCHEDULE					
TYPE	# OF FIXTURES	MANUF.	CATALOG #	LUMENS	NOTES
WALL MOUNTED LIGHT	4	LITHONIA LIGHTING	RSX2 LED P2 40K R3	17,202	MOUNTED ON ENDS AND SIDE WALL

- NOTES:**
1. ALL LIGHTING SHALL BE SHIELDED AND/OR PLACED IN SUCH A MANNER AS TO PREVENT OFF-SITE ILLUMINATION.

13 LIGHTING SCHEDULE
501 BY POINT SOURCE GROUP, OR APPROVED EQUAL

No.	Revision Description	Date
1	REVISED PER TDE COMMENTS DTD: 11/7/23	11/22/23

PRIOR TO ANY EARTH DISTURBANCE THE CONTRACTOR SHALL CALL IN A TICKET TO DIG SAFE NY AND OBTAIN A CLEAR TO DIG

IT IS A VIOLATION OF SECTION 7209 OF THE NYS EDUCATION LAW FOR ANY PERSON TO ALTER ANY ITEM ON THIS PLAN IN ANY WAY UNLESS HE/SHE IS ACTING UNDER THE DIRECT SUPERVISION OF A PROFESSIONAL ENGINEER.

CHRISTOPHER D. LONGO, PE
N.Y.S. LIC. # 095840

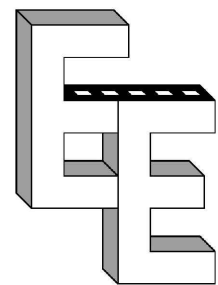

EMPIRE ENGINEERING, PLLC
1900 DUANESBURG ROAD
DUANESBURG, NY 12056
PH: (518) 280-1371
EMAIL: CLONGO@EMPIREENG.NET

PROJECT
LOT 3D PARK DRIVE
GLEN CANAL VIEW PARK
TOWN OF GLEN
MONTGOMERY COUNTY

Title
SITE & UTILITY DETAILS

Date
11/22/2023

Scale
N.T.S.

Job#
22051

Sheet
C501

Sheet 5 of 7

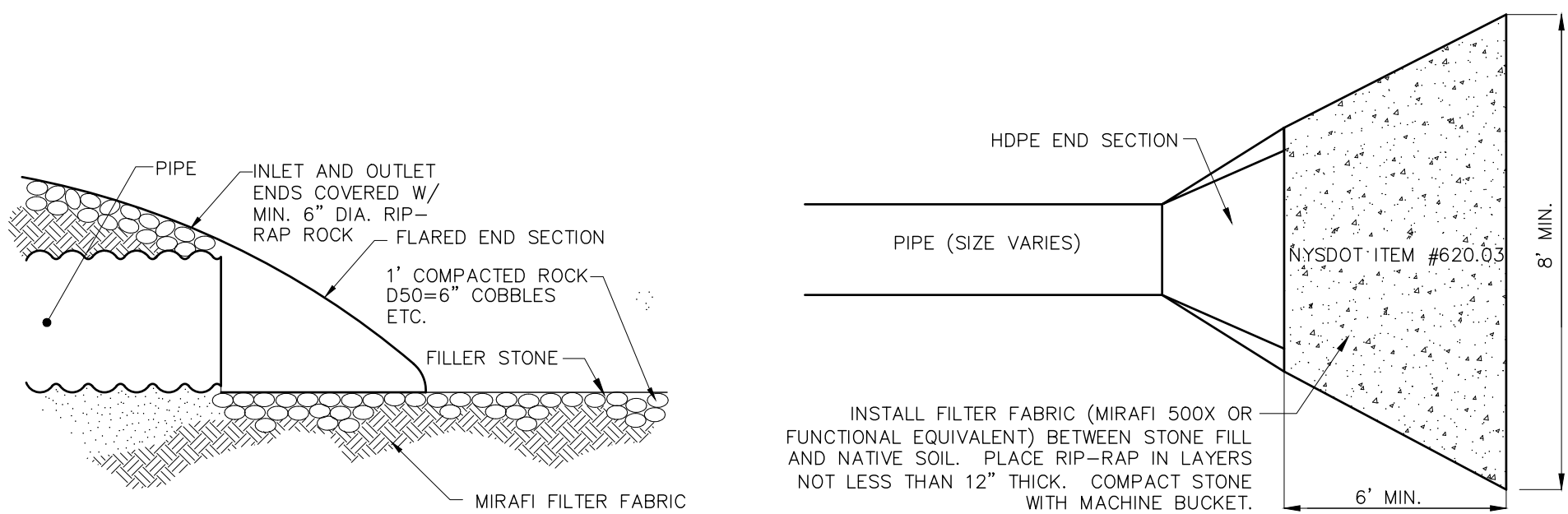

- NOTES:**
- REFERENCE PAGE 3.39 OF NYS STANDARDS & SPECIFICATIONS FOR EROSION & SEDIMENT CONTROL 'BLUE BOOK'.
 - DISCHARGE FLOW IS MINIMUM TAILWATER CONDITION FOR ALL PIPING EXCEPT AS NOTED BELOW, MAXIMUM Q = 3 CFS
 - ALL END SECTIONS: LENGTH OF APRON (L_a) = 6 FT
WIDTH OF APRON = 8 FT
 - D₅₀ = 6" RIP-RAP. SIZE EQUIVALENT TO NYS DOT LIGHT STONE FILL

1
502 PIPE FLARED END SECTION DETAIL
NOT TO SCALE

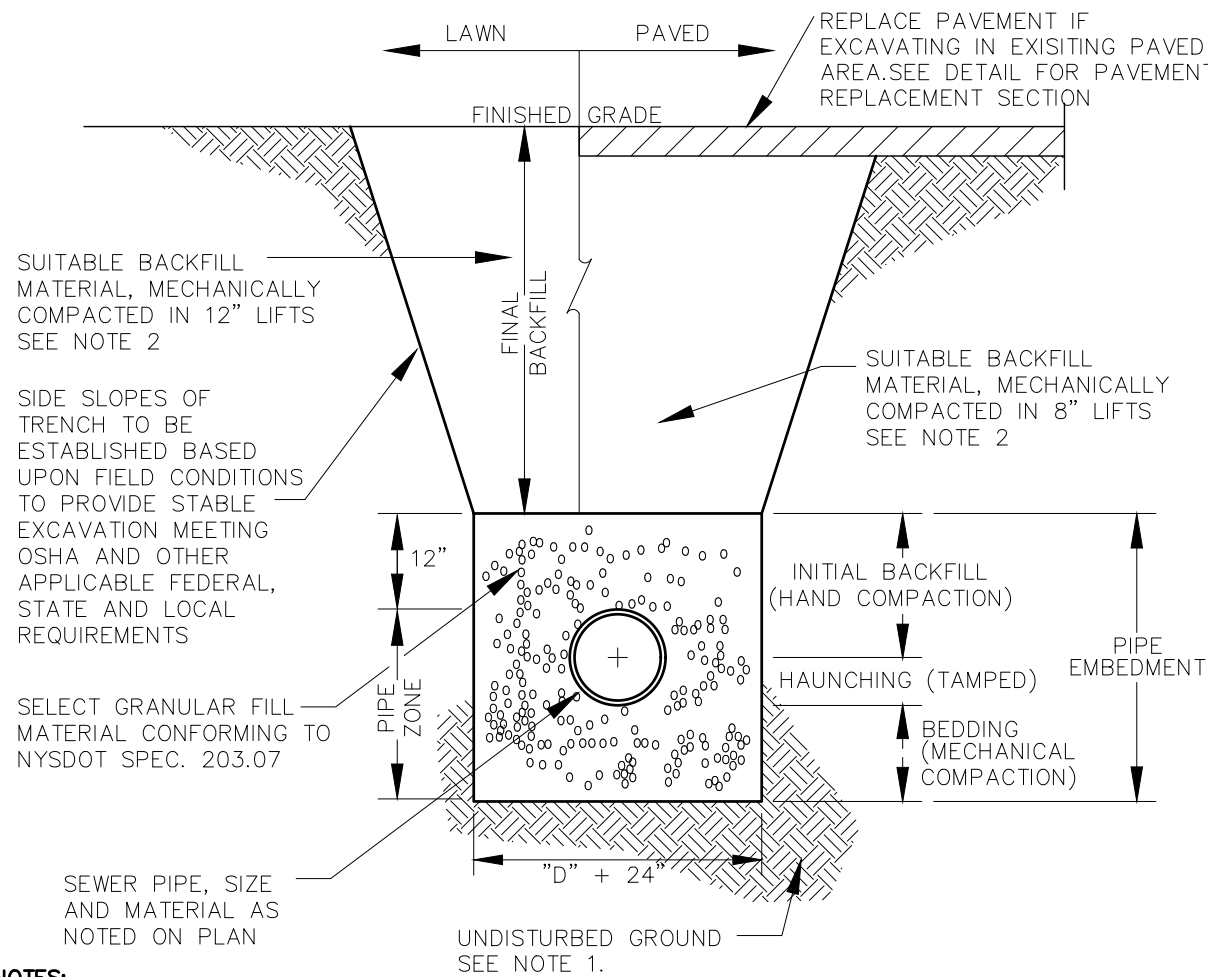

- NOTES:**
- UNSTABLE OR OTHERWISE UNSUITABLE SUBGRADE MATERIAL SHALL BE UNDERCUT A.O.B.E. AND REPLACED WITH SELECT FILL MATERIAL.
 - ALL BACKFILL MATERIAL SHALL CONFORM TO NYSDOT ITEM 203.06 COMPACTED TO 90% STD. PROCTOR MAX. DENSITY

2
502 TYPICAL TRENCH DETAIL
NOT TO SCALE

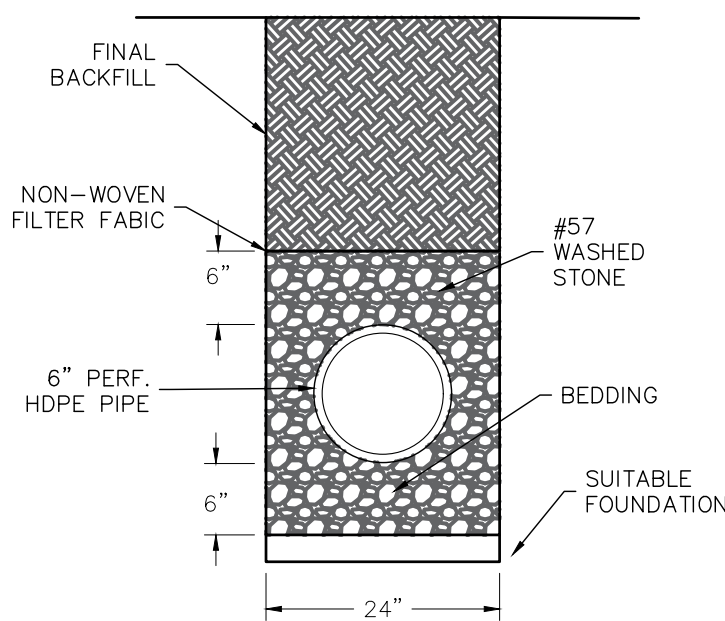

4
502 UNDERDRAIN DETAIL
NOT TO SCALE

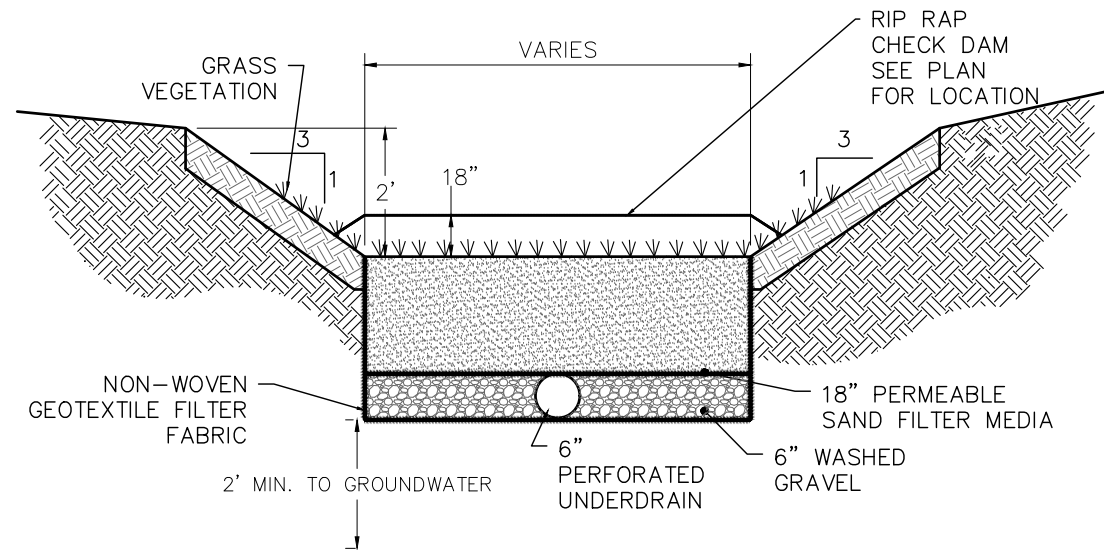

- NOTES:**
- DISTURBED AREAS SHALL BE PLANTED WITH ENVIRONMENTAL SEED MIX.
 - VEGETATION SHALL BE MAINTAINED AT 6" HEIGHT.
 - ALL TREES, BRUSH, STUMPS AND OTHER OBSTRUCTIONS SHALL BE REMOVED AND DISPOSED OF SO AS NOT TO INTERFERE WITH THE PROPER FUNCTION OF THE SWALE.
 - THE SWALE SHALL BE EXCAVATED OR SHAPED TO MEET THE CROSS SECTION SHOWN ABOVE AND SHALL BE FREE OF BANK PROJECTIONS OR OTHER IRREGULARITIES THAT MAY IMPEDE FLOW.
 - NON-WOVEN GEOTEXTILE FABRIC SHALL BE INSTALLED ON THE BOTTOM AND SIDES OF THE TRENCH AS WELL AS BETWEEN THE STONE AND SAND LAYERS.

5
502 DRY SWALE DETAIL
NOT TO SCALE

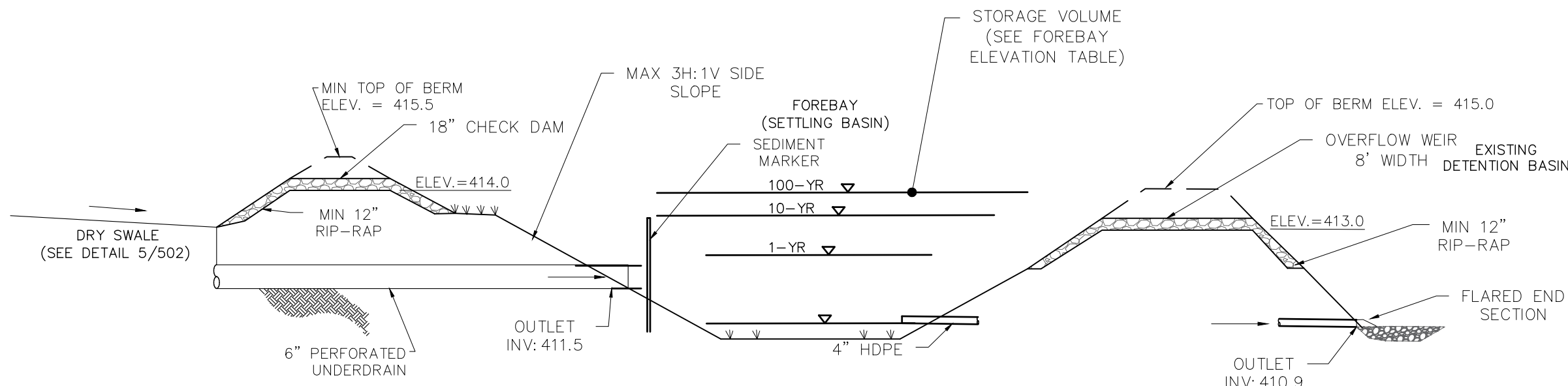

FOREBAY ELEVATION TABLE:	
1-YR:	412.15
10-YR:	413.27
100-YR:	413.93

- NOTES:**
- A MINIMUM 6" THICK CLAY LINER SHALL BE INSTALLED WITHIN THE FOREBAY. MATERIAL SHALL BE FROM A SOURCE APPROVED BY THE ENGINEER AND BE GREATER THAN 50% PASSING THE #200 SIEVE.
 - OVERFLOW WEIR SHALL BE CONSTRUCTED WITH A MIN OF 12" D50=6" RIP RAP LAID OVER GEOTEXTILE FABRIC.
 - SEDIMENT MARKER SHALL BE A MINIMUM 2" SCHEDULE 40 PVC PIPE BURIED A MIN 4 FT AND 2 FT ABOVE PERMANENT POOL ELEVATION. A SOLID MARK SHALL BE PLACED AT A POINT 2FT ABOVE THE FOREBAY BOTTOM.
 - SIDE SLOPES SHALL BE 4H:1V FOR FOREBAY, 3H:1V ABOVE THE AQUATIC BENCH AND 2H:1V BELOW THE AQUATIC BENCH.
 - EMERGENT PLANTINGS WITHIN THE AQUATIC BENCH SHALL BE HYDROLOGIC ZONE 2, CAPABLE OF WITHSTANDING CONSTANT INUNDATION. PLANTINGS SHALL BE RANDOMLY SPACED 5-10' O.C. AND SHALL BE SELECTED FROM THE LIST ON TABLE H.5 OF THE NYSDOT STORMWATER DESIGN MANUAL. A LARGE DEEP HOLE SHOULD BE DUG AROUND EACH PLANTING SITE AND NATIVE SOIL REPLACED WITH UNCOMPACTED TOPSOIL. GRASS SEE SHALL BE ENVIRONMENTAL SEED MIX.

6
502

DRY SWALE / FOREBAY PROFILE
NOT TO SCALE

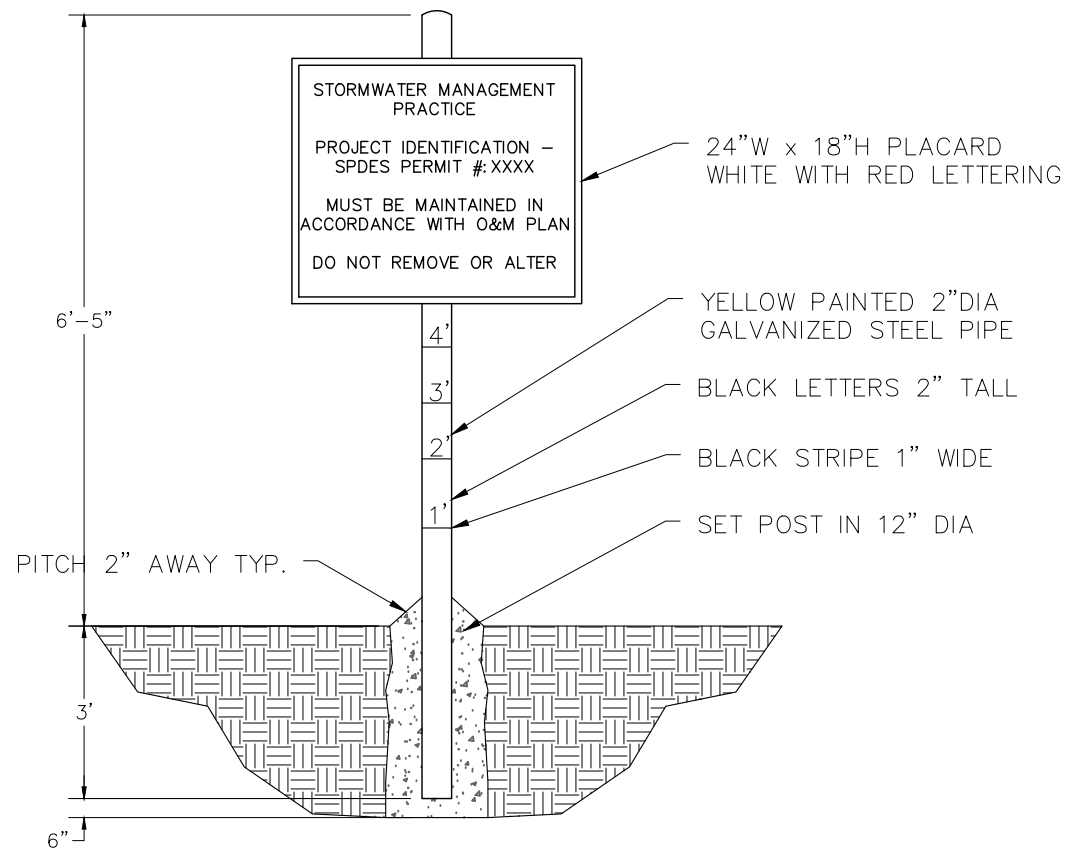

- NOTES:**
- SIGN SHALL READ "THIS MARKER IS PART OF AN ON-SITE STORM WATER MANAGEMENT FACILITY".
 - SEDIMENT SHALL BE REMOVED FROM THE SEDIMENTATION BASIN WHEN IT IS 50% FULL (AT THE 2-FOOT MARK)
 - SIGN SHALL HAVE WHITE BACKGROUND, WITH 1" TALL BLACK LETTERS.

3
502 STORMWATER SIGN DETAIL
NOT TO SCALE

No.	Revision Description	Date
1.	REVISED PER TDE COMMENTS DTD.	10/17/23
2.	REVISED PER TDE COMMENTS DTD.	11/17/23
		10/30/23
		11/22/23

PRIOR TO ANY EARTH DISTURBANCE THE CONTRACTOR SHALL CALL IN A TICKET TO DIG SAFE NY AND OBTAIN A CLEAR TO DIG

IT IS A VIOLATION OF SECTION 7209 OF THE NYS EDUCATION LAW FOR ANY PERSON TO ALTER ANY ITEM ON THIS PLAN IN ANY WAY UNLESS HE/SHE IS ACTING UNDER THE DIRECT SUPERVISION OF A PROFESSIONAL ENGINEER.

CHRISTOPHER D. LONGO, PE
N.Y.S. LIC. # 095840

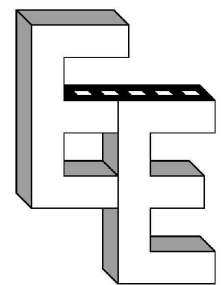

EMPIRE ENGINEERING, PLLC
1900 DUANESBURG ROAD
DUANESBURG, NY 12056
PH: (518) 280-1371
EMAIL: CLONGO@EMPIREENG.NET

PROJECT
LOT 3D PARK DRIVE
GLEN CANAL VIEW PARK
TOWN OF GLEN
MONTGOMERY COUNTY

STORMWATER DETAILS	
Date	Sheet
11/22/2023	
Scale	
N.T.S.	C502
Job#	
22051	Sheet 6 of 7

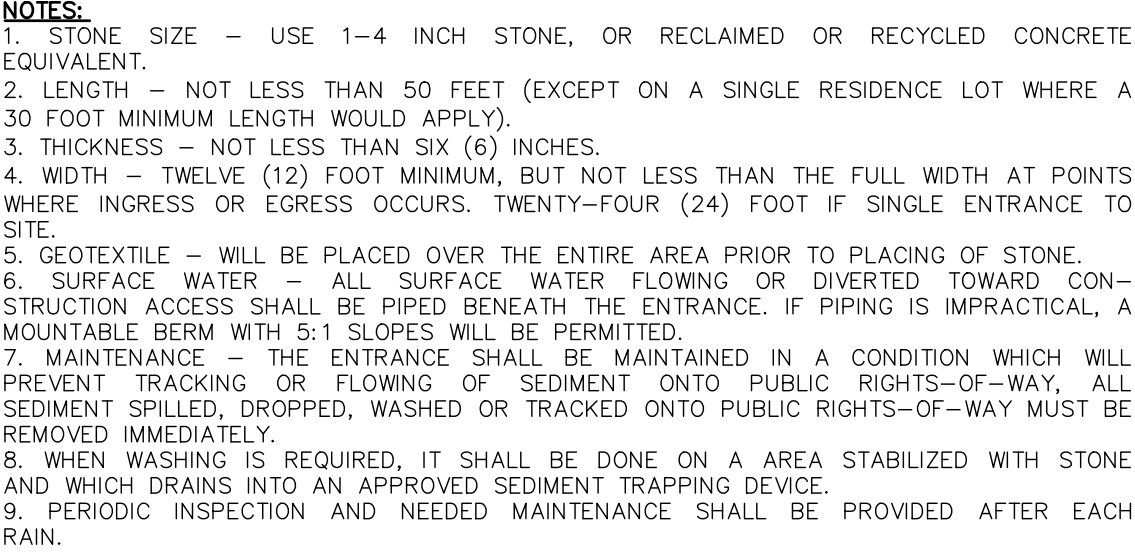

1	STABILIZED CONSTRUCTION ENTRANCE DETAIL
503	NOT TO SCALE

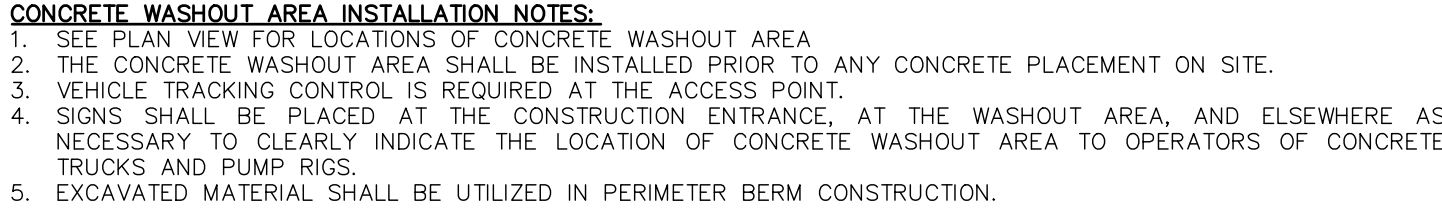

2 CONCRETE WASHOUT DETAIL
503 NOT TO SCALE

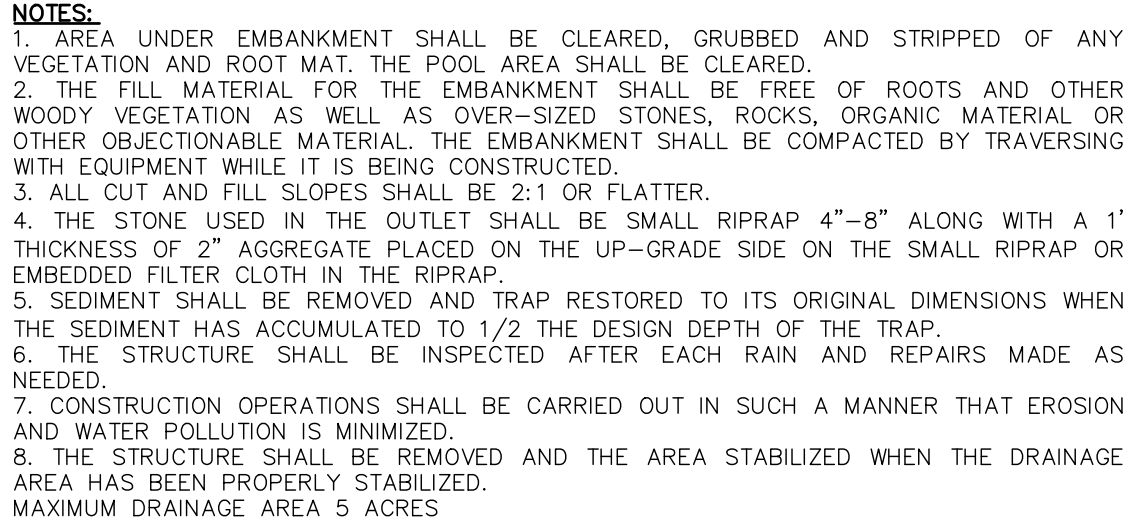

3 TEMPORARY SEDIMENT TRAP DETAIL

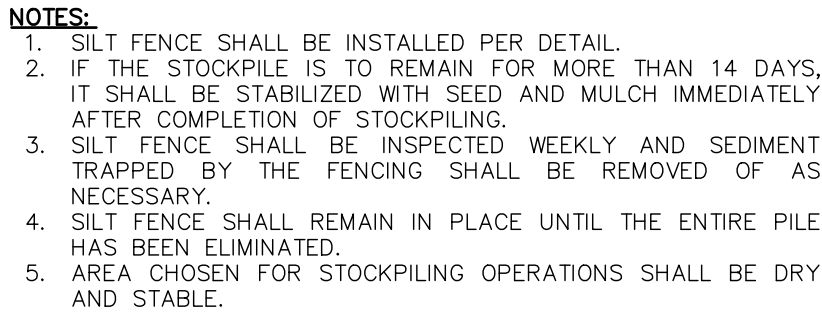

4	TEMPORARY TOPSOIL STOCKPILE DETAIL
503	NOT TO SCALE

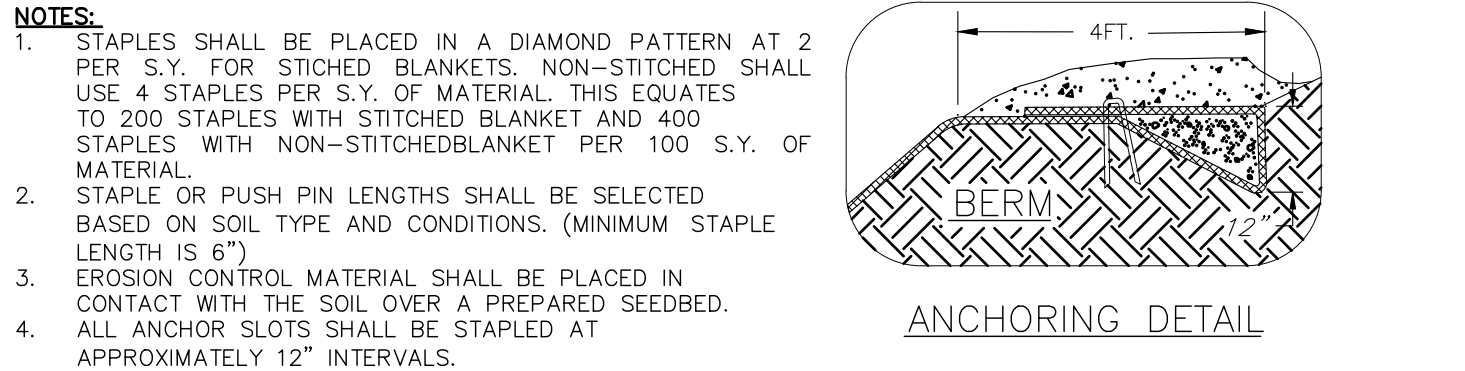

5
503

EROSION CONTROL BLANKET
INSTALLATION DETAIL
NOT TO SCALE

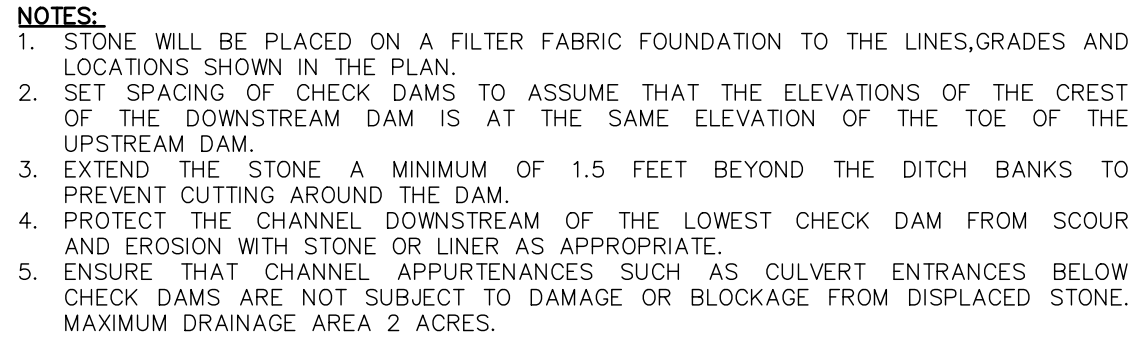

6 CHECK DAM DETAIL
503 NOT TO SCALE

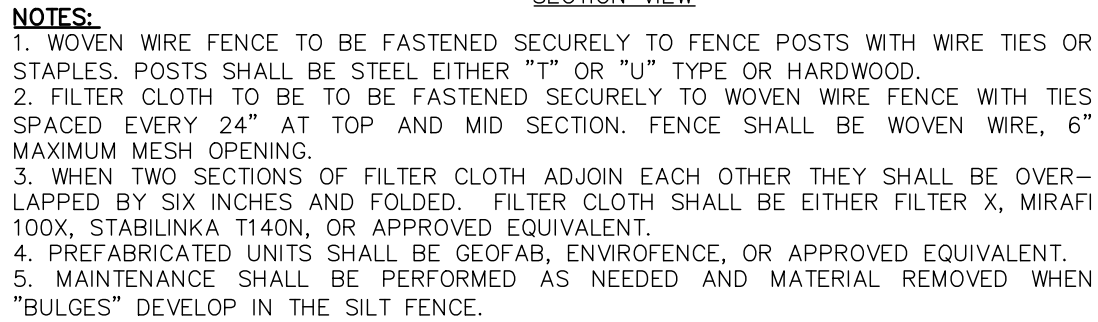

7
503. SILT FENCE DETAIL
NOT TO SCALE

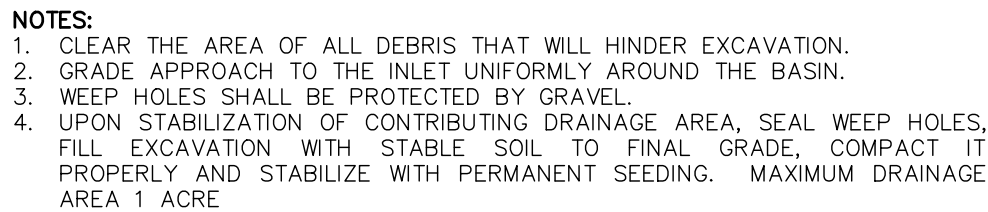

8 DROP INLET PROTECTION DETAIL

PRIOR TO ANY EARTH
DISTURBANCE THE CONTRACTOR
SHALL CALL IN A TICKET TO
DIG SAFE NY AND OBTAIN A
CLEAR TO DIG

IT IS A VIOLATION OF SECTION 7209 OF THE NYS EDUCATION LAW FOR ANY PERSON TO ALTER ANY ITEM ON THIS PLAN IN ANY WAY UNLESS HE/SHE IS ACTING UNDER THE DIRECT SUPERVISION OF A PROFESSIONAL ENGINEER.

CHRISTOPHER D. LONGO, PE
N.Y.S. LIC. # 095840

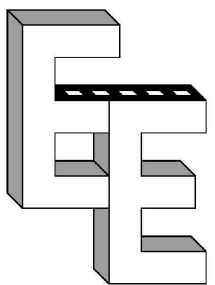

EMPIRE ENGINEERING, PLLC
1900 DUANESBURG ROAD
DUANESBURG, NY 12056
PH: (518) 280-1371
EMAIL: CLONGO@EMPIREENG.NET

EMAIL: CLONGO@EMPIREENG.NET

PROJECT

LOT 3D PARK DRIVE
GLEN CANAL VIEW PARK
TOWN OF GLEN
MONTGOMERY COUNTY

Title EROSION / SEDIMENT CONTROL DETAILS	
Date 11/22/2023	Sheet
Scale N.T.S.	C503
Job# 22051	
Sheet 7 of 7	