



MONTGOMERY COUNTY NY
Made of Something Stronger

MONTGOMERY COUNTY AMSTERDAM TRANSFER STATION

1247 STATE ROUTE 5S, AMSTERDAM, NY 12010

MAY 15, 2023

MONTGOMERY COUNTY

COUNTY ANNEX BUILDING

P.O. BOX 1500
20 PARK STREET
FONDA, NY 12068-1500

OFFICE OF THE EXECUTIVE

MATTHEW L. OSSEFORT
COUNTY EXECUTIVE

COUNTY LEGISLATURE

MICHAEL J. PEPE
CHAIRMAN OF THE LEGISLATURE

- | | |
|-----------------------|----------------------|
| LEGISLATOR DISTRICT 1 | MARTIN P. KELLY |
| LEGISLATOR DISTRICT 2 | BRIAN D. SWEET |
| LEGISLATOR DISTRICT 3 | ROY S. DIMOND |
| LEGISLATOR DISTRICT 4 | ROBERT HEADWELL, JR. |
| LEGISLATOR DISTRICT 5 | DANIEL P. WILSON |
| LEGISLATOR DISTRICT 6 | JOHN M. DUCHESSI |
| LEGISLATOR DISTRICT 7 | MICHAEL J. PEPE |
| LEGISLATOR DISTRICT 8 | JOSEPH M. ISABEL |
| LEGISLATOR DISTRICT 9 | ROBERT A. PURTELL |

CLERK OF THE LEGISLATURE
CHERYL A. REESE

DEPARTMENT OF SOCIAL SERVICES

MICHAEL McMAHON
COMMISSIONER

THOMAS LIPPIE
DEPUTY COMMISSIONER

JESSICA BATES
DEPUTY COMMISSIONER - FISCAL OPERATIONS

DEPARTMENT OF PUBLIC WORKS

ERIC M. MEAD
COMMISSIONER OF PUBLIC WORKS

ABBREVIATIONS

THIS ABBREVIATION LIST IS A STANDARD AND NOT ALL ABBREVIATIONS ARE NECESSARILY USED ON THIS PROJECT

@	AT	EXIST	EXISTING	MIN	MINIMUM
CL or	CENTERLINE	ETR	EXISTING TO REMAIN	MIR	MIRROR
DIA or	DIAMETER	EBCNYS	EXISTING BUILDING CODE OF NEW YORK	MISC	MISCELLANEOUS
#	NUMBER OR POUND	YORK		MR-GWB	MOISTURE RESISTANT GYPSUM WALL BOARD
AB.	ABOVE	EXP	EXPANSION	MTD	MOUNTED
AFF	ABOVE FINISH FLOOR	EJ	EXPANSION JOINT	MUL	MULLION
AP	ACCESS PANEL	EXPO	EXPOSED	NFPA	NATIONAL FIRE PROTECTION ASSOCIATION
ACT	ACOUSTICAL CEILING TILE	EXT	EXTERIOR	(N)	NEW
ADJ	ADJUSTABLE	EIFS	EXTERIOR INSULATED FINISH SYSTEM	NRC	NOISE REDUCTION COEFFICIENT
AGG	AGGREGATE	FO	FACE OF	NOM	NOMINAL
ALT	ALTERNATE	FOC	FACE OF CONCRETE	NIC	NOT IN CONTRACT
ALUM	ALUMINUM	FOF	FACE OF FINISH	NTS	NOT TO SCALE
ATB	ALUMINUM T-BAR GRID	FOM	FACE OF MASONRY	NO	NUMBER
AB	ANCHOR BOLT	FOS	FACE OF STUD	OFF	OFFICE
ANC	ANCHOR	FM	FACTORY MUTUAL	OC	ON CENTER
APPROX	APPROXIMATELY	FFU	FAN FILTER UNIT	OPNG	OPENING
ARCH	ARCHITECTURAL	FCB	FIBER CEMENT BOARD	OPP	OPPOSITE
AD	AREA DRAIN	FG	FIBERGLASS	OJ	OVER
ACM	ASBESTOS CONTAINING MATERIAL	FIN	FINISH	OA	OVER ALL
BSMT	BASEMENT	FA	FIRE ALARM	OH	OVERHEAD
BRG	BEARING	FDC	FIRE DEPT. CONN.	OPCI	OWNER PROVIDED, CONTRACTOR
BM	BEAM	FE	FIRE EXTINGUISHER		INSTALLED
B.M.	BENCH MARK	FEC	FIRE EXTINGUISHER CABINET	OPOI	OWNER PROVIDED, OWNER
BFF	BELOW FINISH FLOOR	FHC	FIRE HOSE CONNECTION		INSTALLED
BTUM	BITUMINOUS	FH	FIRE HYDRANT	PTD	PAINTED
BLK	BLOCK	FR	FIRE-RESISTIVE	PR	PAIR
BD	BOARD	FLAM	FLAMMABLE	PTN	PARTITION
B.O.	BOTTOM OF	FLASH	FLASHING	PVG	PAVING
BOT	BOTTOM	FLR	FLOOR	PLAS	PLASTIC OF PLASTER
BLDG	BUILDING	FD	FLOOR DRAIN	P LAM	PLASTIC LAMINATE
BCNYS	BUILDING CODE OF NEW YORK STATE	FJ	FLOOR JOIST	PLATE	PLATE
CAB	CABINET	FLUOR	FLUORESCENT	PLMG	PLUMBING
CAR	CARPET	FT	FOOT OF FEET	PC	PLUMBING CONTRACTOR
CIP	CAST IN PLACE	FTG	FOOTING	PCNYS	PLUMBING CODE OF NEW YORK STATE
CI	CAST IRON	FDN	FOUNDATION	PLYWD	PLYWOOD
CB	CATCH BASIN	FURR	FURRING	PT	POINT OR PRESSURE TREATED
CLKG	CAULKING	(F)	FUTURE	PSF	POUNDS PER SQUARE FOOT
CLG	CEILING	GALV	GALVANIZED	QTY	QUANTITY
CEM	CEMENT	GA	GAUGE OR GYPSUM ASSOCIATION	RD	ROOF DRAIN
CTR	CENTER	GL	GLASS	REC	RECESSED
CL	CENTER LINE	GR	GRADE	REF	REFERENCE
CER	CERAMIC	GND	GROUND	REIN	REINFORCED
CT	CERAMIC TILE	GYP	GYPSUM	REL	RELOCATE RISER
CO	CLEAN OUT	GWB	GYPSUM WALL BOARD	(R)	REMOVE
CLR	CLEAR	HCP	HANDICAPPED	REQD	REQUIRED
CCTV	CLOSED CIRCUIT TELEVISION	HWWR	HARDWARE	RCP	REFLECTED CEILING PLAN
CLOS	CLOSET	HVAC	HEATING, VENTILATING & AIR CONDITIONING	RM	ROOM
COL	COLUMN	HD	HEAVY DUTY	RO	ROUGH OPENING
CONC	CONCRETE	HGT	HEIGHT	SJ	SAWCUT JOINT
CMU	CONCRETE MASONRY UNIT	H	HIGH	SCHED	SCHEDULE
CONN	CONNECTION	HC	HOLLOW CORE	SECT	SECTION
CONST	CONSTRUCTION	HM	HOLLOW METAL	SHT	SHEET
CONT	CONTINUOUS	HORIZ	HORIZONTAL	SIM	SIMILAR
CJ	CONTROL JOINT	ID	INSIDE DIAMETER	STC	SOUND TRANSMISSION CLASS
COORD	COORDINATE	INSUL	INSULATION	SPEC	SPECIFICATION
CORR	CORRIDOR	INT	INTERIOR	SQ	SQUARE
CYL	CYLINDER	IBC	INTERNATIONAL BUILDING CODE	SF	SQUARE FEET
D1	DE-IONIZED	JT	JOINT	SS	STAINLESS STEEL
(D)	DEMOLISH	JST	JOIST	STD	STANDARD
DEPT	DEPARTMENT	LAM	LAMINATE	STA	STATION
DET	DETAIL	LG	LENGTH	STL	STEEL
Ø	DIAMETER	L	LENGTH	STOR	STORAGE
DIM	DIMENSION	LVL	LEVEL	STRUC	STRUCTURAL
DISP	DISPENSER	LU/LA	LIMITED USE/LIMITED APPLICATION	SL	STRUCTURAL LEVEL
DR	DOOR	LF	LINEAL FEET	SUSP	SUSPENDED
DO	DOOR OPENING	LKR	LOCKER	SYM	SYMMETRICAL
DBL	DOUBLE	LLH	LONG LEG HORIZONTAL	THK	THICK(NESS)
DN	DOWN	LLV	LONG LEG VERTICAL	THRES	THRESHOLD
DS	DOWNSPOUT	LB	POUND	T.O.	TOP OF
DWR	DRAWER	LNH	LONG LEG HORIZONTAL	TYP	TYPICAL
DWG	DRAWING	MFR	MANUFACTURER	UL	UNDERWRITERS LABORATORY
DSP	DRY STANDPIPE	MAS	MASONRY	UNO	UNLESS NOTED OTHERWISE
EA	EACH	MO	MASONRY OPENING	VIF	VERIFY IN FIELD
EW	EACH WAY	MAT	MATERIAL	VERT	VERTICAL
E	EAST	MAX	MAXIMUM	WT	WEIGHT
ELEC	ELECTRICAL	MECH	MECHANICAL	WWM	WELDED WIRE MESH
EL	ELEVATION	MC	MECHANICAL CONTRACTOR	W/	WITH
ELEV	ELEVATOR	MTL	METAL	W/O	WITHOUT
EMER	EMERGENCY	MTL PNL	METAL PANEL	WD	WOOD
ENCL	ENCLOSED	M	METER		
EP	EPOXY	MEZZ	MEZZANINE		
EQ	EQUAL	MM	MILLIMETER		
EQUIP	EQUIPMENT				
EXH	EXHAUST				
(E)	EXISTING				

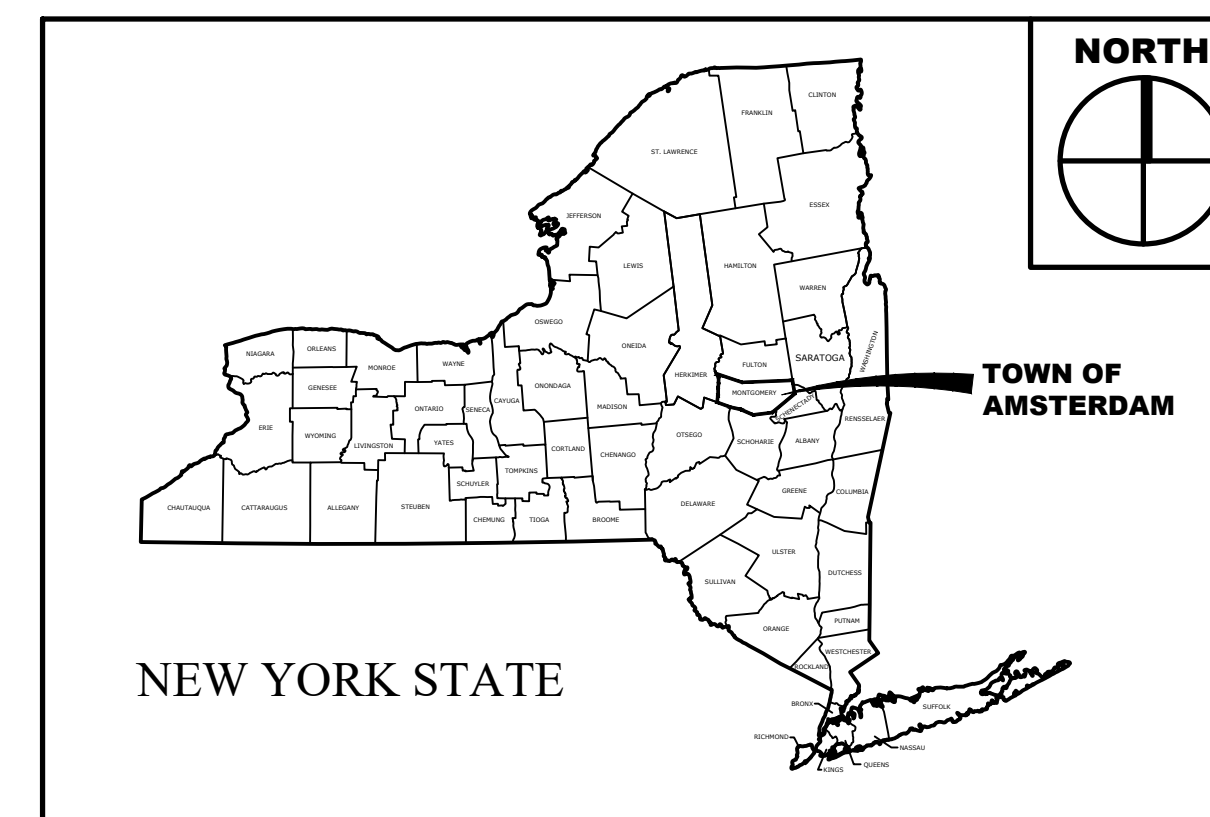
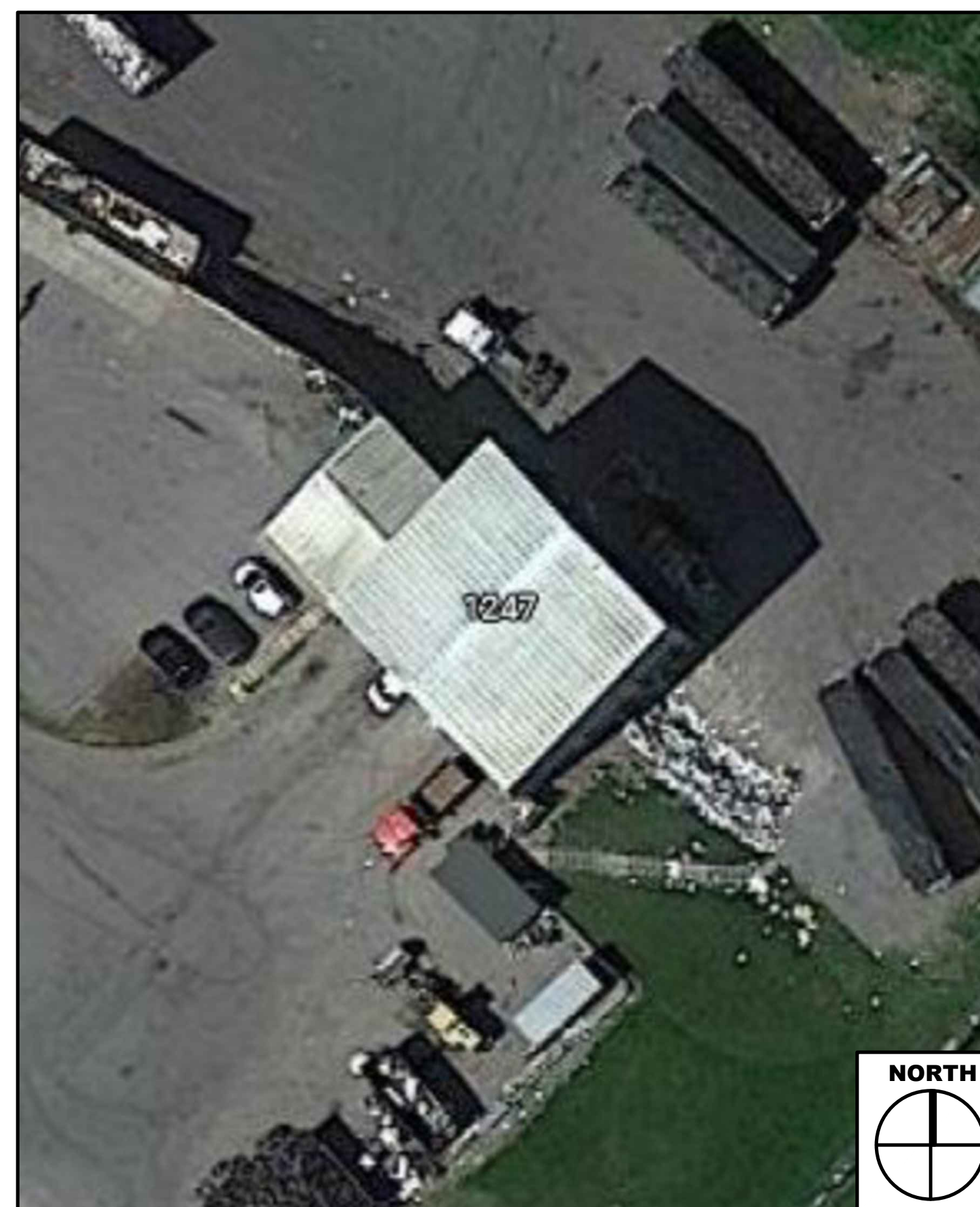

SITE LOCATION MAP

DRAWING LIST

SHEET DESCRIPTION	SHEET TITLE	SHEET NUMBER
G-001	COVER SHEET	01
SD-101	TIPPING FLOOR CONCRETE SLAB REPLACEMENT DEMO PLAN & DETAILS	02
S-101	TIPPING FLOOR CONCRETE SLAB REPLACEMENT NEW SLAB PLAN & DETAILS	03

SYMBOLS LIST

	PHOTO TAG		WINDOW TAG
	SECTION TAG		CONSTRUCTION NOTE TAG
	DETAIL TAG		DOOR TAG
	WALL TYPE TAG		ROOM NAME
	INTERIOR ELEVATION TAG		ROOM IDENTIFICATION TAG
			SECTION (NUMBER) OR DETAIL (NUMBER) DESIGNATION
			SHEET NUMBER WHERE SECTION OR DETAIL IS LOCATED

© 2023
C.T. MALE ASSOCIATES
WARNING: IT IS A VIOLATION OF THE LAW FOR ANY PERSON, UNLESS ACTING UNDER THE DIRECTION OF A LICENSED ARCHITECT, TO ALTER AN ITEM IN ANY WAY, IF AN ITEM BEARING THE SEAL OF AN ARCHITECT IS ALTERED, THE ALTERING ARCHITECT SHALL AFFIX TO HIS ITEM THE SEAL AND THE NOTATION "ALTERED BY" FOLLOWED BY HIS SIGNATURE AND THE DATE OF SUCH ALTERATION, AND A SPECIFIC DESCRIPTION OF THE ALTERATION, ARCHITECTURE
- COMMISSIONER'S REGULATIONS PART 69.5.
WARNING: IT IS A VIOLATION OF THIS LAW FOR ANY PERSON, UNLESS HE IS ACTING UNDER THE DIRECTION OF A LICENSED PROFESSIONAL ENGINEER OR LAND SURVEYOR, TO ALTER AN ITEM IN ANY WAY, IF AN ITEM BEARING THE SEAL OF AN ENGINEER OR LAND SURVEYOR IS ALTERED, THE ALTERING ENGINEER OR LAND SURVEYOR SHALL AFFIX TO THE ITEM HIS SEAL AND THE NOTATION "ALTERED BY" FOLLOWED BY HIS SIGNATURE AND THE DATE OF SUCH ALTERATION, AND A SPECIFIC DESCRIPTION OF THE ALTERATION, PROFESSIONAL ENGINEERING AND LAND SURVEYING - ART. 145, SECTION. 7209

C.T. MALE ASSOCIATES

Engineering, Surveying, Architecture, Landscape Architecture & Geology, D.P.C.

50 CENTURY HILL DRIVE, LATHAM, NY 518.786.7400
GLENS FALLS, NY • POUGHKEEPSIE, NY • JOHNSTOWN, NY
REDHOOK, NY • SYRACUSE, NY

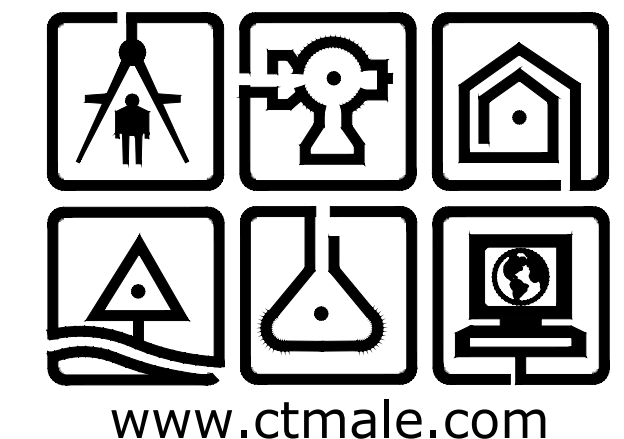

www.ctmale.com

PROJECT NO. 22.2793
DRAWING NO. 23-0318

G-001
SHEET 01 OF 03

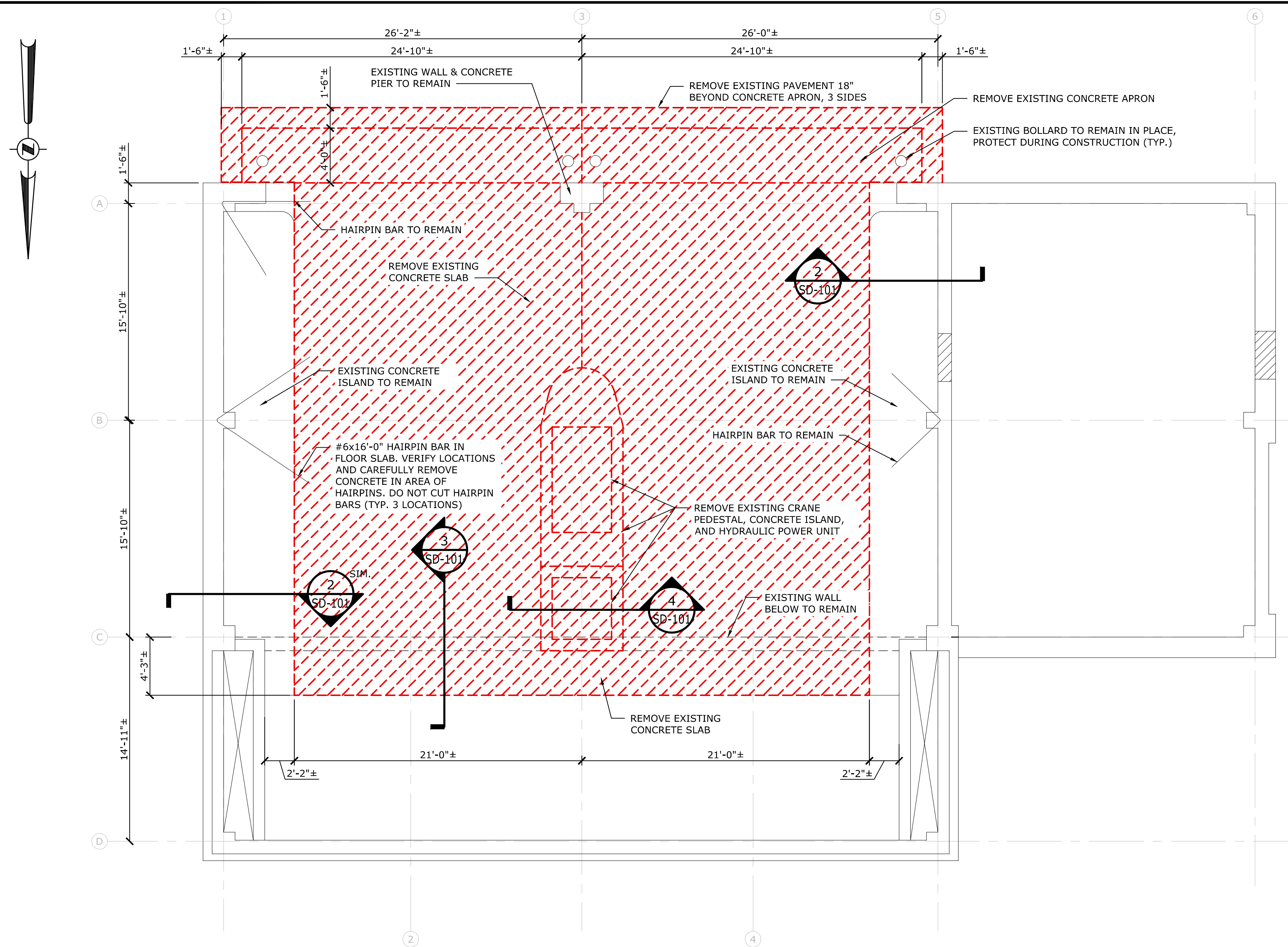

GENERAL DEMOLITION NOTES

- EXISTING ITEMS TO REMAIN: PROTECT CONSTRUCTION INDICATED TO REMAIN AGAINST DAMAGE AND SOILING DURING SELECTIVE DEMOLITION.
 - WHEN PERMITTED BY OWNER'S REPRESENTATIVE, ITEMS MAY BE REMOVED TO A SUITABLE, PROTECTED STORAGE LOCATION DURING SELECTIVE DEMOLITION AND REINSTALLED IN THEIR ORIGINAL LOCATIONS AFTER SELECTIVE DEMOLITION OPERATIONS ARE COMPLETE.
- CONCEALED OR UNKNOWN CONDITIONS. IF THE CONTRACTOR ENCOUNTERS CONDITIONS AT THE SITE THAT ARE (1) SUBSURFACE OR OTHERWISE CONCEALED PHYSICAL CONDITIONS THAT DIFFER MATERIALLY FROM THOSE INDICATED IN THE CONTRACT DOCUMENTS OR (2) UNKNOWN PHYSICAL CONDITIONS OF AN UNUSUAL NATURE THAT DIFFER MATERIALLY FROM THOSE ORDINARILY FOUND TO EXIST AND GENERALLY RECOGNIZED AS INHERENT IN CONSTRUCTION ACTIVITIES OF THE CHARACTER PROVIDED FOR IN THE CONTRACT DOCUMENTS, THE CONTRACTOR SHALL PROMPTLY PROVIDE NOTICE TO THE OWNER'S REPRESENTATIVE BEFORE CONDITIONS ARE DISTURBED. THE ARCHITECT WILL PROMPTLY INVESTIGATE SUCH CONDITIONS AND, IF THE OWNER'S REPRESENTATIVE DETERMINES THAT THEY DIFFER MATERIALLY AND CAUSE AN INCREASE OR DECREASE IN THE CONTRACTOR'S COST OF, OR TIME REQUIRED FOR, PERFORMANCE OF ANY PART OF THE WORK, WILL RECOMMEND AN EQUITABLE ADJUSTMENT IN THE CONTRACT SUM OR CONTRACT TIME, OR BOTH. IF THE OWNER'S REPRESENTATIVE DETERMINES THAT THE CONDITIONS AT THE SITE ARE NOT MATERIALLY DIFFERENT FROM THOSE INDICATED IN THE CONTRACT DOCUMENTS AND THAT NO CHANGE IN THE TERMS OF THE CONTRACT IS JUSTIFIED, THE STATION'S REPRESENTATIVE SHALL PROMPTLY NOTIFY THE OWNER AND CONTRACTOR IN WRITING, STATING THE REASONS.
- REMOVAL OF HAZARDOUS MATERIALS ARE NOT ANTICIPATED. IF OTHER SUSPECTED HAZARDOUS MATERIALS ARE ENCOUNTERED, DO NOT DISTURB; IMMEDIATELY NOTIFY THE OWNER.
- THE GENERAL CONTRACTOR SHALL BE RESPONSIBLE FOR CUTTING, FITTING OR PATCHING REQUIRED TO COMPLETE THE WORK OR TO MAKE ITS PARTS FIT TOGETHER PROPERLY. ALL AREAS REQUIRING CUTTING, FITTING AND PATCHING SHALL BE RESTORED TO THE CONDITION EXISTING PRIOR TO THE CUTTING, FITTING AND PATCHING, UNLESS OTHERWISE REQUIRED BY THE CONTRACT DOCUMENTS.
- THE CONTRACTOR SHALL NOT DAMAGE OR ENDANGER A PORTION OF THE WORK OR FULLY OR PARTIALLY COMPLETED CONSTRUCTION OF THE OWNER OR SEPARATE CONTRACTORS BY CUTTING, PATCHING OR OTHERWISE ALTERING SUCH CONSTRUCTION, OR BY EXCAVATION. THE CONTRACTOR SHALL NOT CUT OR OTHERWISE ALTER SUCH CONSTRUCTION BY THE OWNER OR A SEPARATE CONTRACTOR EXCEPT WITH WRITTEN CONSENT OF THE OWNER AND OF SUCH SEPARATE CONTRACTOR; SUCH CONSENT SHALL NOT BE UNREASONABLY WITHHELD. THE CONTRACTOR SHALL NOT UNREASONABLY WITHHOLD FROM THE OWNER OR A SEPARATE CONTRACTOR THE CONTRACTOR'S CONSENT TO CUTTING OR OTHERWISE ALTERING THE WORK.
- THE CONTRACTOR SHALL KEEP THE PREMISES AND SURROUNDING AREA FREE FROM ACCUMULATION OF WASTE MATERIALS OR RUBBISH CAUSED BY OPERATIONS UNDER THE CONTRACT. AT COMPLETION OF THE WORK, THE CONTRACTOR SHALL REMOVE WASTE MATERIALS, RUBBISH, THE CONTRACTOR'S TOOLS, CONSTRUCTION EQUIPMENT, MACHINERY AND SURPLUS MATERIALS FROM AND ABOUT THE PROJECT.
- IF THE CONTRACTOR FAILS TO CLEAN UP AS PROVIDED IN THE CONTRACT DOCUMENTS, THE OWNER MAY DO SO AND OWNER SHALL BE ENTITLED TO REIMBURSEMENT FROM THE CONTRACTOR.
- TEMPORARY PROTECTION: PROVIDE TEMPORARY BARRICADES AND OTHER PROTECTION REQUIRED TO PREVENT INJURY TO PEOPLE AND DAMAGE TO ADJACENT BUILDINGS AND FACILITIES TO REMAIN.
 - PROVIDE PROTECTION TO ENSURE SAFE PASSAGE OF PEOPLE AROUND SELECTIVE DEMOLITION AREA AND TO AND FROM OCCUPIED PORTIONS OF BUILDING.
 - PROTECT WALLS, CEILINGS, FLOORS, AND OTHER EXISTING FINISH WORK THAT ARE TO REMAIN OR THAT ARE EXPOSED DURING SELECTIVE DEMOLITION OPERATIONS.
 - COVER AND PROTECT FURNITURE, FURNISHINGS, AND EQUIPMENT THAT HAVE NOT BEEN REMOVED.

GENERAL NOTES:

- ALL EXISTING MEASUREMENTS ARE FOR REFERENCE ONLY. CONTRACTOR SHALL FIELD VERIFY ALL MEASUREMENTS AND REPORT ANY DISCREPANCIES TO ENGINEER.
- CONTRACTOR SHALL PERFORM DEMOLITION AND CONSTRUCTION IN PHASES AND SHALL PROVIDE BARRIERS AND ENCLOSURES AS REQUIRED, SO THAT ONE SIDE OF THE TRANSFER STATION CAN REMAIN IN OPERATION DURING THE PROJECT.
- CONTRACTOR SHALL COORDINATE ALL WORK WITH TRANSFER STATION OPERATORS AND MONTGOMERY COUNTY REPRESENTATIVES.
- CONTRACTOR SHALL PROVIDE TEMPORARY SUPPORT AND/OR SHORING OF EXISTING STRUCTURE AS REQUIRED, ESPECIALLY AT BASE OF COLUMNS DURING REMOVAL AND REPLACEMENT OF SLAB (SEE NOTE BELOW REGARDING HAIRPIN BARS IN SLAB).
- HAIRPIN BARS IN SLAB PROVIDE LATERAL RESISTANCE TO BUILDING COLUMNS. HAIRPIN BARS SHALL NOT BE CUT.
- REMOVAL AND REPLACEMENT OF SLAB SHALL BE COMPLETED WHEN THERE IS NO SNOW ON THE ROOF OF THE BUILDING, IN ORDER TO MINIMIZE THE LOADS TO THE STRUCTURE, ESPECIALLY THE LATERAL OUTWARD LOADS AT THE BASE OF THE BUILDING COLUMNS.

SELECTIVE DEMOLITION NOTES:

- BEFORE THE INSTALLATION OF NEW MATERIALS BEGINS, AN INSPECTION OF THE REMAINING CONSTRUCTION SHOULD BE PERFORMED. SECURE, REBUILD, AND RECTIFY REMAINING CONSTRUCTION THAT IS FOUND TO BE WEAKENED, DAMAGED, OR OTHERWISE UNSUITABLE TO RECEIVE NEW WORK.
- RETURN ELEMENTS OF CONSTRUCTION AND SURFACES THAT ARE TO REMAIN TO THE CONDITION EXISTING BEFORE DEMOLITION BEGAN. IF IDENTICAL MATERIALS ARE UNAVAILABLE OR CANNOT BE USED FOR EXPOSED SURFACES, USE MATERIALS THAT VISUALLY MATCH EXISTING ADJACENT SURFACES.
- WHEN UNANTICIPATED MECHANICAL, ELECTRICAL, OR STRUCTURAL ELEMENTS THAT CONFLICT WITH THE INTENDED FUNCTION OR DESIGN ARE ENCOUNTERED, THE DEMOLITION CONTRACTOR SHOULD INVESTIGATE, MEASURE THE NATURE AND EXTENT OF THE CONFLICT, AND SUBMIT A WRITTEN REPORT TO THE STATION'S REPRESENTATIVE.
- IT IS THE CONTRACTOR'S RESPONSIBILITY TO ENSURE THAT ALL DEMOLITION AND REMOVALS WORK IS PERFORMED IN ACCORDANCE WITH APPLICABLE OSHA, STATE, AND LOCAL BUILDING CODE REQUIREMENTS. WORKERS SKILLED IN THE TRADE SHOULD PERFORM THE WORK.
- GOVERNING EPA NOTIFICATION REGULATIONS MUST BE COMPLIED WITH BEFORE BEGINNING ANY DEMOLITION. MANY AUTHORITIES HAVE JURISDICTION OVER HAULING AND DISPOSAL OF DEMOLITION MATERIALS AND SHOULD BE COMPLIED WITH AS WELL. LIKEWISE, ADHERENCE TO ALL ANSI SAFETY REQUIREMENTS AND NFPA STANDARDS FOR SAFEGUARDING CONSTRUCTION, ALTERATION, AND DEMOLITION OPERATIONS IS REQUIRED.
- THROUGHOUT DEMOLITION THE REQUIRED MEANS OF EGRESS MUST BE MAINTAINED FROM ADJACENT OCCUPIED SPACES. TEMPORARY PARTITIONS MUST ALLOW ACCESS TO EXISTING WALKWAYS, CORRIDORS, AND OTHER ADJACENT OCCUPIED OR USED FACILITIES. EGRESS CORRIDORS OR PASSAGES SERVING OCCUPIED SPACES MUST MEET APPLICABLE CODES FOR EXIT SIGNAGE, EMERGENCY LIGHTING, LIFE SAFETY SPEAKER/STROBES, FIRE HOSE CABINETS, FIRE EXTINGUISHER PLACEMENT, FIRE WARDEN STATIONS, AND SPRINKLERS.
- DO NOT CLOSE OR OBSTRUCT WALKWAYS, CORRIDORS, OR OTHER OCCUPIED OR USED FACILITIES WITHOUT WRITTEN PERMISSION FROM AUTHORITIES HAVING JURISDICTION.

1 DEMOLITION PLAN
SCALE: 3/16" = 1'-0"
CROSS REFERENCE: NONE

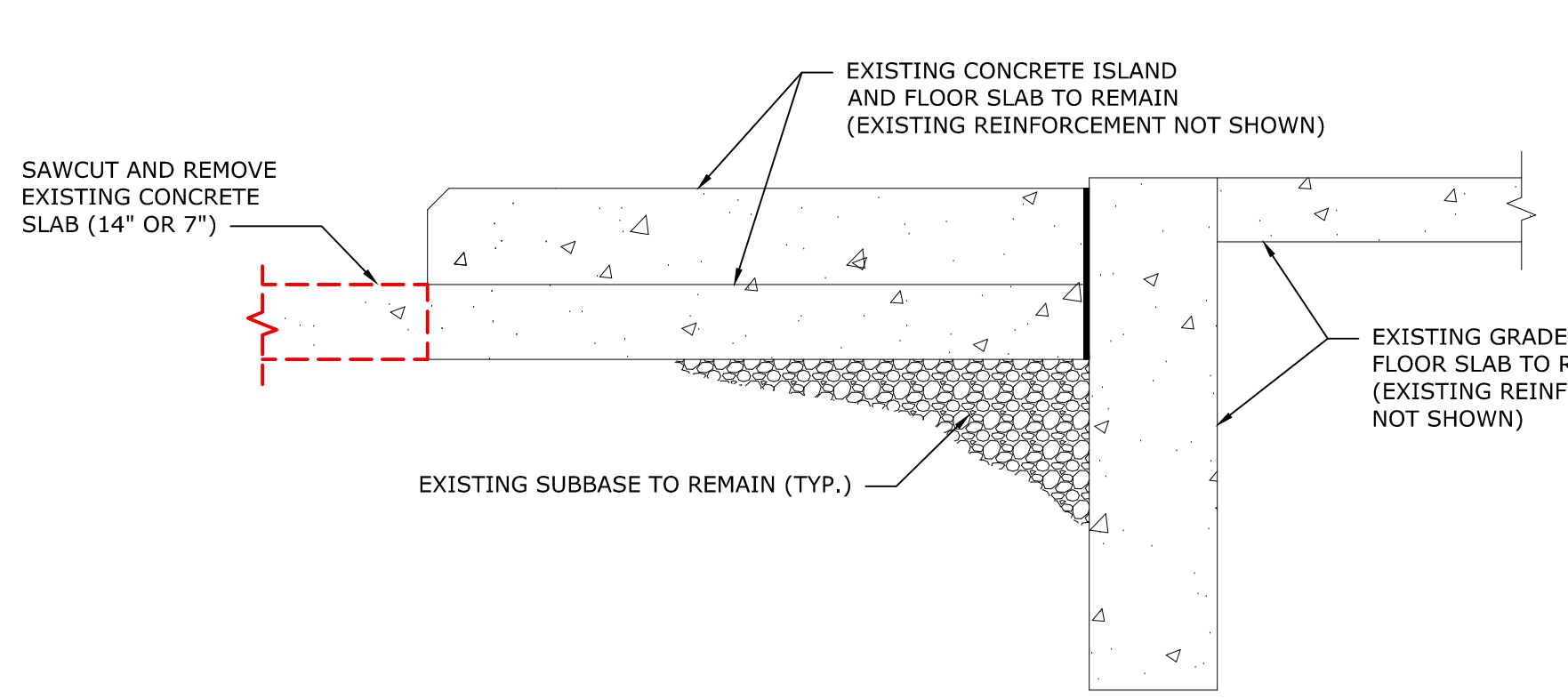

2 CONCRETE ISLAND SECTION
SCALE: 3/4" = 1'-0"
CROSS REFERENCE: 1/SD-101

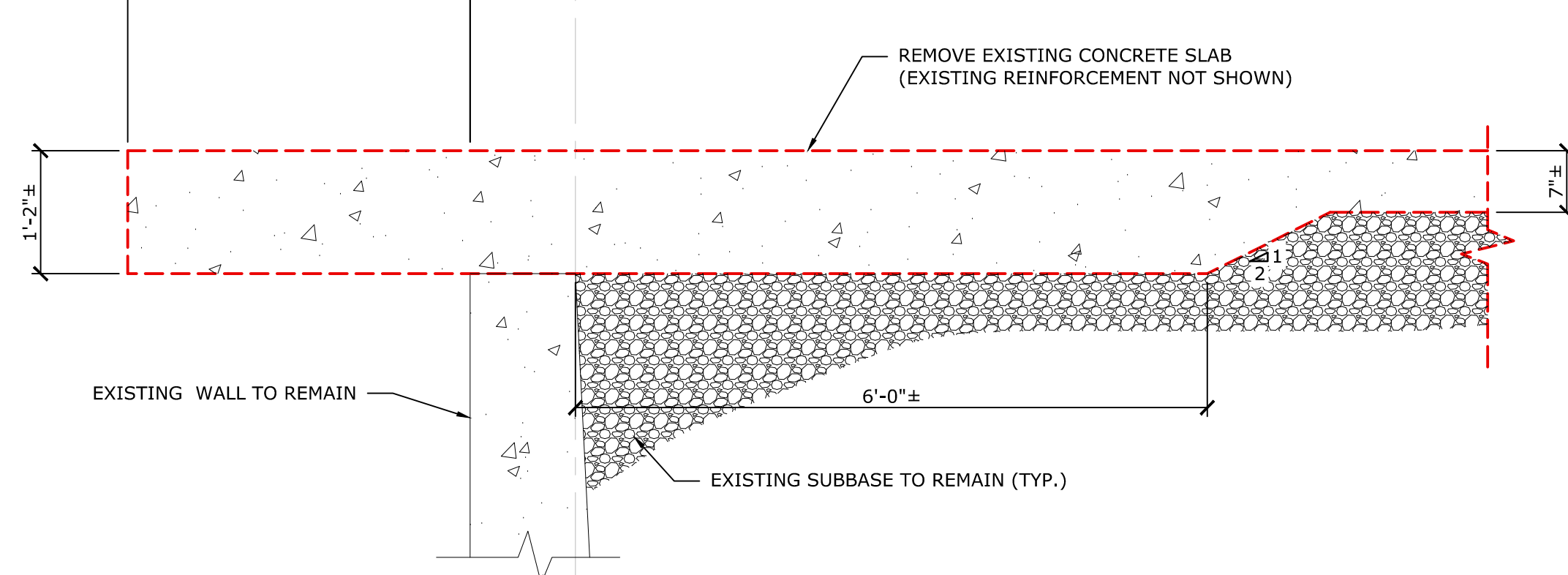

3 LOADING BAY SECTION
SCALE: 3/4" = 1'-0"
CROSS REFERENCE: 1/SD-101

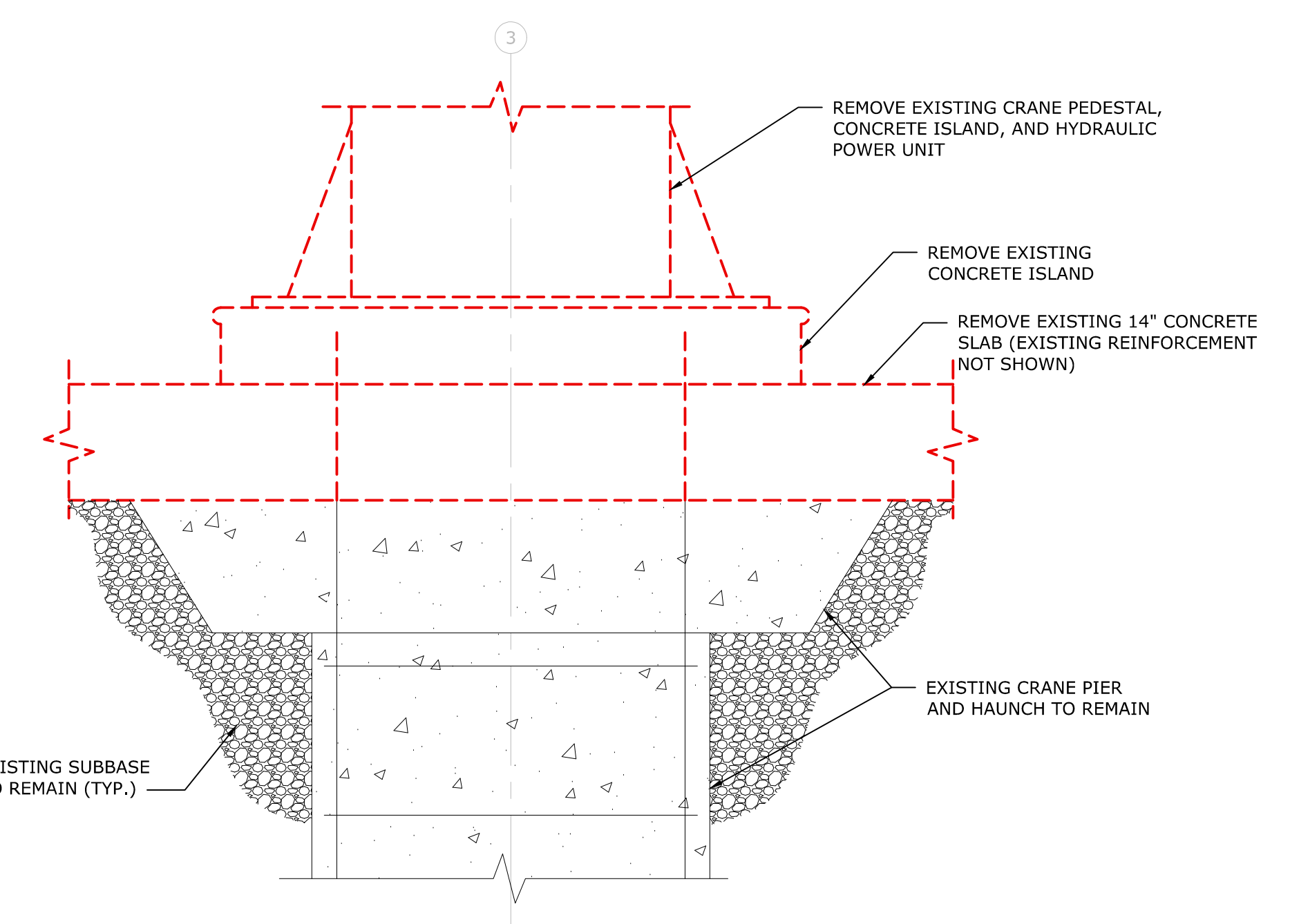
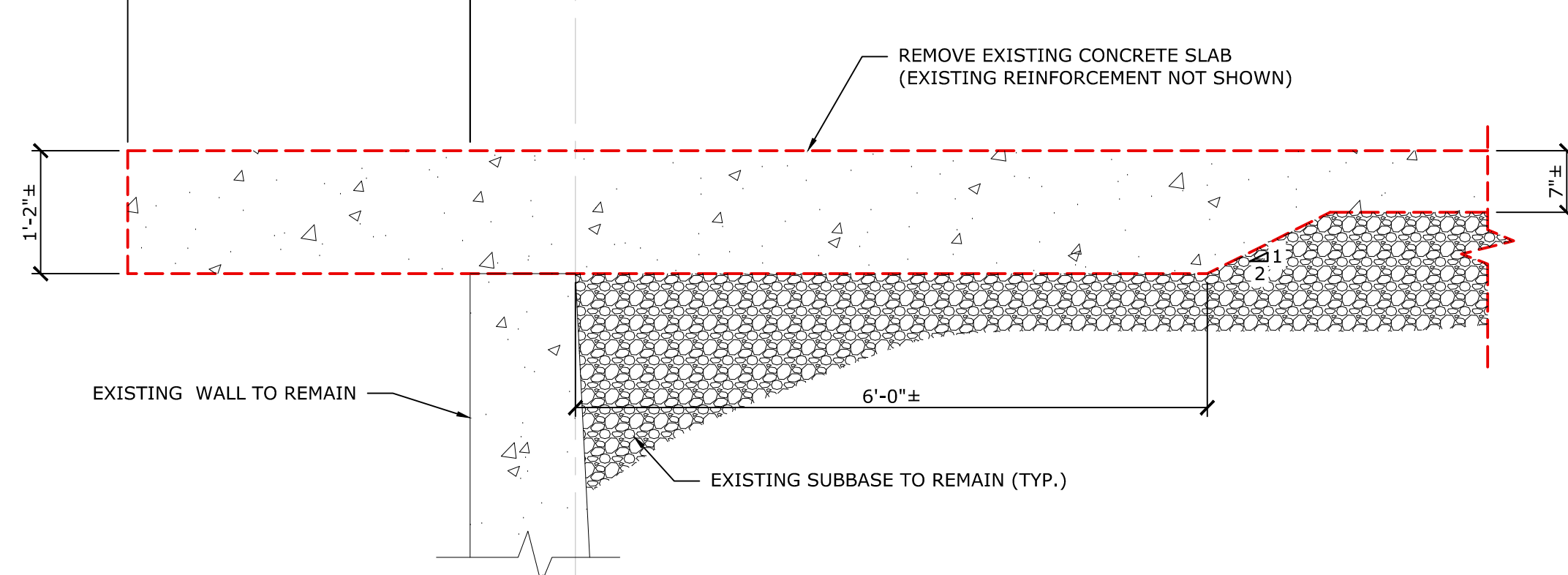

4 SECTION AT CRANE PIER
SCALE: 3/4" = 1'-0"
CROSS REFERENCE: 1/SD-101

DATE	REVISIONS RECORD/DESCRIPTION	DRAFTER	CHECK	APPR.

TIPPING FLOOR CONCRETE SLAB REPLACEMENT DEMO PLAN & DETAILS

MONTGOMERY COUNTY AMSTERDAM TRANSFER STATION
1247 STATE ROUTE 5S, AMSTERDAM, NY 12010

TOWN OF AMSTERDAM MONTGOMERY COUNTY, NEW YORK

C.T. MALE ASSOCIATES
Engineering, Surveying, Architecture, Landscape Architecture & Geology, D.P.C.
50 CENTURY HILLS DRIVE, LATHAM, NY 12110 PH: 518.786.7400
GLENS FALLS, NY • POUGHKEEPSIE, NY • JOHNSTOWN, NY
RED HOOK, NY • SYRACUSE, NY
www.ctmale.com

SD-101
SHEET 02 OF 03
DWG. NO: 23-0318

CAD DWG. FILE NAME: K:\Projects\222793\Civil\Drawings-Maps\SD-101.dwg

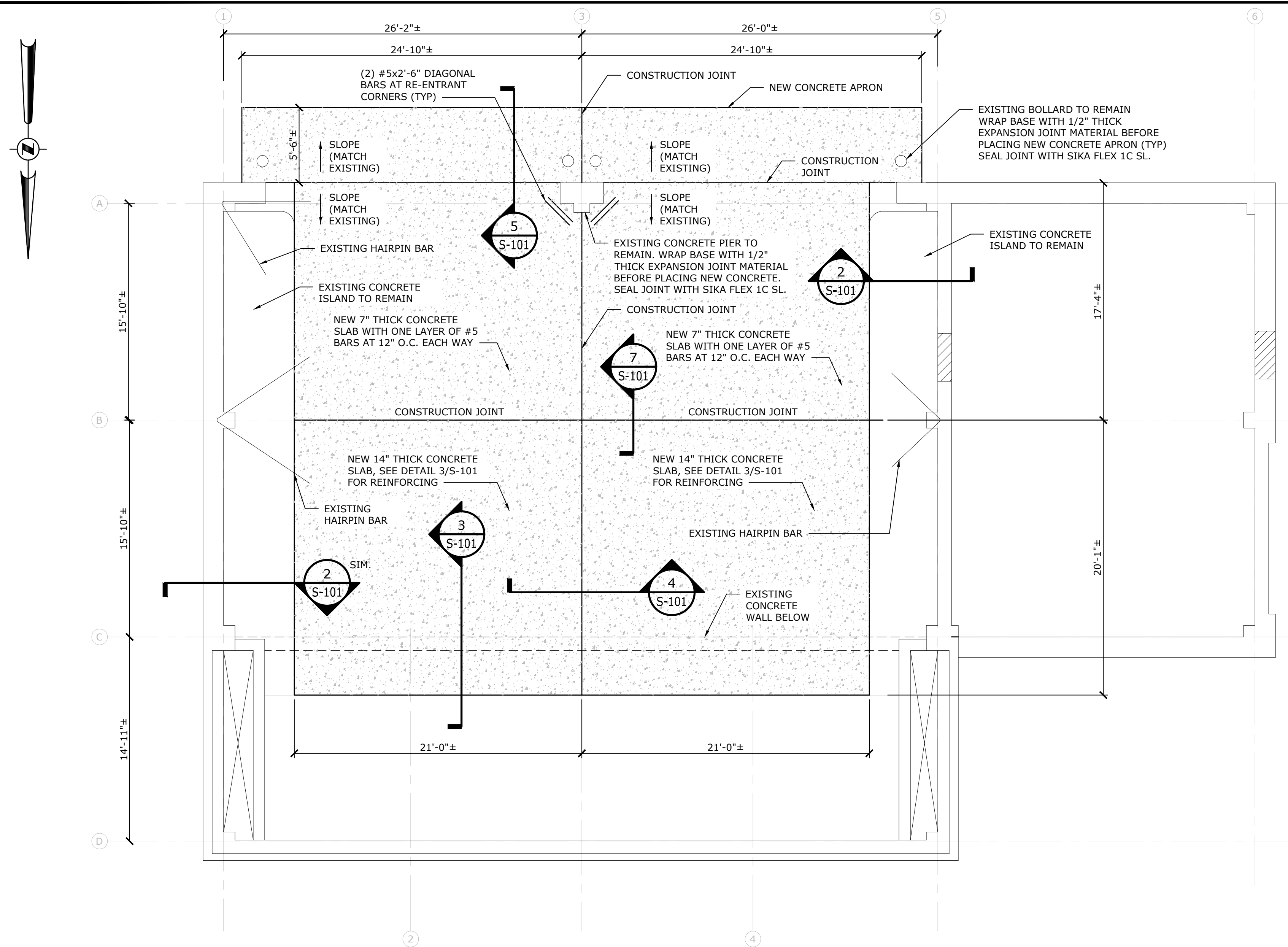

- GENERAL NOTES:**
- ALL EXISTING MEASUREMENTS ARE FOR REFERENCE ONLY. CONTRACTOR SHALL FIELD VERIFY ALL MEASUREMENTS AND REPORT ANY DISCREPANCIES TO ENGINEER.
 - CONTRACTOR SHALL PERFORM DEMOLITION AND CONSTRUCTION IN PHASES AND SHALL PROVIDE BARRIERS AND ENCLOSURES AS REQUIRED, SO THAT ONE SIDE OF THE TRANSFER STATION CAN REMAIN IN OPERATION DURING THE PROJECT.
 - CONTRACTOR SHALL COORDINATE ALL WORK WITH TRANSFER STATION OPERATORS AND MONTGOMERY COUNTY REPRESENTATIVES.
 - CONTRACTOR SHALL PROVIDE TEMPORARY SUPPORT AND/OR SHORING OF EXISTING STRUCTURE AS REQUIRED, ESPECIALLY AT BASE OF COLUMNS DURING REMOVAL AND REPLACEMENT OF SLAB (SEE NOTE BELOW REGARDING HAIRPIN BARS IN SLAB).
 - HAIRPIN BARS IN SLAB PROVIDE LATERAL RESISTANCE TO BUILDING COLUMNS. HAIRPIN BARS SHALL NOT BE CUT.
 - REMOVAL AND REPLACEMENT OF SLAB SHALL BE COMPLETED WHEN THERE IS NO SNOW ON THE ROOF OF THE BUILDING, IN ORDER TO MINIMIZE THE LOADS TO THE STRUCTURE, ESPECIALLY THE LATERAL OUTWARD LOADS AT THE BASE OF THE BUILDING COLUMNS.

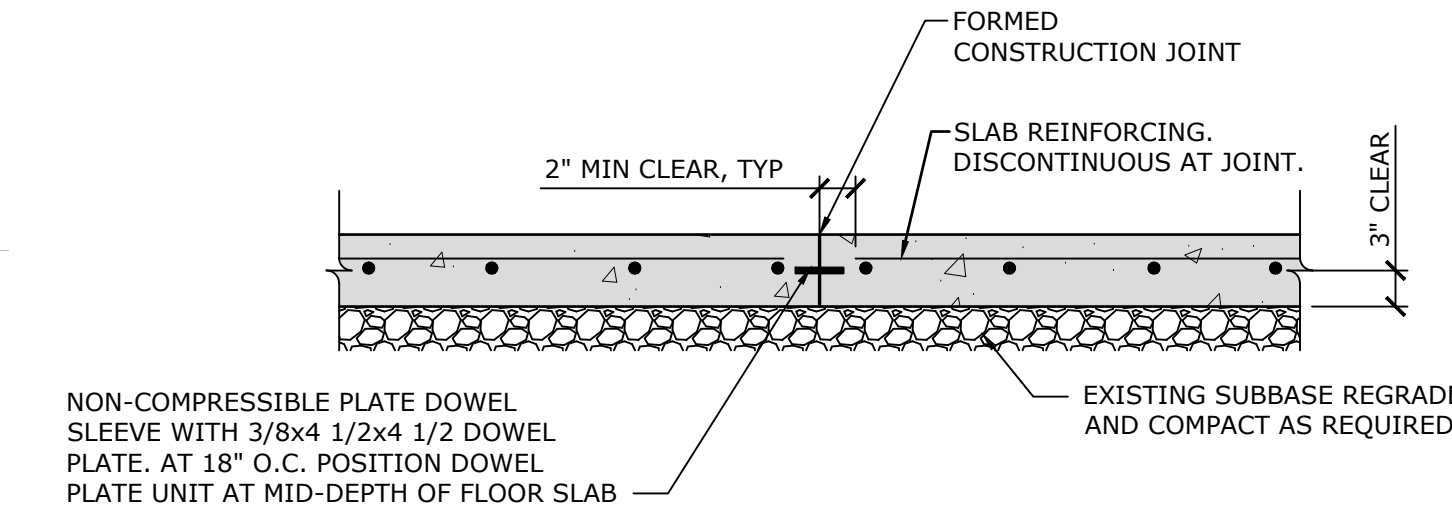

NOTES:
 1. PLATE DOWELS WITH PLASTIC SLEEVES SHALL BE "DIAMOND DOWELS" AS MANUFACTURED BY PNA CONSTRUCTION TECHNOLOGIES, INC OR APPROVED EQUAL. ATTACH TO SIDE FORMS PER MANUFACTURER'S INSTRUCTIONS.

6
 S-101
SLAB-ON-GRADE CONSTRUCTION JOINT
 SCALE: NONE
 CROSS REFERENCE: 1/S-101

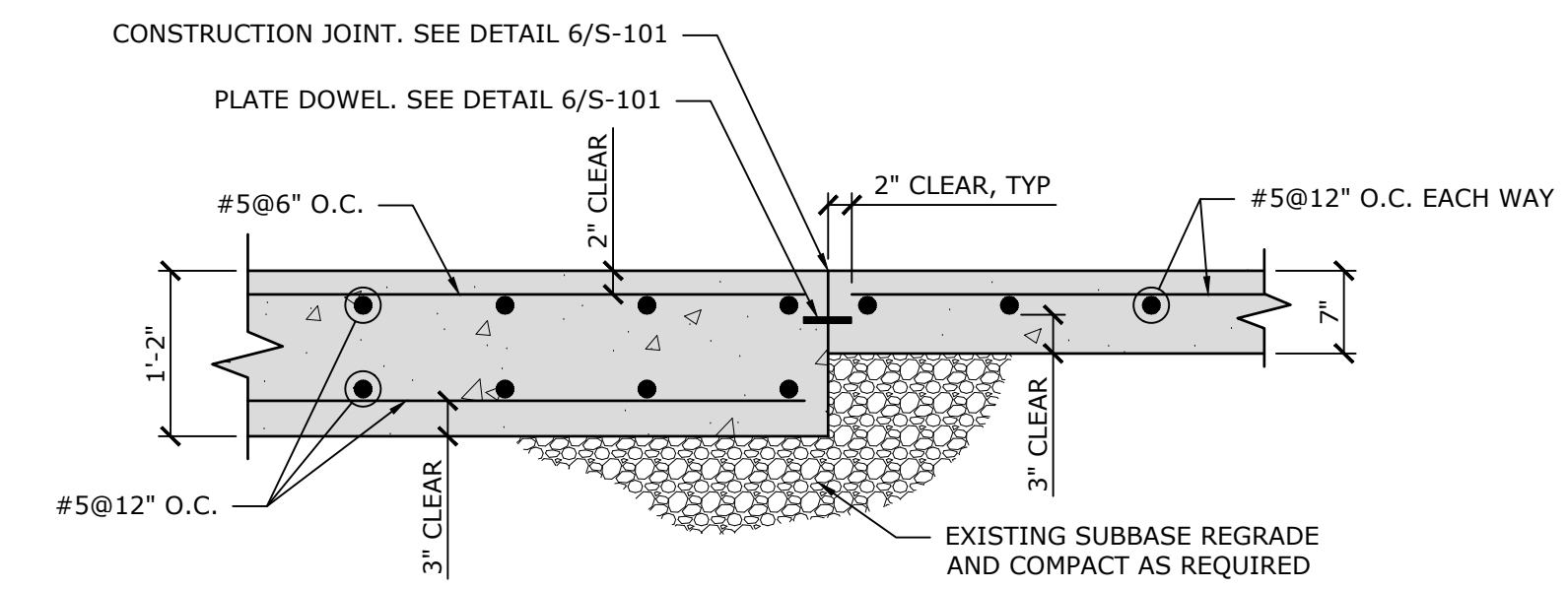

7
 S-101
CONSTRUCTION JOINT AT 14" TO 7" SLAB TRANSITION
 SCALE: NONE
 CROSS REFERENCE: 1/S-101

1
 S-101
NEW SLAB PLAN
 SCALE: 3/16" = 1'-0"
 CROSS REFERENCE: NONE

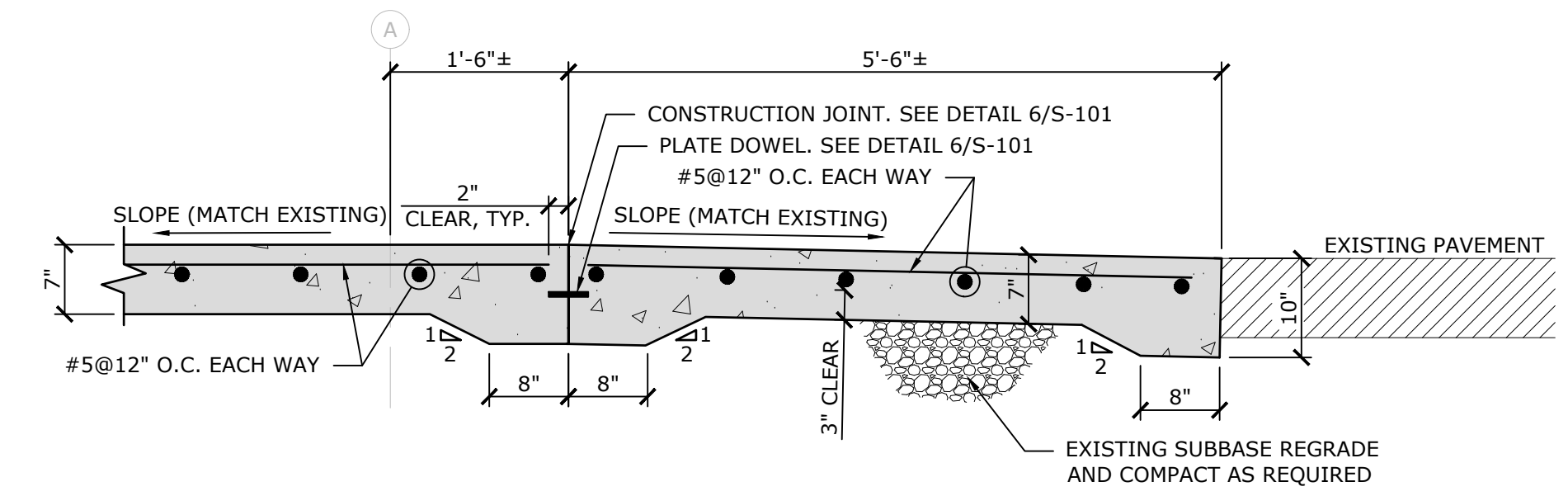

5
 S-101
APRON SECTION
 SCALE: 3/4" = 1'-0"
 CROSS REFERENCE: 1/S-101

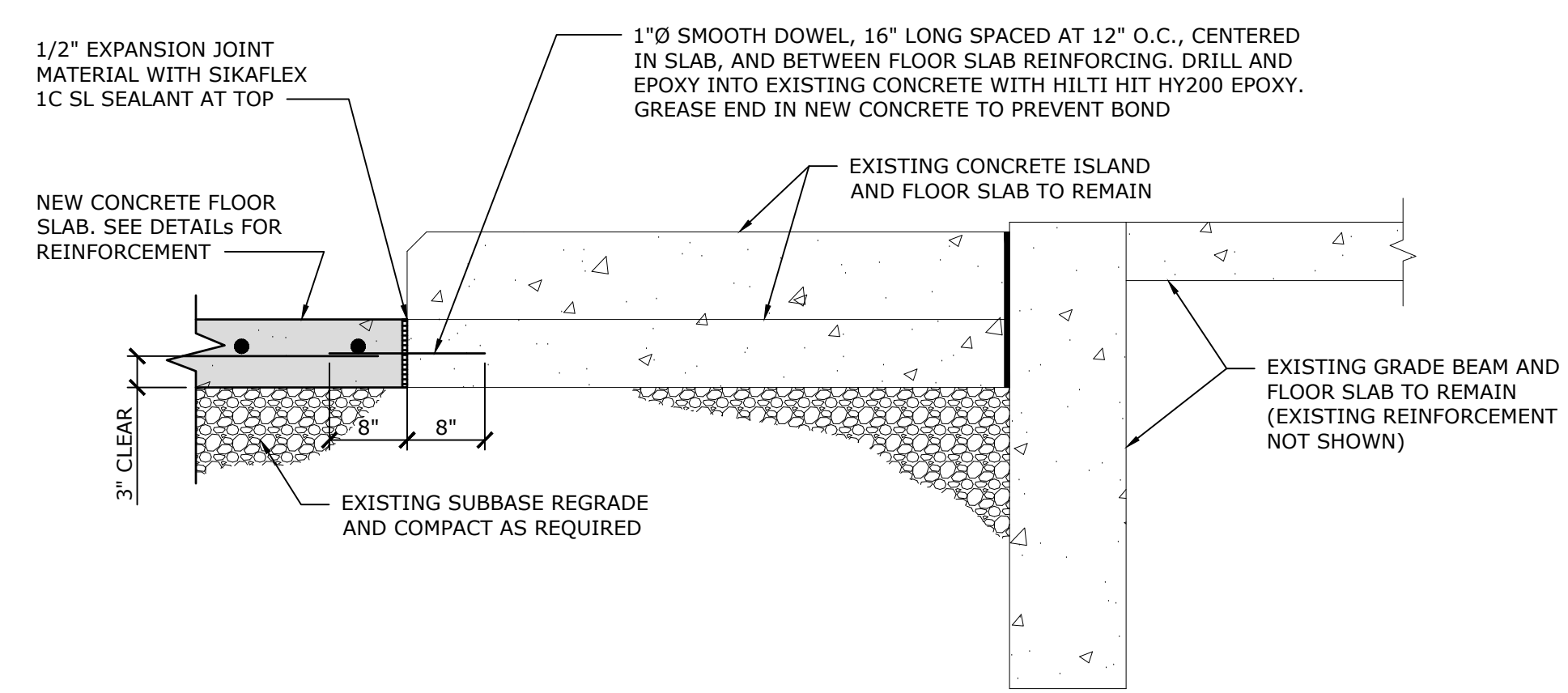

2
 S-101
CONCRETE ISLAND SECTION
 SCALE: 3/4" = 1'-0"
 CROSS REFERENCE: 1/S-101

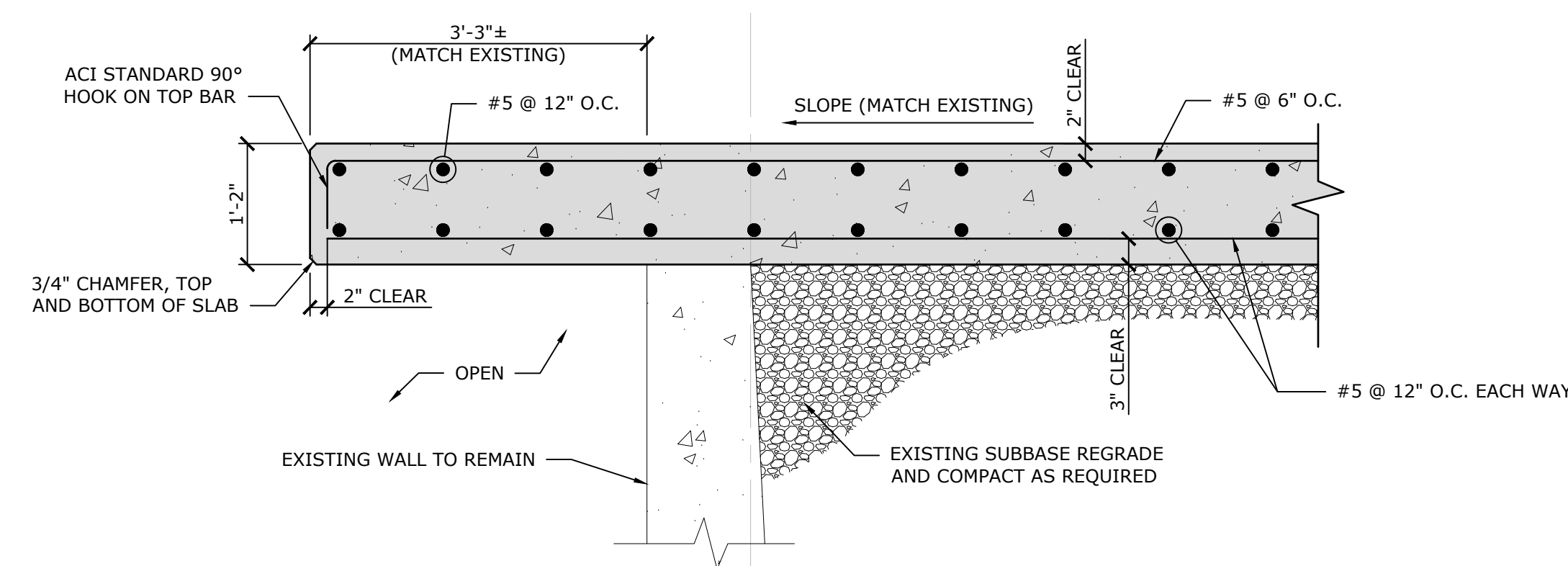

3
 S-101
LOADING BAY SECTION
 SCALE: 3/4" = 1'-0"
 CROSS REFERENCE: 1/S-101

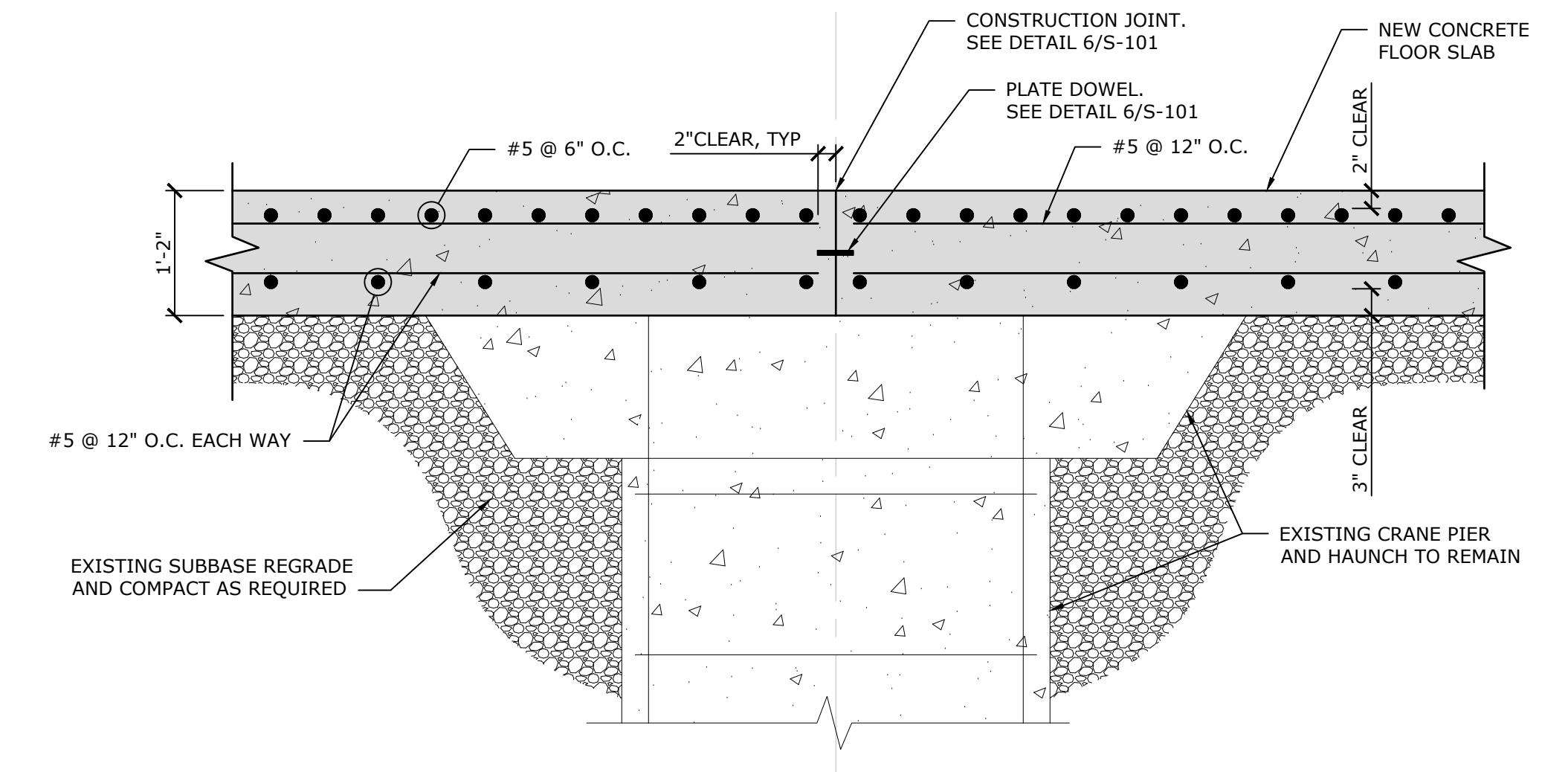

4
 S-101
SECTION AT CRANE PIER
 SCALE: 3/4" = 1'-0"
 CROSS REFERENCE: 1/S-101

DATE	REVISIONS RECORD/DESCRIPTION	DRAFTER	CHECK	APPR.

**TIPPING FLOOR CONCRETE SLAB REPLACEMENT
 NEW SLAB PLAN & DETAILS**

**MONTGOMERY COUNTY AMSTERDAM TRANSFER STATION
 1247 STATE ROUTE 5S, AMSTERDAM, NY 12010**

TOWN OF AMSTERDAM MONTGOMERY COUNTY, NEW YORK

C.T. MALE ASSOCIATES
 Engineering, Surveying, Architecture, Landscape Architecture & Geology, D.P.C.
 50 CENTURY HILL DRIVE, LATHAM, NY 12110 PH: 518.786.7400
 GLENS FALLS, NY • Poughkeepsie, NY • JOHNSTOWN, NY
 RED HOOK, NY • SYRACUSE, NY
 www.ctmale.com

S-101
 SHEET 03 OF 03
 DWG. NO: 23-0318

CAD DWG. FILE NAME: k:\Projects\222793\Civil\Drawings-maps\S-101.dwg