

October 2020



Asbestos Containing Material Survey

1 Venner Road
City of Amsterdam
Montgomery County, New York

Prepared for:

Mr. Eric Mead
Montgomery County Public Works Commissioner
6 Park Street
P.O. Box 1500
Fonda, NY 12068-1500

Prepared by:

C.T. MALE ASSOCIATES
50 Century Hill Drive
Latham, New York 12110
518-786-7400
FAX 518-786-7299

C.T. Male Project No: 20.0649

ASBESTOS CONTAINING MATERIAL SURVEY

1 Venner Road
Amsterdam, NY

TABLE OF CONTENTS

	<u>Page</u>
1.0 INTRODUCTION	1
2.0 SITE VISIT - ASBESTOS CONTAINING MATERIALS	2
3.0 SAMPLING AND LABORATORY ANALYSIS	4
4.0 CONCLUSIONS AND RECOMMENDATIONS	16

TABLES

TABLE 3.0 BULK SAMPLE ANALYSIS RESULTS

APPENDICES

APPENDIX A C.T. MALE ASSOCIATES CERTIFICATIONS

APPENDIX B LABORATORY CERTIFICATIONS

APPENDIX C ACM ANALYSIS RESULTS & CHAIN OF CUSTODY

APPENDIX D BUILDING PLAN

APPENDIX E ACM SURVEY ABATEMENT COST ESTIMATES

1.0 INTRODUCTION

This report presents the findings of an asbestos containing material (ACM) survey of the former Amsterdam Recorder building located at 1 Venner Road in Amsterdam, New York. The building is a two-story brick structure constructed on a slab-on-grade foundation with flat roofs.

The purpose of this report was to determine whether there are asbestos containing materials in the structure prior to renovation activities. The survey included identification of suspect asbestos containing materials, quantification, and bulk sampling of suspect asbestos containing materials. Laboratory analysis was performed to determine the presence and type of asbestos in sampled materials. Any material is considered asbestos containing if it contains one percent, or more, asbestos by weight.

What is known as “destructive” inspection and sampling techniques may have been used when necessary. Destructive techniques are used, where appropriate, to look behind walls, above ceilings, and under floors to access any piping, sub-structures or miscellaneous materials that may exist.

C.T. Male Associates (C.T. Male) personnel conducted this ACM survey. C.T. Male possesses EPA accreditation and asbestos certification, as required by the New York State Department of Labor, as Inspectors for asbestos.

2.0 SITE VISIT - ASBESTOS CONTAINING MATERIALS

C.T. Male personnel visited the site on September 30, 2020.

A walk through of the subject areas was conducted during which suspect asbestos containing materials were identified. Three major categories of suspect materials are categorized during asbestos inspections: Surfacing Materials, Thermal System Insulation (TSI) and Miscellaneous Materials. These categories are described below:

Surfacing Material - Materials that are sprayed-on, trowelled-on or otherwise applied to surfaces. Examples include acoustical plaster on ceilings and/or walls, fireproofing materials on structural members, or decorative applications.

Thermal System Insulation - Materials, usually found on piping, fittings, boilers, tanks, ducts or other mechanical components to prevent heat loss or gain.

Miscellaneous ACM - Any other materials including, but not limited to, floor and ceiling tiles, gaskets, felts, paper products, etc. that are neither surfacing materials nor thermal system insulation.

During the course of the site visit, suspect materials of similar type, texture and appearance are grouped together and considered homogeneous. Each homogeneous material is quantified and, depending on overall quantity as well as the locations of the material throughout the site, an appropriate number of bulk samples were secured.

Suspect Materials Located

Plasters	Drywall
Taping Compound	1'x1' Ceiling Tile
1'x2' Ceiling Tile	2'x2' Ceiling Tile
2'x4' Ceiling Tile	Wall Panel Adhesive
Ceramic Floor Tile Set	Ceramic Floor Tile Grout
Ceramic Wall Tile Adhesive	Ceramic Wall Tile Grout
Floor Tile Mastic	9"x9" Floor Tile
Floor Tile Adhesive	12"x12" Floor Tile
12"x12" Floor Tile (thin)	Self-Adhesive Floor Tile
1'x2' Self-Adhesive Floor Tile	Faux Wood Flooring
Carpet Adhesive	Cove Base Adhesive
4" Cove Base	Fire Door Insulation
Fitting Insulation	Duct Insulation

Suspect Materials Located (continued)

Boiler Breeching Insulation

Duct Vibration Joint Cloth

Door Window Glazing Compound

Window Caulk

Tank Insulation

Window Glazing Compound

Door Caulk

3.0 SAMPLING AND LABORATORY ANALYSIS

C.T. Male's representative collected eighty (80) bulk samples during the site-visit. The samples were analyzed using Polarized Light Microscopy (PLM). Non-friable organically bound materials were analyzed using the Matrix Reduction Method in conjunction with PLM based on the New York State Department of Health Environmental Laboratory Approval Program recommendations. Any negative sample analysis results by this method are then analyzed further by Transmission Electron Microscopy (TEM). Non-friable organically bound materials are bound by cements or adhesives. Examples include floor tile, floor tile mastic and sheet floor covering. AmeriSci New York of New York, NY performed analysis of the bulk samples by PLM or TEM. Table 3.0 provides a summary of analysis results.

TABLE 3.0
BULK SAMPLE ANALYSIS RESULTS

<u>Sample Location</u>	<u>% ASBESTOS BY WEIGHT</u>	<u>TYPE OF ASBESTOS</u>
093020SP01 1 st Floor Lobby Closet (3) Plaster (scratch coat)	NA	NAD
093020SP02 1 st Floor Editorial Area (18) Plaster (scratch coat)	NA	NAD
093020SP03 1 st Floor Editorial Area Storage (23) Plaster (scratch coat)	NA	NAD

NA = Not Applicable

NAD = No Asbestos Detected

C.T. MALE ASSOCIATES

<u>Sample Location</u>	<u>% ASBESTOS BY WEIGHT</u>	<u>TYPE OF ASBESTOS</u>
093020SP04 1 st Floor Publisher Closet (33) Plaster (scratch coat)	NA	NAD
093020SP05 1 st Floor General Manager Closet (36) Plaster (scratch coat)	NA	NAD
093020SP06 1 st Floor Lobby Closet (3) Plaster (finish coat)	NA	NAD
093020SP07 1 st Floor Editorial Area (18) Plaster (finish coat)	NA	NAD
093020SP08 1 st Floor Editorial Area Storage (23) Plaster (finish coat)	NA	NAD
093020SP09 1 st Floor Publisher Closet (33) Plaster (finish coat)	NA	NAD
093020SP10 1 st Floor General Manager Closet (36) Plaster (finish coat)	NA	NAD

NA = Not Applicable

NAD = No Asbestos Detected

C.T. MALE ASSOCIATES

<u>Sample Location</u>	<u>% ASBESTOS BY WEIGHT</u>	<u>TYPE OF ASBESTOS</u>
093020SP11 1 st Floor Lunch & Assembly Room (7) Drywall	NA	NAD
093020SP12 1 st Floor Camera (81) Drywall	NA	NAD
093020SP13 1 st Floor Lunch & Assembly Room (7) Taping Compound	NA	NAD
093020SP14 1 st Floor Camera (81) Taping Compound	NA	NAD
093020SP15 1 st Floor Machine Shop (9) 1'x1' Metal Faced Ceiling Tile	NA	NAD
093020SP16 1 st Floor Men's Locker Room (62) 1'x1' Metal Faced Ceiling Tile	NA	NAD
093020SP17 1 st Floor Publisher (32) 1'x1' Z-Spline Ceiling Tile	NA	NAD

NA = Not Applicable

NAD = No Asbestos Detected

C.T. MALE ASSOCIATES

<u>Sample Location</u>	<u>% ASBESTOS BY WEIGHT</u>	<u>TYPE OF ASBESTOS</u>
093020SP18 1 st Floor Publisher (32) 1'x1' Z-Spline Ceiling Tile	NA	NAD
093020SP19 1 st Floor Studio (28) 1'x2' Z-Spline Ceiling Tile	NA	NAD
093020SP20 1 st Floor Advertising Storage (57) 1'x2' Z-Spline Ceiling Tile	NA	NAD
093020SP21 1 st Floor Waiting Room (37) 2'x2' Z-Spline Ceiling Tile	NA	NAD
093020SP22 1 st Floor General Manager (38) 2'x2' Z-Spline Ceiling Tile	NA	NAD
093020SP23 1 st Floor Lunch & Assembly Room (7) 2'x4' Ceiling Tile	NA	NAD
093020SP24 1 st Floor Composing Area - Network Room (64) 2'x4' Ceiling Tile	NA	NAD

NA = Not Applicable

NAD = No Asbestos Detected

C.T. MALE ASSOCIATES

<u>Sample Location</u>	<u>% ASBESTOS BY WEIGHT</u>	<u>TYPE OF ASBESTOS</u>
093020SP25 1 st Floor Business Manager (39) Wall Panel Adhesive	4.0%	Chrysotile
093020SP26 1 st Floor Business Manager (39) Wall Panel Adhesive	Not Analyzed	Positive Stop
093020SP27 1 st Floor Women's Toilet (12) Ceramic Floor Tile Set	NA	NAD
093020SP28 1 st Floor Passage (59) Ceramic Floor Tile Set	NA	NAD
093020SP29 1 st Floor Women's Toilet (12) Ceramic Floor Tile Grout	NA	NAD
093020SP30 1 st Floor Passage (59) Ceramic Floor Tile Grout	NA	NAD
093020SP31 1 st Floor Women's Toilet (12) Ceramic Wall Tile Adhesive	NA	NAD

NA = Not Applicable

NAD = No Asbestos Detected

C.T. MALE ASSOCIATES

<u>Sample Location</u>	<u>% ASBESTOS BY WEIGHT</u>	<u>TYPE OF ASBESTOS</u>
093020SP32 1 st Floor Women's Toilet (12) Ceramic Wall Tile Adhesive	NA	NAD
093020SP33 1 st Floor Women's Toilet (12) Ceramic Wall Tile Grout	NA	NAD
093020SP34 1 st Floor Women's Toilet (12) Ceramic Wall Tile Grout	NA	NAD
093020SP35 1 st Floor Storage (49) Floor Tile Mastic (black)	2.7%	Chrysotile
093020SP36 1 st Floor Storage (49) Floor Tile Mastic (black)	Not Analyzed	Positive Stop
093020SP37 1 st Floor Storage (49) 9"x9" Floor Tile	5.7%	Chrysotile
093020SP38 1 st Floor Storage (49) 9"x9" Floor Tile	Not Analyzed	Positive Stop

NA = Not Applicable

NAD = No Asbestos Detected

C.T. MALE ASSOCIATES

<u>Sample Location</u>	<u>% ASBESTOS BY WEIGHT</u>	<u>TYPE OF ASBESTOS</u>
093020SP39 1 st Floor Lunch & Assembly Room (7) Floor Tile Adhesive (yellow)	NA	NAD
093020SP40 1 st Floor Proofreading Room (21) Floor Tile Adhesive (yellow)	NA	NAD
093020SP41 1 st Floor Lunch & Assembly Room (7) 12"x12" Floor Tile	NA	NAD
093020SP42 1 st Floor Plate Room (79) 12"x12" Floor Tile	NA	NAD
093020SP43 1 st Floor Proof Room (21) 12"x12" Floor Tile (thin)	4.9%	Chrysotile
093020SP44 1 st Floor Proof Room (21) 12"x12" Floor Tile (thin)	Not Analyzed	Positive Stop
093020SP45 1 st Floor Storage Room (5) Self-Adhesive Floor Tile (gray)	NA	NAD

NA = Not Applicable

NAD = No Asbestos Detected

C.T. MALE ASSOCIATES

<u>Sample Location</u>	<u>% ASBESTOS BY WEIGHT</u>	<u>TYPE OF ASBESTOS</u>
093020SP46 1 st Floor Storage Room (5) Self-Adhesive Floor Tile (gray)	NA	NAD
093020SP47 1 st Floor Storage Room (5) 1'x2' Self-Adhesive Floor Tile	NA	NAD
093020SP48 1 st Floor Storage Room (5) 1'x2' Self-Adhesive Floor Tile	NA	NAD
093020SP49 1 st Floor Publisher (32) Faux Wood Flooring	NA	NAD
093020SP50 1 st Floor Publisher (32) Faux Wood Flooring	NA	NAD
093020SP51 1 st Floor Publisher Closet (33) Carpet Adhesive	NA	NAD
093020SP52 1 st Floor Advertising Passage (56) Carpet Adhesive	NA	NAD

NA = Not Applicable

NAD = No Asbestos Detected

C.T. MALE ASSOCIATES

<u>Sample Location</u>	<u>% ASBESTOS BY WEIGHT</u>	<u>TYPE OF ASBESTOS</u>
093020SP53 1 st Floor Publisher Closet (33) Cove Base Adhesive	NA	NAD
093020SP54 1 st Floor Business Manager (39) Cove Base Adhesive	NA	NAD
093020SP55 1 st Floor Publisher Closet (33) 4" Cove Base	NA	NAD
093020SP56 1 st Floor Business Manager (39) 4" Cove Base	NA	NAD
093020SP57 1 st Floor Press Room (65) (stored door) Fire Door Insulation	2.3% 3.8%	Chrysotile Amosite
093020SP58 1 st Floor Press Room (65) (stored door) Fire Door Insulation	Not Analyzed	Positive Stop
093020SP59 1 st Floor Business Manager (39) (above ceiling) Fitting Insulation	3.0%	Chrysotile

NA = Not Applicable

NAD = No Asbestos Detected

C.T. MALE ASSOCIATES

<u>Sample Location</u>	<u>% ASBESTOS BY WEIGHT</u>	<u>TYPE OF ASBESTOS</u>
093020SP60 1 st Floor Men's Locker Room (62) (above ceiling) Fitting Insulation	Not Analyzed	Positive Stop
093020SP61 1 st Floor Development Room (80) (above ceiling) Fitting Insulation	Not Analyzed	Positive Stop
093020SP62 1 st Floor Press Room (65) Duct Insulation	23.5%	Chrysotile
093020SP63 1 st Floor Press Room (65) Duct Insulation	Not Analyzed	Positive Stop
093020SP64 1 st Floor Press Room (65) Duct Insulation	Not Analyzed	Positive Stop
093020SP65 1 st Floor Boiler Room (70) Boiler Breeching Insulation	30.8%	Chrysotile
093020SP66 1 st Floor Boiler Room (70) Boiler Breeching Insulation	Not Analyzed	Positive Stop

NA = Not Applicable

NAD = No Asbestos Detected

C.T. MALE ASSOCIATES

<u>Sample Location</u>	<u>% ASBESTOS BY WEIGHT</u>	<u>TYPE OF ASBESTOS</u>
093020SP67 1 st Floor Boiler Room (70) Boiler Breeching Insulation	Not Analyzed	Positive Stop
093020SP68 1 st Floor Boiler Room (70) Tank Insulation	3.5%	Chrysotile
093020SP69 1 st Floor Boiler Room (70) Tank Insulation	Not Analyzed	Positive Stop
093020SP70 1 st Floor Boiler Room (70) Tank Insulation	Not Analyzed	Positive Stop
093020SP71 1 st Floor Entry Vestibule (1) Duct Vibration Cloth	80.0%	Chrysotile
093020SP72 1 st Floor Entry Vestibule (1) Duct Vibration Cloth	Not Analyzed	Positive Stop
093020SP73 1 st Floor Lunch & Assembly Room (7) (interior) Window Glazing Compound	<1.0%	Chrysotile

NA = Not Applicable

NAD = No Asbestos Detected

C.T. MALE ASSOCIATES

<u>Sample Location</u>	<u>% ASBESTOS BY WEIGHT</u>	<u>TYPE OF ASBESTOS</u>
093020SP74 1 st Floor Publisher (32) (interior) Window Glazing Compound	<1.0%	Chrysotile
093020SP75 1 st Floor Passage (30) Door Window Glazing Compound	NA	NAD
093020SP76 1 st Floor Machine Room (9) Door Window Glazing Compound	<1.0%	Chrysotile
093020SP77 Exterior Entry Vestibule (1) Door Caulk	NA	NAD
093020SP78 Exterior Entry Vestibule (1) Door Caulk	NA	NAD
093020SP79 Exterior Front of Building Window Caulk	NA	NAD
093020SP80 Exterior Front of Building Window Caulk	NA	NAD

NA = Not Applicable

NAD = No Asbestos Detected

4.0 CONCLUSIONS AND RECOMMENDATIONS

Based upon observations during the inspection and the laboratory analysis results, the following asbestos containing materials were located.

<u>Location</u>	<u>ACM Located</u>	<u>Quantity</u>	<u>Friable/Condition</u>
Throughout			
Fire Doors*	Fire Door Insulation	30 Ea.	Friable/Intact
Throughout			
Behind Metal Radiator Covers**	Fitting Insulation	Unknown	Friable/Unknown
1st Floor			
Vestibule (1)			
Above Ceiling	Fitting Insulation	15 Ln. Ft.	Friable/Intact
	Duct Vibration Joint Cloth	10 Sq. Ft.	Friable/Intact
Lobby (2)			
Throughout	Wall Panel Adhesive	320 Sq. Ft.	Non-Friable/Intact
Circulation (4)			
Throughout	Wall Panel Adhesive	80 Sq. Ft.	Non-Friable/Intact
Storage Room (5)			
Above Ceiling***	Fitting Insulation (no access above ceiling)	Unknown	Friable/Unknown
Throughout	Floor Tile & Mastic (under 2 layers non-ACM tile)	120 Sq. Ft.	Non-Friable/Intact
Men's Toilet (6)			
Above Ceiling/In Walls***	Fitting Insulation (no access above ceiling, behind walls)	Unknown	Friable/Unknown

C.T. MALE ASSOCIATES

<u>Location</u>	<u>ACM Located</u>	<u>Quantity</u>	<u>Friable/Condition</u>
1st Floor			
Lunch & Assembly Rm. (7)			
Office Area			
Above Ceiling	Fitting Insulation	8 Ln. Ft.	Friable/Intact
Lunch & Assembly Rm. (7)			
Break Area			
Above Ceiling***	Fitting Insulation (no access above ceiling)	Unknown	Friable/Unknown
Lunch & Assembly Rm. (7)			
Corridor			
Above Ceiling***	Fitting Insulation (no access above ceiling)	Unknown	Friable/Unknown
Machine Shop (9)			
Throughout	Floor Tile & Mastic	144 Sq. Ft.	Non-Friable/Intact
Storage (10)			
Throughout	Floor Tile & Mastic	96 Sq. Ft.	Non-Friable/Intact
Women's Toilet (12)			
Above Ceiling/In Walls***	Fitting Insulation (no access above ceiling)	Unknown	Friable/Unknown
Women's Restroom (13)			
Above Ceiling***	Fitting Insulation (no access above ceiling)	Unknown	Friable/Unknown
Vault (14)			
Throughout	Floor Tile & Mastic	80 Sq. Ft.	Non-Friable/Intact
Men's Toilet (15)			
Above Ceiling/In Walls	Fitting Insulation	16 Ln. Ft.	Friable/Intact

C.T. MALE ASSOCIATES

<u>Location</u>	<u>ACM Located</u>	<u>Quantity</u>	<u>Friable/Condition</u>
1st Floor			
Editorial (18)			
Above Ceiling	Fitting Insulation	25 Ln. Ft.	Friable/Intact
Proofreading (21)			
Throughout	Floor Tile – Not Mastic (under carpet)	96 Sq. Ft.	Non-Friable/Intact
Storage (23)			
Throughout	Floor Tile & Mastic	96 Sq. Ft.	Non-Friable/Intact
Storage (24)			
Throughout	Floor Tile & Mastic	144 Sq. Ft.	Non-Friable/Intact
Photo Area/Dark Room (25-26)			
Above Ceiling	Fitting Insulation	5 Ln. Ft.	Friable/Intact
Throughout	Floor Tile Mastic (no tile, under carpet)	306 Sq. Ft.	Non-Friable/Intact
Editorial Manager (27)			
Above Ceiling	Fitting Insulation	7 Ln. Ft.	Friable/Intact
Conference (29)			
Above Ceiling	Fitting Insulation	8 Ln. Ft.	Friable/Intact
Publisher (32)			
Above Ceiling***	Fitting Insulation (no access above ceiling)	Unknown	Friable/Unknown
Throughout	Wall Panel Adhesive	608 Sq. Ft.	Non-Friable/Intact
General Manager Toilet (34)			
Above Ceiling/In Walls	Fitting Insulation	4 Ln. Ft.	Friable/Intact

C.T. MALE ASSOCIATES

<u>Location</u>	<u>ACM Located</u>	<u>Quantity</u>	<u>Friable/Condition</u>
1st Floor			
Publisher Toilet (35)			
Above Ceiling/In Walls	Fitting Insulation	4 Ln. Ft.	Friable/Intact
General Manager (38)			
Above Ceiling	Fitting Insulation	5 Ln. Ft.	Friable/Intact
Throughout	Wall Panel Adhesive	136 Sq. Ft.	Non-Friable/Intact
Business Manager (39)			
Above Ceiling	Fitting Insulation	12 Ln. Ft.	Friable/Damaged
	Fitting Insulation Debris	8 Sq. Ft.	Friable/Damaged
Throughout	Wall Panel Adhesive	136 Sq. Ft.	Non-Friable/Intact
Supplies (43)			
Throughout	Floor Tile & Mastic	72 Sq. Ft.	Non-Friable/Intact
Business/Business Machine Room (45-46)			
Above Ceiling	Fitting Insulation	4 Ln. Ft.	Friable/Intact
Throughout	Wall Panel Adhesive	216 Sq. Ft.	Non-Friable/Intact
Storage (49)			
Throughout	Floor Tile & Mastic	72 Sq. Ft.	Non-Friable/Intact
Classified Advertising (50)			
Throughout	Wall Panel Adhesive	224 Sq. Ft.	Non-Friable/Intact
Layout (52)			
Above Ceiling	Fitting Insulation	2 Ln. Ft.	Friable/Intact
Advertising (53)			
Above Ceiling	Fitting Insulation	14 Ln. Ft.	Friable/Damaged
	Fitting Insulation Debris	12 Sq. Ft.	Friable/Damaged
Throughout	Wall Panel Adhesive	304 Sq. Ft.	Non-Friable/Intact

C.T. MALE ASSOCIATES

<u>Location</u>	<u>ACM Located</u>	<u>Quantity</u>	<u>Friable/Condition</u>
1st Floor			
Advertising Manager (54)			
Above Ceiling	Fitting Insulation	4 Ln. Ft.	Friable/Intact
Closet/Passage (55-56)			
Above Ceiling	Fitting Insulation	3 Ln. Ft.	Friable/Intact
Storage Room (57)			
Above Ceiling	Fitting Insulation	10 Ln. Ft.	Friable/Damaged
	Fitting Insulation Debris	2 Sq. Ft.	Friable/Damaged
Below Ceiling	Fitting Insulation	1 Ln. Ft.	Friable/Intact
Throughout	Floor Tile & Mastic	108 Sq. Ft.	Non-Friable/Intact
Passage (59)			
Above Ceiling	Fitting Insulation	1 Ln. Ft.	Friable/Intact
	Roof Drain Insulation	2 Sq. Ft.	Friable/Intact
Showers (60)			
Above Ceiling/In Walls	Fitting Insulation	8 Ln. Ft.	Friable/Damaged
	Fitting Insulation Debris	12 Sq. Ft.	Friable/Damaged
PBX - Telephone Equipment Room (61)			
Throughout	Floor Tile & Mastic	90 Sq. Ft.	Non-Friable/Intact
Locker Room (62)			
Above Ceiling	Fitting Insulation	10 Ln. Ft.	Friable/Damaged
	Fitting Insulation Debris	12 Sq. Ft.	Friable/Damaged
Toilet (63)			
Above Ceiling/In Walls	Fitting Insulation	16 Ln. Ft.	Friable/Damaged
	Fitting Insulation Debris	12 Sq. Ft.	Friable/Damaged

C.T. MALE ASSOCIATES

<u>Location</u>	<u>ACM Located</u>	<u>Quantity</u>	<u>Friable/Condition</u>
1st Floor			
Composing Area (64)			
Area Built Out into 9 Rooms & 2 Closets			
Above Ceiling	Fitting Insulation	40 Ln. Ft.	Friable/Intact
Throughout	Floor Tile & Mastic	2,925 Sq. Ft.	Non-Friable/Intact
	(1,460 Sq. Ft. under carpet, 300 Sq. Ft. under raised floor)		
Press Room (65)			
Throughout	Fitting Insulation	20 Ln. Ft.	Friable/Intact
	Duct Insulation	65 Ln. Ft.	Friable/Damaged
Toilet (67)			
Above Ceiling/In Walls	Fitting Insulation	12 Ln. Ft.	Friable/Intact
Storage (68)			
Throughout	Fitting Insulation	11 Ln. Ft.	Friable/Intact
Boiler Room (70)			
Throughout	Fitting Insulation	75 Ln. Ft.	Friable/Damaged
	Breeching Insulation	80 Sq. Ft.	Friable/Damaged
	Tank Insulation	100 Sq. Ft.	Friable/Damaged
	Tank Insulation Debris	4 Sq. Ft.	Friable/Damaged
Toilet (74)			
Above Ceiling/In Walls	Fitting Insulation	10 Ln. Ft.	Friable/Damaged
	Fitting Insulation Debris	12 Sq. Ft.	Friable/Damaged
Delivery & Mail (75)			
Throughout	Fitting Insulation	4 Ln. Ft.	Friable/Intact
Truck Port (76)			
Throughout	Fitting Insulation	20 Ln. Ft.	Friable/Damaged

C.T. MALE ASSOCIATES

<u>Location</u>	<u>ACM Located</u>	<u>Quantity</u>	<u>Friable/Condition</u>
1st Floor			
Maintenance Shop (77)			
Throughout	Fitting Insulation	8 Ln. Ft.	Friable/Intact
Roll Storage (78)			
Throughout	Fitting Insulation	30 Ln. Ft.	Friable/Intact
	Roof Drain Insulation	2 Sq. Ft.	Friable/Intact
Plate Room/Development Room/Camera (79-80-81)			
Above Ceiling	Fitting Insulation	15 Ln. Ft.	Friable/Damaged
	Fitting Insulation Debris	8 Sq. Ft.	Friable/Damaged
Throughout	Floor Tile & Mastic	624 Sq. Ft.	Non-Friable/Intact
Mezzanine			
Mechanical Room			
Throughout	Fitting Insulation	90 Ln. Ft.	Friable/Damaged
	Fitting Insulation Debris	10 Sq. Ft.	Friable/Damaged
	Duct Vibration Joint Cloth	24 Sq. Ft.	Friable/Intact
2nd Floor			
Mechanical Room			
Throughout	Fitting Insulation	90 Ln. Ft.	Friable/Intact
	Roof Drain Insulation	2 Sq. Ft.	Friable/Intact
	Tank Insulation	50 Sq. Ft.	Friable/Intact
Apartment			
Kitchen/Bath			
In Walls***	Fitting Insulation (no access within walls)	Unknown	Friable/Unknown
Throughout	Floor Tile & Mastic (196 Sq. Ft. under carpet)	750 Sq. Ft.	Non-Friable/Intact
Living Room	Wall Panel Adhesive	448 Sq. Ft.	Non-Friable/Intact

*Analysis of fire door insulation confirmed asbestos concentration >1.0%. Therefore asbestos containing door insulation is assumed to be present in all fire doors.

**Due to the limited visibility behind the metal radiator covers throughout the building asbestos containing fitting insulation is assumed to be present at these locations.

***Plaster, drywall, and/or z-spline ceilings prevented access to areas behind walls and/or above ceilings at multiple locations indicated above and asbestos containing fitting insulation is assumed to be present within these cavities.

NOTE: All quantities are approximate. Abatement contractor will need to verify quantities prior to bid production. This survey report is not, in and of itself, an asbestos abatement design document, but can be used as a part of the overall abatement design.

Per the regulatory requirements of the National Emissions Standards for Hazardous Air Pollutants (40 CFR 61), all asbestos containing materials must be removed from a structure prior to its demolition. New York State requires that if a facility is found to have asbestos containing materials, NYS Industrial Code Rule 56 (12 NYCRR Part 56) must be followed when performing any work which might disturb the asbestos containing materials. Any disturbance of asbestos containing materials, including removal, repair, encapsulation, enclosure, etc. must be conducted by trained individuals with valid asbestos certification, and in accordance with federal, state and local regulations.

C.T. Male recommends that the asbestos containing materials be removed prior to renovation or demolition activities by a New York State Licensed Asbestos Abatement Contractor, in accordance with 12 NYCRR Part 56 (Code Rule 56), OSHA 29 CFR 1926.58 and USEPA 40 CFR Part 61, Subpart M (NESHAPS).

Per the requirements of NYSDOL Industrial Code Rule 56 (as amended January 12, 2006), the building owner shall transmit copies of this inspection pre-renovation report to 1) the local agency charged with issuing the building demolition/renovation permit; 2) the local Asbestos Control Bureau Office (Albany District, State Office Campus,

C.T. MALE ASSOCIATES

Building 12 Room 157, Albany, New York 12240); and 3) as required, this report is to be kept on site during any abatement activities and/or demolition, renovation, remodeling or repair activities.

If you have any questions regarding this report, please contact this office at (518) 786-7400.

Respectfully submitted,

C.T. MALE ASSOCIATES

A handwritten signature in dark ink, appearing to read "Michael F. Sawyer", followed by a long horizontal flourish.

Michael F. Sawyer

Managing Industrial Hygienist

NYSDOL License #AH-88-06552 (PM, AST, Inspector and Designer)

APPENDIX A

**C.T. MALE ASSOCIATES
CERTIFICATIONS**

New York State – Department of Labor

Division of Safety and Health
License and Certificate Unit
State Campus, Building 12
Albany, NY 12240

ASBESTOS HANDLING LICENSE

C.T. Male Associates Engineering, Surveying,
Architecture & Landscape Architecture & Geology,
D.P.C.

50 Century Hill Drive

Latham, NY 12110

FILE NUMBER: 99-0722

LICENSE NUMBER: 29050

LICENSE CLASS: RESTRICTED

DATE OF ISSUE: 10/17/2019

EXPIRATION DATE: 10/31/2020

Duly Authorized Representative – Daniel Reilly:

This license has been issued in accordance with applicable provisions of Article 30 of the Labor Law of New York State and of the New York State Codes, Rules and Regulations (12 NYCRR Part 56). It is subject to suspension or revocation for a (1) serious violation of state, federal or local laws with regard to the conduct of an asbestos project, or (2) demonstrated lack of responsibility in the conduct of any job involving asbestos or asbestos material.

This license is valid only for the contractor named above and this license or a photocopy must be prominently displayed at the asbestos project worksite. This license verifies that all persons employed by the licensee on an asbestos project in New York State have been issued an Asbestos Certificate, appropriate for the type of work they perform, by the New York State Department of Labor.



Eileen M. Franko, Director
For the Commissioner of Labor

C.T. MALE ASSOCIATES

CERTIFICATIONS

C.T. Male's Asbestos Contractor's License:

License Number:	29050
Expiration Date:	10-31-2020

Michael F. Sawyer

NYSDOL Asbestos	
Certificate Number:	AH88-06552
Inspector:	09-20
Project Designer:	09-20
OSHA 40-HR Certified	

Stephen Pierson

NYSDOL Asbestos	
Certificate Number:	AH08-07760
Inspector:	03-21
Project Designer:	03-21

STATE OF NEW YORK - DEPARTMENT OF LABOR
ASBESTOS CERTIFICATE



MICHAEL F SAWYER

CLASS(EXPIRES)

C ATEC(09/20) D INSP(09/20)

E MGPL(09/20) H PM (09/20)

I PD (09/20)

CERT# 88-06552

DMV# 437658014

MUST BE CARRIED ON ASBESTOS PROJECTS



STATE OF NEW YORK - DEPARTMENT OF LABOR
ASBESTOS CERTIFICATE



STEPHEN D PIERSON

CLASS(EXPIRES)

C ATEC(03/21) D INSP(03/21)

H PM (03/21) I PD (03/21)

CERT# 08-07760
DMV# 251759072

MUST BE CARRIED ON ASBESTOS PROJECTS

REPRODUCTION OF THIS CARD IS PROHIBITED

APPENDIX B

LABORATORY CERTIFICATIONS

**NEW YORK STATE DEPARTMENT OF HEALTH
WADSWORTH CENTER**



Expires 12:01 AM April 01, 2022
Issued April 01, 2020

CERTIFICATE OF APPROVAL FOR LABORATORY SERVICE

Issued in accordance with and pursuant to section 502 Public Health Law of New York State

**MR. PAUL J. MUCHA
AMERICA SCIENCE TEAM NEW YORK, INC
117 EAST 30TH ST
NEW YORK, NY 10016**

NY Lab Id No: 11480

*is hereby APPROVED as an Environmental Laboratory for the category
ENVIRONMENTAL ANALYSES SOLID AND HAZARDOUS WASTE
All approved subcategories and/or analytes are listed below:*

Miscellaneous

Asbestos in Friable Material	Item 198.1 of Manual EPA 600/M4/82/020
Asbestos in Non-Friable Material-PLM	Item 198.6 of Manual (NOB by PLM)
Asbestos in Non-Friable Material-TEM	Item 198.4 of Manual

Serial No.: 61903

Property of the New York State Department of Health. Certificates are valid only at the address shown, must be conspicuously posted, and are printed on secure paper. Continued accreditation depends on successful ongoing participation in the Program. Consumers are urged to call (518) 485-5570 to verify the laboratory's accreditation status.

APPENDIX C

**LABORATORY ANALYSIS REPORTS &
CHAIN OF CUSTODY**

**AmeriSci New York**117 EAST 30TH ST.
NEW YORK, NY 10016

TEL: (212) 679-8600 • FAX: (212) 679-3114

PLM Bulk Asbestos ReportC. T. Male & Associates
Attn: Michael Sawyer
50 Century Hill Drive
P.O. Box 727
Latham, NY 12110**Date Received** 10/02/20 **AmeriSci Job #** 220101196
Date Examined 10/03/20 **P.O. #**
ELAP # 11480 **Page** 1 **of** 14
RE: 18.8318; 1 Venner Road; Amsterdam, NY

Client No. / HGA	Lab No.	Asbestos Present	Total % Asbestos
093020SP01 1	220101196-01 Location: 1st Fl. / Lobby Closet (3) - Plaster (Scratch Coat)	No	NAD ¹ (by NYS ELAP 198.1) by Jared C. Clarke on 10/03/20
Analyst Description: Grey, Homogeneous, Non-Fibrous, Cementitious, Bulk Material Asbestos Types: Other Material: Non-fibrous 100 %			
093020SP02 1	220101196-02 Location: 1st Fl. / Editorial Area (18) - Plaster (Scratch Coat)	No	NAD (by NYS ELAP 198.1) by Jared C. Clarke on 10/04/20
Analyst Description: Grey, Homogeneous, Non-Fibrous, Cementitious, Bulk Material Asbestos Types: Other Material: Non-fibrous 100 %			
093020SP03 1	220101196-03 Location: 1st Fl. / Editorial Area Storage (23) - Plaster (Scratch Coat)	No	NAD (by NYS ELAP 198.1) by Jared C. Clarke on 10/04/20
Analyst Description: Grey, Homogeneous, Non-Fibrous, Cementitious, Bulk Material Asbestos Types: Other Material: Non-fibrous 100 %			
093020SP04 1	220101196-04 Location: 1st Fl. / Publisher Closet (33) - Plaster (Scratch Coat)	No	NAD (by NYS ELAP 198.1) by Jared C. Clarke on 10/04/20
Analyst Description: Grey, Homogeneous, Non-Fibrous, Cementitious, Bulk Material Asbestos Types: Other Material: Non-fibrous 100 %			
093020SP05 1	220101196-05 Location: 1st Fl. / General Manager Closet (36) - Plaster (Scratch Coat)	No	NAD (by NYS ELAP 198.1) by Jared C. Clarke on 10/04/20
Analyst Description: Grey, Homogeneous, Non-Fibrous, Cementitious, Bulk Material Asbestos Types: Other Material: Non-fibrous 100 %			

Client Name: C. T. Male & Associates

PLM Bulk Asbestos Report

18.8318; 1 Venner Road; Amsterdam, NY

Client No. / HGA	Lab No.	Asbestos Present	Total % Asbestos
093020SP06 2	220101196-06 Location: 1st Fl. / Lobby Closet (3) - Plaster (Finish Coat)	No	NAD (by NYS ELAP 198.1) by Jared C. Clarke on 10/04/20
Analyst Description: White, Homogeneous, Non-Fibrous, Bulk Material Asbestos Types: Other Material: Non-fibrous 100 %			
093020SP07 2	220101196-07 Location: 1st Fl. / Editorial Area (18) - Plaster (Finish Coat)	No	NAD (by NYS ELAP 198.1) by Jared C. Clarke on 10/04/20
Analyst Description: White, Homogeneous, Non-Fibrous, Bulk Material Asbestos Types: Other Material: Non-fibrous 100 %			
093020SP08 2	220101196-08 Location: 1st Fl. / Editorial Area Storage (23) - Plaster (Finish Coat)	No	NAD (by NYS ELAP 198.1) by Jared C. Clarke on 10/04/20
Analyst Description: White, Homogeneous, Non-Fibrous, Bulk Material Asbestos Types: Other Material: Non-fibrous 100 %			
093020SP09 2	220101196-09 Location: 1st Fl. / Publisher Closet (33) - Plaster (Finish Coat)	No	NAD (by NYS ELAP 198.1) by Jared C. Clarke on 10/04/20
Analyst Description: White, Homogeneous, Non-Fibrous, Bulk Material Asbestos Types: Other Material: Non-fibrous 100 %			
093020SP10 2	220101196-10 Location: 1st Fl. / General Manager Closet (36) - Plaster (Finish Coat)	No	NAD (by NYS ELAP 198.1) by Jared C. Clarke on 10/04/20
Analyst Description: White, Homogeneous, Non-Fibrous, Bulk Material Asbestos Types: Other Material: Non-fibrous 100 %			
093020SP11 3	220101196-11 Location: 1st Fl. / Lunch & Assembly Rm. (7) - Drywall	No	NAD (by NYS ELAP 198.1) by Jared C. Clarke on 10/04/20
Analyst Description: OffWhite, Homogeneous, Non-Fibrous, Bulk Material Asbestos Types: Other Material: Cellulose Trace, Non-fibrous 100 %			

Client Name: C. T. Male & Associates

PLM Bulk Asbestos Report

18.8318; 1 Venner Road; Amsterdam, NY

Client No. / HGA	Lab No.	Asbestos Present	Total % Asbestos
093020SP12 3	220101196-12 Location: 1st Fl. / Camera (81) - Drywall	No	NAD (by NYS ELAP 198.1) by Jared C. Clarke on 10/04/20
Analyst Description: OffWhite/Brown, Heterogeneous, Fibrous, Bulk Material Asbestos Types: Other Material: Cellulose 10 %, Non-fibrous 90 %			
093020SP13 4	220101196-13 Location: 1st Fl. / Lunch & Assembly Rm. (7) - Taping Compound	No	NAD (by NYS ELAP 198.1) by Jared C. Clarke on 10/04/20
Analyst Description: White, Homogeneous, Non-Fibrous, Bulk Material Asbestos Types: Other Material: Non-fibrous 100 %			
093020SP14 4	220101196-14 Location: 1st Fl. / Camera (81) - Taping Compound	No	NAD (by NYS ELAP 198.1) by Jared C. Clarke on 10/04/20
Analyst Description: White, Homogeneous, Non-Fibrous, Bulk Material Asbestos Types: Other Material: Non-fibrous 100 %			
093020SP15 5	220101196-15 Location: 1st Fl. / Machine Shop (9) - 1' x 1' Ceiling Tile (Metal Faced)	No	NAD (by NYS ELAP 198.6) by Jared C. Clarke on 10/04/20
Analyst Description: Grey, Homogeneous, Non-Fibrous, Bulk Material Asbestos Types: Other Material: Non-fibrous 60.3 %			
093020SP16 5	220101196-16 Location: 1st Fl. / Men's Locker Rm. (62) - 1' x 1' Ceiling Tile (Metal Faced)	No	NAD (by NYS ELAP 198.6) by Jared C. Clarke on 10/04/20
Analyst Description: Grey, Homogeneous, Non-Fibrous, Bulk Material Asbestos Types: Other Material: Non-fibrous 49.9 %			
093020SP17 6	220101196-17 Location: 1st Fl. / Publisher (32) - 1' x 1' Ceiling Tile (Z-Spline)	No	NAD (by NYS ELAP 198.6) by Jared C. Clarke on 10/04/20
Analyst Description: Grey, Homogeneous, Non-Fibrous, Bulk Material Asbestos Types: Other Material: Non-fibrous 11.3 %			

Client Name: C. T. Male & Associates

PLM Bulk Asbestos Report

18.8318; 1 Venner Road; Amsterdam, NY

Client No. / HGA	Lab No.	Asbestos Present	Total % Asbestos
093020SP18 6	220101196-18 Location: 1st Fl. / Publisher (32) - 1' x 1' Ceiling Tile (Z-Spline)	No	NAD (by NYS ELAP 198.6) by Jared C. Clarke on 10/04/20
Analyst Description: Grey, Homogeneous, Non-Fibrous, Bulk Material Asbestos Types: Other Material: Non-fibrous 16.4 %			
093020SP19 7	220101196-19 Location: 1st Fl. / Studio (28) - 1' x 2' Ceiling Tile (Z-Spline)	No	NAD (by NYS ELAP 198.6) by Jared C. Clarke on 10/04/20
Analyst Description: Grey, Homogeneous, Non-Fibrous, Bulk Material Asbestos Types: Other Material: Non-fibrous 13 %			
093020SP20 7	220101196-20 Location: 1st Fl. / Advertising Lounge (57) - 1' x 2' Ceiling Tile (Z-Spline)	No	NAD (by NYS ELAP 198.6) by Jared C. Clarke on 10/04/20
Analyst Description: Grey, Homogeneous, Non-Fibrous, Bulk Material Asbestos Types: Other Material: Non-fibrous 14.5 %			
093020SP21 8	220101196-21 Location: 1st Fl. / Waiting Rm. (37) - 2' x 2' Ceiling Tile (Z-Spline)	No	NAD (by NYS ELAP 198.6) by Jared C. Clarke on 10/04/20
Analyst Description: Grey, Homogeneous, Non-Fibrous, Bulk Material Asbestos Types: Other Material: Non-fibrous 17 %			
093020SP22 8	220101196-22 Location: 1st Fl. / General Manager (38) - 2' x 2' Ceiling Tile (Z-Spline)	No	NAD (by NYS ELAP 198.6) by Jared C. Clarke on 10/04/20
Analyst Description: Grey, Homogeneous, Non-Fibrous, Bulk Material Asbestos Types: Other Material: Non-fibrous 11.6 %			
093020SP23 9	220101196-23 Location: 1st Fl. / Lunch & Assembly Rm. (7) - 2' x 4' Ceiling Tile	No	NAD (by NYS ELAP 198.6) by Jared C. Clarke on 10/04/20
Analyst Description: Grey, Homogeneous, Non-Fibrous, Bulk Material Asbestos Types: Other Material: Non-fibrous 48.4 %			

Client Name: C. T. Male & Associates

PLM Bulk Asbestos Report

18.8318; 1 Venner Road; Amsterdam, NY

Client No. / HGA	Lab No.	Asbestos Present	Total % Asbestos
093020SP24 9	220101196-24 Location: 1st Fl. / Composing Area / Network Rm. (64) - 2' x 4' Ceiling Tile	No	NAD (by NYS ELAP 198.6) by Jared C. Clarke on 10/04/20
Analyst Description: Grey, Homogeneous, Non-Fibrous, Bulk Material Asbestos Types: Other Material: Non-fibrous 66.2 %			
093020SP25 10	220101196-25 Location: 1st Fl. / Business Manager (39) - Wall Panel Adhesive	Yes	4 % (by NYS ELAP 198.6) by Jared C. Clarke on 10/04/20
Analyst Description: Black, Homogeneous, Non-Fibrous, Bulk Material Asbestos Types: Chrysotile 4.0 % Other Material: Non-fibrous 14 %			
093020SP26 10	220101196-26 Location: 1st Fl. / Business Manager (39) - Wall Panel Adhesive		NA/PS
Analyst Description: Bulk Material Asbestos Types: Other Material:			
093020SP27 11	220101196-27 Location: 1st Fl. / Women's Toilet (12) - Ceramic Floor Set	No	NAD (by NYS ELAP 198.1) by Jared C. Clarke on 10/04/20
Analyst Description: Grey, Homogeneous, Non-Fibrous, Cementitious, Bulk Material Asbestos Types: Other Material: Non-fibrous 100 %			
093020SP28 11	220101196-28 Location: 1st Fl. / Passage (59) - Ceramic Floor Set	No	NAD (by NYS ELAP 198.1) by Jared C. Clarke on 10/04/20
Analyst Description: Grey, Homogeneous, Non-Fibrous, Cementitious, Bulk Material Asbestos Types: Other Material: Non-fibrous 100 %			
093020SP29 12	220101196-29 Location: 1st Fl. / Women's Toilet (12) - Ceramic Floor Grout	No	NAD (by NYS ELAP 198.1) by Jared C. Clarke on 10/04/20
Analyst Description: Grey, Homogeneous, Non-Fibrous, Cementitious, Bulk Material Asbestos Types: Other Material: Non-fibrous 100 %			

Client Name: C. T. Male & Associates

PLM Bulk Asbestos Report

18.8318; 1 Venner Road; Amsterdam, NY

Client No. / HGA	Lab No.	Asbestos Present	Total % Asbestos
093020SP30 12	220101196-30 Location: 1st Fl. / Passage (59) - Ceramic Floor Grout	No	NAD (by NYS ELAP 198.1) by Jared C. Clarke on 10/04/20
Analyst Description: Grey, Homogeneous, Non-Fibrous, Cementitious, Bulk Material Asbestos Types: Other Material: Non-fibrous 100 %			
093020SP31 13	220101196-31 Location: 1st Fl. / Women's Toilet (12) - Ceramic Wall Adhesive	No	NAD (by NYS ELAP 198.6) by Jared C. Clarke on 10/04/20
Analyst Description: White, Homogeneous, Non-Fibrous, Bulk Material Asbestos Types: Other Material: Non-fibrous 53.8 %			
093020SP32 13	220101196-32 Location: 1st Fl. / Women's Toilet (12) - Ceramic Wall Adhesive	No	NAD (by NYS ELAP 198.6) by Jared C. Clarke on 10/04/20
Analyst Description: White, Homogeneous, Non-Fibrous, Bulk Material Asbestos Types: Other Material: Non-fibrous 54 %			
093020SP33 14	220101196-33 Location: 1st Fl. / Women's Toilet (12) - Ceramic Wall Grout	No	NAD (by NYS ELAP 198.1) by Jared C. Clarke on 10/04/20
Analyst Description: White, Homogeneous, Non-Fibrous, Bulk Material Asbestos Types: Other Material: Non-fibrous 100 %			
093020SP34 14	220101196-34 Location: 1st Fl. / Women's Toilet (12) - Ceramic Wall Grout	No	NAD (by NYS ELAP 198.1) by Jared C. Clarke on 10/04/20
Analyst Description: White, Homogeneous, Non-Fibrous, Bulk Material Asbestos Types: Other Material: Non-fibrous 100 %			
093020SP35 15	220101196-35 Location: 1st Fl. / Storage (49) - Floor Tile Mastic (Black)	Yes	2.7 % (by NYS ELAP 198.6) by Jared C. Clarke on 10/04/20
Analyst Description: Black, Homogeneous, Non-Fibrous, Bulk Material Asbestos Types: Chrysotile 2.7 % Other Material: Non-fibrous 10.6 %			

Client Name: C. T. Male & Associates

PLM Bulk Asbestos Report

18.8318; 1 Venner Road; Amsterdam, NY

Client No. / HGA	Lab No.	Asbestos Present	Total % Asbestos
093020SP36 15	220101196-36 Location: 1st Fl. / Storage (49) - Floor Tile Mastic (Black)		NA/PS
Analyst Description: Bulk Material Asbestos Types: Other Material:			
093020SP37 16	220101196-37 Location: 1st Fl. / Storage (49) - 9" x 9" Floor Tile	Yes	5.7 % (by NYS ELAP 198.6) by Jared C. Clarke on 10/04/20
Analyst Description: Brown, Homogeneous, Non-Fibrous, Bulk Material Asbestos Types: Chrysotile 5.7 % Other Material: Non-fibrous 17.2 %			
093020SP38 16	220101196-38 Location: 1st Fl. / Storage (49) - 9" x 9" Floor Tile		NA/PS
Analyst Description: Bulk Material Asbestos Types: Other Material:			
093020SP39 17	220101196-39 Location: 1st Fl. / Lunch & Assembly Rm. (7) - Floor Tile Adhesive (Yellow)	No	NAD (by NYS ELAP 198.6) by Jared C. Clarke on 10/04/20
Analyst Description: Yellow, Homogeneous, Non-Fibrous, Bulk Material Asbestos Types: Other Material: Non-fibrous 42.6 %			
093020SP40 17	220101196-40 Location: 1st Fl. / Proof Rm. (21) - Floor Tile Adhesive (Yellow)	No	NAD (by NYS ELAP 198.6) by Jared C. Clarke on 10/04/20
Analyst Description: Yellow, Homogeneous, Non-Fibrous, Bulk Material Asbestos Types: Other Material: Non-fibrous 20.8 %			
093020SP41 18	220101196-41 Location: 1st Fl. / Lunch & Assembly Rm. (7) - 12" x 12" Floor Tile	No	NAD (by NYS ELAP 198.6) by Jared C. Clarke on 10/04/20
Analyst Description: Tan, Homogeneous, Non-Fibrous, Bulk Material Asbestos Types: Other Material: Non-fibrous 20.4 %			

Client Name: C. T. Male & Associates

PLM Bulk Asbestos Report

18.8318; 1 Venner Road; Amsterdam, NY

Client No. / HGA	Lab No.	Asbestos Present	Total % Asbestos
093020SP42 18	220101196-42 Location: 1st Fl. / Plate Rm. (79) - 12" x 12" Floor Tile	No	NAD (by NYS ELAP 198.6) by Jared C. Clarke on 10/04/20
Analyst Description: Grey, Homogeneous, Non-Fibrous, Bulk Material Asbestos Types: Other Material: Non-fibrous 0.7 %			
093020SP43 19	220101196-43 Location: 1st Fl. / Roof Rm. (21) - 12" x 12" Floor Tile (Thin)	Yes	4.9 % (by NYS ELAP 198.6) by Jared C. Clarke on 10/04/20
Analyst Description: Red, Homogeneous, Non-Fibrous, Bulk Material Asbestos Types: Chrysotile 4.9 % Other Material: Non-fibrous 13.3 %			
093020SP44 19	220101196-44 Location: 1st Fl. / Roof Rm. (21) - 12" x 12" Floor Tile (Thin)	No	NAD (by NYS ELAP 198.6) by Jared C. Clarke on 10/04/20
Analyst Description: Red, Homogeneous, Non-Fibrous, Bulk Material Asbestos Types: Other Material: Non-fibrous 17.9 %			
093020SP45 20	220101196-45 Location: 1st Fl. / Storage Rm. (5) - Self-Adhesive Floor Tile (Gray)	No	NAD (by NYS ELAP 198.6) by Jared C. Clarke on 10/04/20
Analyst Description: Blue, Homogeneous, Non-Fibrous, Bulk Material Asbestos Types: Other Material: Non-fibrous 3 %			
093020SP46 20	220101196-46 Location: 1st Fl. / Storage Rm. (5) - Self-Adhesive Floor Tile (Gray)	No	NAD (by NYS ELAP 198.6) by Jared C. Clarke on 10/04/20
Analyst Description: Blue, Homogeneous, Non-Fibrous, Bulk Material Asbestos Types: Other Material: Non-fibrous 3.3 %			
093020SP47 21	220101196-47 Location: 1st Fl. / Storage Rm. (5) - 1' x 2' Self-Adhesive Floor Tile	No	NAD (by NYS ELAP 198.6) by Jared C. Clarke on 10/04/20
Analyst Description: Tan, Homogeneous, Non-Fibrous, Bulk Material Asbestos Types: Other Material: Non-fibrous 1.9 %			

Client Name: C. T. Male & Associates

PLM Bulk Asbestos Report

18.8318; 1 Venner Road; Amsterdam, NY

Client No. / HGA	Lab No.	Asbestos Present	Total % Asbestos
093020SP48 21	220101196-48 Location: 1st Fl. / Storage Rm. (5) - 1' x 2' Self-Adhesive Floor Tile	No	NAD (by NYS ELAP 198.6) by Jared C. Clarke on 10/04/20
Analyst Description: Tan, Homogeneous, Non-Fibrous, Bulk Material Asbestos Types: Other Material: Non-fibrous 1.9 %			
093020SP49 22	220101196-49 Location: 1st Fl. / Publisher (32) - Faux-Wood Flooring	No	NAD (by NYS ELAP 198.6) by Jared C. Clarke on 10/04/20
Analyst Description: Brown, Homogeneous, Non-Fibrous, Bulk Material Asbestos Types: Other Material: Non-fibrous 0.6 %			
093020SP50 22	220101196-50 Location: 1st Fl. / Publisher (32) - Faux-Wood Flooring	No	NAD (by NYS ELAP 198.6) by Jared C. Clarke on 10/04/20
Analyst Description: Brown, Homogeneous, Non-Fibrous, Bulk Material Asbestos Types: Other Material: Non-fibrous 1.1 %			
093020SP51 23	220101196-51 Location: 1st Fl. / Publisher Closet (33) - Carpet Adhesive	No	NAD (by NYS ELAP 198.6) by Jared C. Clarke on 10/04/20
Analyst Description: Yellow, Homogeneous, Non-Fibrous, Bulk Material Asbestos Types: Other Material: Non-fibrous 23.3 %			
093020SP52 23	220101196-52 Location: 1st Fl. / Advertising Passage (56) - Carpet Adhesive	No	NAD (by NYS ELAP 198.6) by Jared C. Clarke on 10/04/20
Analyst Description: Brown, Homogeneous, Non-Fibrous, Bulk Material Asbestos Types: Other Material: Non-fibrous 27.3 %			
093020SP53 24	220101196-53 Location: 1st Fl. / Publisher Closet (33) - Cove Base Adhesive	No	NAD (by NYS ELAP 198.6) by Jared C. Clarke on 10/04/20
Analyst Description: Brown, Homogeneous, Non-Fibrous, Bulk Material Asbestos Types: Other Material: Non-fibrous 38.4 %			

Client Name: C. T. Male & Associates

PLM Bulk Asbestos Report

18.8318; 1 Venner Road; Amsterdam, NY

Client No. / HGA	Lab No.	Asbestos Present	Total % Asbestos
093020SP54 24	220101196-54 Location: 1st Fl. / Business Manager (39) - Cove Base Adhesive	No	NAD (by NYS ELAP 198.6) by Jared C. Clarke on 10/04/20
Analyst Description: Yellow, Homogeneous, Non-Fibrous, Bulk Material Asbestos Types: Other Material: Non-fibrous 17 %			
093020SP55 25	220101196-55 Location: 1st Fl. / Publisher Closet (33) - 4" Cove Base	No	NAD (by NYS ELAP 198.6) by Jared C. Clarke on 10/04/20
Analyst Description: Black, Homogeneous, Non-Fibrous, Bulk Material Asbestos Types: Other Material: Non-fibrous 0.6 %			
093020SP56 25	220101196-56 Location: 1st Fl. / Business Manager (39) - 4" Cove Base	No	NAD (by NYS ELAP 198.6) by Jared C. Clarke on 10/04/20
Analyst Description: Tan, Homogeneous, Non-Fibrous, Bulk Material Asbestos Types: Other Material: Non-fibrous 0.7 %			
093020SP57 26	220101196-57 Location: 1st Fl. / Press Room (65) / Stored Door - Fire Door Insulation	Yes	6 % (EPA 400 PC) by Jared C. Clarke on 10/04/20
Analyst Description: White, Homogeneous, Fibrous, Bulk Material Asbestos Types: Chrysotile 2.3 %, Amosite 3.8 % Other Material: Non-fibrous 94 %			
093020SP58 26	220101196-58 Location: 1st Fl. / Press Room (65) / Stored Door - Fire Door Insulation		NA/PS
Analyst Description: Bulk Material Asbestos Types: Other Material:			
093020SP59 27	220101196-59 Location: 1st Fl. / Business Manager (39) / Above Ceiling - Pipe Fitting Insulation	Yes	3 % (EPA 400 PC) by Jared C. Clarke on 10/04/20
Analyst Description: Grey, Homogeneous, Fibrous, Bulk Material Asbestos Types: Chrysotile 3.0 % Other Material: Fibrous glass 15 %, Non-fibrous 82 %			

Client Name: C. T. Male & Associates

PLM Bulk Asbestos Report

18.8318; 1 Venner Road; Amsterdam, NY

Client No. / HGA	Lab No.	Asbestos Present	Total % Asbestos
093020SP60 27	220101196-60 Location: 1st Fl. / Men's Locker Rm. (62) / Above Ceiling - Pipe Fitting Insulation		NA/PS
Analyst Description: Bulk Material Asbestos Types: Other Material:			
093020SP61 27	220101196-61 Location: 1st Fl. / Development Room (80) / Above Ceiling - Pipe Fitting Insulation		NA/PS
Analyst Description: Bulk Material Asbestos Types: Other Material:			
093020SP62 28	220101196-62 Location: 1st Fl. / Press Room (65) - Duct Insulation	Yes	23.5 % (by NYS ELAP 198.1) by Jared C. Clarke on 10/04/20
Analyst Description: Grey, Homogeneous, Fibrous, Bulk Material Asbestos Types: Chrysotile 23.5 % Other Material: Non-fibrous 76.5 %			
093020SP63 28	220101196-63 Location: 1st Fl. / Press Room (65) - Duct Insulation		NA/PS
Analyst Description: Bulk Material Asbestos Types: Other Material:			
093020SP64 28	220101196-64 Location: 1st Fl. / Press Room (65) - Duct Insulation		NA/PS
Analyst Description: Bulk Material Asbestos Types: Other Material:			
093020SP65 29	220101196-65 Location: 1st Fl. / Boiler Room (70) - Boiler Breeching Insulation	Yes	30.8 % (by NYS ELAP 198.1) by Jared C. Clarke on 10/04/20
Analyst Description: Grey, Heterogeneous, Fibrous, Bulk Material Asbestos Types: Chrysotile 30.8 % Other Material: Non-fibrous 69.2 %			

Client Name: C. T. Male & Associates

PLM Bulk Asbestos Report

18.8318; 1 Venner Road; Amsterdam, NY

Client No. / HGA	Lab No.	Asbestos Present	Total % Asbestos
093020SP66 29	220101196-66 Location: 1st Fl. / Boiler Room (70) - Boiler Breeching Insulation		NA/PS
Analyst Description: Bulk Material Asbestos Types: Other Material:			
093020SP67 29	220101196-67 Location: 1st Fl. / Boiler Room (70) - Boiler Breeching Insulation		NA/PS
Analyst Description: Bulk Material Asbestos Types: Other Material:			
093020SP68 30	220101196-68 Location: 1st Fl. / Boiler Room (70) - Tank Insulation	Yes	3.5 % (EPA 400 PC) by Jared C. Clarke on 10/04/20
Analyst Description: Grey, Homogeneous, Fibrous, Bulk Material Asbestos Types: Chrysotile 3.5 % Other Material: Fibrous glass 15 %, Non-fibrous 81.5 %			
093020SP69 30	220101196-69 Location: 1st Fl. / Boiler Room (70) - Tank Insulation		NA/PS
Analyst Description: Bulk Material Asbestos Types: Other Material:			
093020SP70 30	220101196-70 Location: 1st Fl. / Boiler Room (70) - Tank Insulation		NA/PS
Analyst Description: Bulk Material Asbestos Types: Other Material:			
093020SP71 31	220101196-71 Location: 1st Fl. / Entry Vestibule (1) - Duct Vibration Cloth	Yes	80 % (by NYS ELAP 198.1) by Jared C. Clarke on 10/04/20
Analyst Description: Grey, Homogeneous, Fibrous, Bulk Material Asbestos Types: Chrysotile 80.0 % Other Material: Synthetic fibers 15 %, Non-fibrous 5 %			

Client Name: C. T. Male & Associates

PLM Bulk Asbestos Report

18.8318; 1 Venner Road; Amsterdam, NY

Client No. / HGA	Lab No.	Asbestos Present	Total % Asbestos
093020SP72 31	220101196-72 Location: 1st Fl. / Entry Vestibule (1) - Duct Vibration Cloth		NA/PS
Analyst Description: Bulk Material Asbestos Types: Other Material:			
093020SP73 32	220101196-73 Location: 1st Fl. / Lunch & Assembly Rm. (7) / Interior - Window Glazing Compound	Yes	Trace (<0.25 % pc) ² (EPA 400 PC) by Jared C. Clarke on 10/04/20
Analyst Description: Grey, Homogeneous, Non-Fibrous, Bulk Material Asbestos Types: Chrysotile <0.25 % pc Other Material: Non-fibrous 3.1 %			
093020SP74 32	220101196-74 Location: 1st Fl. / Publisher (32) - Interior - Window Glazing Compound	Yes	Trace (<0.25 % pc) ² (EPA 400 PC) by Jared C. Clarke on 10/04/20
Analyst Description: Grey, Homogeneous, Non-Fibrous, Bulk Material Asbestos Types: Chrysotile <0.25 % pc Other Material: Non-fibrous 2.4 %			
093020SP75 33	220101196-75 Location: 1st Fl. / Passage (30) - Door Window Glazing Compound	No	NAD (by NYS ELAP 198.6) by Jared C. Clarke on 10/04/20
Analyst Description: Grey, Homogeneous, Non-Fibrous, Bulk Material Asbestos Types: Other Material: Non-fibrous 4.5 %			
093020SP76 33	220101196-76 Location: 1st Fl. / Machine Room (9) - Door Window Glazing Compound	Yes	Trace (<0.25 % pc) ² (EPA 400 PC) by Jared C. Clarke on 10/04/20
Analyst Description: Grey, Homogeneous, Non-Fibrous, Bulk Material Asbestos Types: Chrysotile <0.25 % pc Other Material: Non-fibrous 3.4 %			
093020SP77 34	220101196-77 Location: Exterior / Entry Vestibule (1) - Door Caulk	No	NAD (by NYS ELAP 198.6) by Jared C. Clarke on 10/04/20
Analyst Description: Grey, Homogeneous, Non-Fibrous, Bulk Material Asbestos Types: Other Material: Non-fibrous 8.2 %			

PLM Bulk Asbestos Report

18.8318; 1 Venner Road; Amsterdam, NY

Client No. / HGA	Lab No.	Asbestos Present	Total % Asbestos
093020SP78 34	220101196-78 Location: Exterior / Entry Vestibule (1) - Door Caulk	No	NAD (by NYS ELAP 198.6) by Jared C. Clarke on 10/04/20
Analyst Description: Grey, Homogeneous, Non-Fibrous, Bulk Material Asbestos Types: Other Material: Non-fibrous 7.7 %			
093020SP79 35	220101196-79 Location: Exterior / Front Of Building - Window Caulk	No	NAD (by NYS ELAP 198.6) by Jared C. Clarke on 10/04/20
Analyst Description: Grey, Homogeneous, Non-Fibrous, Bulk Material Asbestos Types: Other Material: Non-fibrous 0.6 %			
093020SP80 35	220101196-80 Location: Exterior / Front Of Building - Window Caulk	No	NAD (by NYS ELAP 198.6) by Jared C. Clarke on 10/04/20
Analyst Description: Grey, Homogeneous, Non-Fibrous, Bulk Material Asbestos Types: Other Material: Non-fibrous 0.6 %			

Reporting Notes:

- (1) This PLM job was analyzed using Motic BA310 Pol Scope S/N 1190000326
- (2) Sample prepared for analysis by ELAP 198.6 method

Analyzed by: Jared C. Clarke

*NAD/NSD =no asbestos detected; NA=not analyzed; NA/PS=not analyzed/positive stop, (SOF-V) = Sprayed On Fireproofing containing Vermiculite; (SM-V) = Surfacing Material containing Vermiculite; PLM Bulk Asbestos Analysis by Appd E to Subpt E, 40 CFR 763 (NVLAP 200546-0), ELAP PLM Method 198.1 for NY friable samples, which includes the identification and quantitation of vermiculite or ELAP 198.6 for NOB samples or EPA 400 pt ct by EPA 600-M4-82-020 (NY ELAP Lab 11480); Note:PLM is not consistently reliable in detecting asbestos in floor coverings and similar non-friable organically bound materials. NAD or Trace results by PLM are inconclusive, TEM is currently the only method that can be used to determine if this material can be considered or treated as non asbestos-containing in NY State (also see EPA Advisory for floor tile, FR 59,146,38970,8/1/94) National Institute of Standards and Technology Accreditation requirements mandate that this report must not be reproduced except in full without the approval of the lab.This PLM report relates ONLY to the items tested. AIHA-LAP, LLC Lab ID 102843, RI Cert AAL-094, CT Cert PH-0186, Mass Cert AA000054.

Reviewed By:

END OF REPORT

Client Name: C. T. Male & Associates

Table I
Summary of Bulk Asbestos Analysis Results
 18.8318; 1 Venner Road; Amsterdam, NY

AmeriSci Sample #	Client Sample#	HG Area	Sample Weight (gram)	Heat Sensitive Organic %	Acid Soluble Inorganic %	Insoluble Non-Asbestos Inorganic %	** Asbestos % by PLM/DS	** Asbestos % by TEM
01	093020SP01	1	----	----	----	----	NAD	NA
Location: 1st Fl. / Lobby Closet (3) - Plaster (Scratch Coat)								
02	093020SP02	1	----	----	----	----	NAD	NA
Location: 1st Fl. / Editorial Area (18) - Plaster (Scratch Coat)								
03	093020SP03	1	----	----	----	----	NAD	NA
Location: 1st Fl. / Editorial Area Storage (23) - Plaster (Scratch Coat)								
04	093020SP04	1	----	----	----	----	NAD	NA
Location: 1st Fl. / Publisher Closet (33) - Plaster (Scratch Coat)								
05	093020SP05	1	----	----	----	----	NAD	NA
Location: 1st Fl. / General Manager Closet (36) - Plaster (Scratch Coat)								
06	093020SP06	2	----	----	----	----	NAD	NA
Location: 1st Fl. / Lobby Closet (3) - Plaster (Finish Coat)								
07	093020SP07	2	----	----	----	----	NAD	NA
Location: 1st Fl. / Editorial Area (18) - Plaster (Finish Coat)								
08	093020SP08	2	----	----	----	----	NAD	NA
Location: 1st Fl. / Editorial Area Storage (23) - Plaster (Finish Coat)								
09	093020SP09	2	----	----	----	----	NAD	NA
Location: 1st Fl. / Publisher Closet (33) - Plaster (Finish Coat)								
10	093020SP10	2	----	----	----	----	NAD	NA
Location: 1st Fl. / General Manager Closet (36) - Plaster (Finish Coat)								
11	093020SP11	3	----	----	----	----	NAD	NA
Location: 1st Fl. / Lunch & Assembly Rm. (7) - Drywall								
12	093020SP12	3	----	----	----	----	NAD	NA
Location: 1st Fl. / Camera (81) - Drywall								
13	093020SP13	4	----	----	----	----	NAD	NA
Location: 1st Fl. / Lunch & Assembly Rm. (7) - Taping Compound								
14	093020SP14	4	----	----	----	----	NAD	NA
Location: 1st Fl. / Camera (81) - Taping Compound								
15	093020SP15	5	0.103	35.4	4.4	60.3	NAD	NAD
Location: 1st Fl. / Machine Shop (9) - 1' x 1' Ceiling Tile (Metal Faced)								
16	093020SP16	5	0.100	40.4	9.7	49.9	NAD	NAD
Location: 1st Fl. / Men's Locker Rm. (62) - 1' x 1' Ceiling Tile (Metal Faced)								

See Reporting notes on last page

Table I
Summary of Bulk Asbestos Analysis Results
 18.8318; 1 Venner Road; Amsterdam, NY

AmeriSci Sample #	Client Sample#	HG Area	Sample Weight (gram)	Heat Sensitive Organic %	Acid Soluble Inorganic %	Insoluble Non-Asbestos Inorganic %	** Asbestos % by PLM/DS	** Asbestos % by TEM
17	093020SP17	6	0.111	13.1	75.6	11.3	NAD	NAD
Location: 1st Fl. / Publisher (32) - 1' x 1' Ceiling Tile (Z-Spline)								
18	093020SP18	6	0.232	13.0	70.6	16.4	NAD	NAD
Location: 1st Fl. / Publisher (32) - 1' x 1' Ceiling Tile (Z-Spline)								
19	093020SP19	7	0.139	14.3	72.7	13.0	NAD	NAD
Location: 1st Fl. / Studio (28) - 1' x 2' Ceiling Tile (Z-Spline)								
20	093020SP20	7	0.180	12.6	72.9	14.5	NAD	NAD
Location: 1st Fl. / Advertising Lounge (57) - 1' x 2' Ceiling Tile (Z-Spline)								
21	093020SP21	8	0.206	13.1	69.9	17.0	NAD	NAD
Location: 1st Fl. / Waiting Rm. (37) - 2' x 2' Ceiling Tile (Z-Spline)								
22	093020SP22	8	0.126	12.9	75.5	11.6	NAD	NAD
Location: 1st Fl. / General Manager (38) - 2' x 2' Ceiling Tile (Z-Spline)								
23	093020SP23	9	0.137	28.9	22.7	48.4	NAD	NAD
Location: 1st Fl. / Lunch & Assembly Rm. (7) - 2' x 4' Ceiling Tile								
24	093020SP24	9	0.253	15.8	18.1	66.2	NAD	NAD
Location: 1st Fl. / Composing Area / Network Rm. (64) - 2' x 4' Ceiling Tile								
25	093020SP25	10	0.150	69.7	12.4	14.0	Chrysotile 4.0	NA
Location: 1st Fl. / Business Manager (39) - Wall Panel Adhesive								
26	093020SP26	10	0.213	69.2	13.0	17.8	NA/PS	NA
Location: 1st Fl. / Business Manager (39) - Wall Panel Adhesive								
27	093020SP27	11	----	----	----	----	NAD	NA
Location: 1st Fl. / Women's Toilet (12) - Ceramic Floor Set								
28	093020SP28	11	----	----	----	----	NAD	NA
Location: 1st Fl. / Passage (59) - Ceramic Floor Set								
29	093020SP29	12	----	----	----	----	NAD	NA
Location: 1st Fl. / Women's Toilet (12) - Ceramic Floor Grout								
30	093020SP30	12	----	----	----	----	NAD	NA
Location: 1st Fl. / Passage (59) - Ceramic Floor Grout								
31	093020SP31	13	0.230	5.9	40.3	53.8	NAD	NAD
Location: 1st Fl. / Women's Toilet (12) - Ceramic Wall Adhesive								
32	093020SP32	13	0.185	7.1	39.0	54.0	NAD	NAD
Location: 1st Fl. / Women's Toilet (12) - Ceramic Wall Adhesive								

Table I
Summary of Bulk Asbestos Analysis Results
 18.8318; 1 Venner Road; Amsterdam, NY

AmeriSci Sample #	Client Sample#	HG Area	Sample Weight (gram)	Heat Sensitive Organic %	Acid Soluble Inorganic %	Insoluble Non-Asbestos Inorganic %	** Asbestos % by PLM/DS	** Asbestos % by TEM
33	093020SP33	14	----	----	----	----	NAD	NA
Location: 1st Fl. / Women's Toilet (12) - Ceramic Wall Grout								
34	093020SP34	14	----	----	----	----	NAD	NA
Location: 1st Fl. / Women's Toilet (12) - Ceramic Wall Grout								
35	093020SP35	15	0.083	65.4	21.3	10.6	Chrysotile 2.7	NA
Location: 1st Fl. / Storage (49) - Floor Tile Mastic (Black)								
36	093020SP36	15	0.078	73.9	14.8	11.3	NA/PS	NA
Location: 1st Fl. / Storage (49) - Floor Tile Mastic (Black)								
37	093020SP37	16	0.104	28.6	48.5	17.2	Chrysotile 5.7	NA
Location: 1st Fl. / Storage (49) - 9" x 9" Floor Tile								
38	093020SP38	16	0.177	27.7	44.5	27.8	NA/PS	NA
Location: 1st Fl. / Storage (49) - 9" x 9" Floor Tile								
39	093020SP39	17	0.110	38.9	18.5	42.6	NAD	NAD
Location: 1st Fl. / Lunch & Assembly Rm. (7) - Floor Tile Adhesive (Yellow)								
40	093020SP40	17	0.119	59.8	19.4	20.8	NAD	NAD
Location: 1st Fl. / Proof Rm. (21) - Floor Tile Adhesive (Yellow)								
41	093020SP41	18	0.225	23.0	56.6	20.4	NAD	NAD
Location: 1st Fl. / Lunch & Assembly Rm. (7) - 12" x 12" Floor Tile								
42	093020SP42	18	0.192	15.5	83.8	0.7	NAD	NAD
Location: 1st Fl. / Plate Rm. (79) - 12" x 12" Floor Tile								
43	093020SP43	19	0.254	23.1	58.7	13.3	Chrysotile 4.9	NA
Location: 1st Fl. / Roof Rm. (21) - 12" x 12" Floor Tile (Thin)								
44	093020SP44	19	0.227	22.5	59.6	17.9	NAD	NA
Location: 1st Fl. / Roof Rm. (21) - 12" x 12" Floor Tile (Thin)								
45	093020SP45	20	0.181	26.9	70.1	3.0	NAD	NAD
Location: 1st Fl. / Storage Rm. (5) - Self-Adhesive Floor Tile (Gray)								
46	093020SP46	20	0.243	26.5	70.2	3.3	NAD	NAD
Location: 1st Fl. / Storage Rm. (5) - Self-Adhesive Floor Tile (Gray)								
47	093020SP47	21	0.123	33.0	65.1	1.9	NAD	NAD
Location: 1st Fl. / Storage Rm. (5) - 1' x 2' Self-Adhesive Floor Tile								
48	093020SP48	21	0.138	34.9	63.2	1.9	NAD	NAD
Location: 1st Fl. / Storage Rm. (5) - 1' x 2' Self-Adhesive Floor Tile								

Table I
Summary of Bulk Asbestos Analysis Results
 18.8318; 1 Venner Road; Amsterdam, NY

AmeriSci Sample #	Client Sample#	HG Area	Sample Weight (gram)	Heat Sensitive Organic %	Acid Soluble Inorganic %	Insoluble Non-Asbestos Inorganic %	** Asbestos % by PLM/DS	** Asbestos % by TEM
49	093020SP49	22	0.109	94.7	4.7	0.6	NAD	NAD
Location: 1st Fl. / Publisher (32) - Faux-Wood Flooring								
50	093020SP50	22	0.096	95.3	3.5	1.1	NAD	NAD
Location: 1st Fl. / Publisher (32) - Faux-Wood Flooring								
51	093020SP51	23	0.154	54.3	22.4	23.3	NAD	NAD
Location: 1st Fl. / Publisher Closet (33) - Carpet Adhesive								
52	093020SP52	23	0.397	67.9	4.8	27.3	NAD	NAD
Location: 1st Fl. / Advertising Passage (56) - Carpet Adhesive								
53	093020SP53	24	0.189	56.3	5.3	38.4	NAD	NAD
Location: 1st Fl. / Publisher Closet (33) - Cove Base Adhesive								
54	093020SP54	24	0.606	42.1	40.9	17.0	NAD	NAD
Location: 1st Fl. / Business Manager (39) - Cove Base Adhesive								
55	093020SP55	25	0.200	37.6	61.9	0.6	NAD	NAD
Location: 1st Fl. / Publisher Closet (33) - 4" Cove Base								
56	093020SP56	25	0.196	57.7	41.5	0.7	NAD	NAD
Location: 1st Fl. / Business Manager (39) - 4" Cove Base								
57	093020SP57	26	----	----	----	----	Chrysotile 2.3	NA
Location: 1st Fl. / Press Room (65) / Stored Door - Fire Door Insulation								
58	093020SP58	26	----	----	----	----	Amosite 3.8	NA
Location: 1st Fl. / Press Room (65) / Stored Door - Fire Door Insulation								
59	093020SP59	27	----	----	----	----	NA/PS	NA
Location: 1st Fl. / Business Manager (39) / Above Ceiling - Pipe Fitting Insulation								
60	093020SP60	27	----	----	----	----	Chrysotile 3.0	NA
Location: 1st Fl. / Men's Locker Rm. (62) / Above Ceiling - Pipe Fitting Insulation								
61	093020SP61	27	----	----	----	----	NA/PS	NA
Location: 1st Fl. / Development Room (80) / Above Ceiling - Pipe Fitting Insulation								
62	093020SP62	28	----	----	----	----	NA/PS	NA
Location: 1st Fl. / Press Room (65) - Duct Insulation								
63	093020SP63	28	----	----	----	----	Chrysotile 23.5	NA
Location: 1st Fl. / Press Room (65) - Duct Insulation								
64	093020SP64	28	----	----	----	----	NA/PS	NA
Location: 1st Fl. / Press Room (65) - Duct Insulation								
Location: 1st Fl. / Press Room (65) - Duct Insulation								

Client Name: C. T. Male & Associates

Table I
Summary of Bulk Asbestos Analysis Results
 18.8318; 1 Venner Road; Amsterdam, NY

AmeriSci Sample #	Client Sample#	HG Area	Sample Weight (gram)	Heat Sensitive Organic %	Acid Soluble Inorganic %	Insoluble Non-Asbestos Inorganic %	** Asbestos % by PLM/DS	** Asbestos % by TEM
65	093020SP65	29	----	----	----	----	Chrysotile 30.8	NA
Location: 1st Fl. / Boiler Room (70) - Boiler Breeching Insulation								
66	093020SP66	29	----	----	----	----	NA/PS	NA
Location: 1st Fl. / Boiler Room (70) - Boiler Breeching Insulation								
67	093020SP67	29	----	----	----	----	NA/PS	NA
Location: 1st Fl. / Boiler Room (70) - Boiler Breeching Insulation								
68	093020SP68	30	----	----	----	----	Chrysotile 3.5	NA
Location: 1st Fl. / Boiler Room (70) - Tank Insulation								
69	093020SP69	30	----	----	----	----	NA/PS	NA
Location: 1st Fl. / Boiler Room (70) - Tank Insulation								
70	093020SP70	30	----	----	----	----	NA/PS	NA
Location: 1st Fl. / Boiler Room (70) - Tank Insulation								
71	093020SP71	31	----	----	----	----	Chrysotile 80.0	NA
Location: 1st Fl. / Entry Vestibule (1) - Duct Vibration Cloth								
72	093020SP72	31	----	----	----	----	NA/PS	NA
Location: 1st Fl. / Entry Vestibule (1) - Duct Vibration Cloth								
73	093020SP73	32	0.200	7.4	89.6	2.9	Chrysotile <0.25	Chrysotile <1.0
Location: 1st Fl. / Lunch & Assembly Rm. (7) / Interior - Window Glazing Compound								
74	093020SP74	32	0.168	13.1	84.6	2.2	Chrysotile <0.25	Chrysotile <1.0
Location: 1st Fl. / Publisher (32) - Interior - Window Glazing Compound								
75	093020SP75	33	0.172	19.0	76.5	4.5	NAD	NAD
Location: 1st Fl. / Passage (30) - Door Window Glazing Compound								
76	093020SP76	33	0.247	12.5	84.1	3.2	Chrysotile <0.25	Chrysotile <1.0
Location: 1st Fl. / Machine Room (9) - Door Window Glazing Compound								
77	093020SP77	34	0.159	49.0	42.8	8.2	NAD	NAD
Location: Exterior / Entry Vestibule (1) - Door Caulk								
78	093020SP78	34	0.149	48.7	43.6	7.7	NAD	NAD
Location: Exterior / Entry Vestibule (1) - Door Caulk								
79	093020SP79	35	0.201	25.3	74.1	0.6	NAD	NAD
Location: Exterior / Front Of Building - Window Caulk								
80	093020SP80	35	0.357	25.3	74.0	0.6	NAD	NAD
Location: Exterior / Front Of Building - Window Caulk								

See Reporting notes on last page

Client Name: C. T. Male & Associates

Table I
Summary of Bulk Asbestos Analysis Results

18.8318; 1 Venner Road; Amsterdam, NY

AmeriSci Sample #	Client Sample#	HG Area	Sample Weight (gram)	Heat Sensitive Organic %	Acid Soluble Inorganic %	Insoluble Non-Asbestos Inorganic %	** Asbestos % by PLM/DS	** Asbestos % by TEM
----------------------	----------------	------------	----------------------------	--------------------------------	--------------------------------	--	----------------------------	-------------------------

Analyzed by: Gabriella Morozov



Date Analyzed 10/5/2020

Hitachi #747-Noran

**Quantitative Analysis (Semi/Full); Bulk Asbestos Analysis - PLM by Appd E to Subpt E, 40 CFR 763 or NYSDOH ELAP 198.1 for New York friable samples or NYSDOH ELAP 198.6 for New York NOB samples; TEM (Semi/Full) by EPA 600/R-93/116 (or NYSDOH ELAP 198.4; for New York samples); NAD = no asbestos detected during a quantitative analysis; NA = not analyzed; Trace = <1%; (SOF-V) = Sprayed On Fireproofing containing Vermiculite; (SM-V) = Surfacing Material containing Vermiculite; Quantitation for beginning weights of <0.1 grams should be considered as qualitative only; Qualitative Analysis: Asbestos analysis results of "Present" or "NVA = No Visible Asbestos" represents results for Qualitative PLM or TEM Analysis only (no accreditation coverage available from any regulatory agency for qualitative analyses); NVLAP (PLM) 200546-0, NYSDOH ELAP Lab 11480, AIHA-LAP, LLC (PLM) Lab ID 102843.

Warning Note: PLM limitation, only TEM will resolve fibers <0.25 micrometers in diameter. TEM bulk analysis is representative of the fine grained matrix material and may not be representative of non-uniformly dispersed debris for which PLM evaluation is recommended (i.e. soils and other heterogenous materials).

Reviewed By:

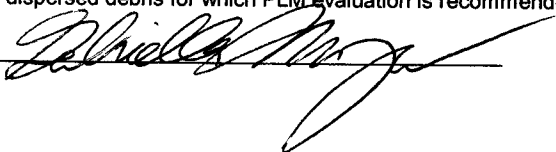

Relinquished By: S. Pierson
 Received By: [Signature]
 Relinquished By: _____
 Received By: _____

Date/Time: 10/1/20
 Date/Time: 10/2/20 1100
 Date/Time: _____
 Date/Time: _____

AMERISCI

p1 of 5

BULK SAMPLE SHEET

117 EAST 30TH STREET
 NEW YORK, NY 10016
 TOLL FREE (800) 705-5227
 Fax (212) 679-3114

Company: C.T. Male Associates

Project Name: 1 Venner Road

AMERISCI JOB #:

#220101196

Street Address: 50 Century Hill Drive

Project Address: Amsterdam, NY

Client Project #: 18.8318

City: Latham State: New York Zip: 12110

Project Manager: Sawyer

Phone: 518-786-7400

Analysis: X PLM Only X TEM Only X NY ELAP PLM/TEM (198.1/198.6/198.4)
 ___ ASTM Dust (Microvac) ___ ASTM Dust (Wipe) ___ Other (describe in comments)

E-Mail: m.sawyer@ctmale.com & s.pierson@ctmale.com

TAT: Rush ___ , 12Hr ___ , 24 Hr ___ , 48 Hr ___ , 72 Hr ___ , 5D X Mat'l Type: X Bulk ___ Air ___ Water

Results to: Mike Sawyer & Steve Pierson

Sampled By: S. Pierson

Date Sampled: 09/30/20

Special Instructions or Comments:
 (Check)

Positive Stop?

Field ID #	Sample Location	Sample Description/Material Type (for dust= size of surface area sampled)	Yes <u>X</u> No ___ Homogenous Area (HA #)
093020SP01	1 st Floor Lobby Closet (3)	Plaster (scratch coat)	01
02	Editorial Area (18)		01
03	Editorial Area Storage (23)		01
04	Publisher Closet (33)		01
05	General Manager Closet (36)		01
06	1 st Floor Lobby Closet (3)	Plaster (finish coat)	02
07	Editorial Area (18)		02
08	Editorial Area Storage (23)		02
09	Publisher Closet (33)		02
10	General Manager Closet (36)		02
11	1 st Floor Lunch + Assembly Rm. (7)	Drywall	03
12	Camera (81)		03
13	1 st Floor Lunch + Assembly Rm. (7)	Taping Compound	04
14	Camera (81)		04
15	1 st Floor Machine Shop (9)	1'x1' Metal Faced Ceiling Tile	05
16	Men's Locker Rm. (62)		05
17	1 st Floor Publisher (32)	1'x1' Z-spline Ceiling Tile	06

Relinquished By: S. Pierson / *[Signature]*
 Received By: *[Signature]*
 Relinquished By:
 Received By:

Date/Time: 10/1/20
 Date/Time: 10/2/20 1100
 Date/Time:
 Date/Time:

AMERI SCI

p2 of 5

BULK SAMPLE SHEET
 117 EAST 30TH STREET
 NEW YORK, NY 10016
 TOLL FREE (800) 705-5227
 Fax (212) 679-3114

Company: C.T. Male Associates	Project Name: 1 Venner Road	AMERISCI JOB #: #220101196
Street Address: 50 Century Hill Drive	Project Address: Amsterdam, NY	Client Project #: 18.8318
City: Latham State: New York Zip: 12110	Project Manager: Sawyer	
Phone: 518-786-7400	Analysis: <input checked="" type="checkbox"/> PLM Only <input checked="" type="checkbox"/> TEM Only <input checked="" type="checkbox"/> NY ELAP PLM/TEM (198.1/198.6/198.4) <input type="checkbox"/> ASTM Dust (Microvac) <input type="checkbox"/> ASTM Dust (Wipe) <input type="checkbox"/> Other (describe in comments)	
E-Mail: m.sawyer@ctmale.com & s.pierson@ctmale.com	TAT: Rush <input type="checkbox"/> 12Hr <input type="checkbox"/> 24 Hr <input type="checkbox"/> 48 Hr <input type="checkbox"/> 72 Hr <input checked="" type="checkbox"/> 5D <input checked="" type="checkbox"/> Mat'l Type: <input checked="" type="checkbox"/> Bulk <input type="checkbox"/> Air <input type="checkbox"/> Water	
Results to: Mike Sawyer & Steve Pierson	Sampled By: S. Pierson	Date Sampled: 09/30/20
Special Instructions or Comments: (Check)		Positive Stop?

Field ID #	Sample Location	Sample Description/Material Type (for dust= size of surface area sampled)	Yes <input checked="" type="checkbox"/> No <input type="checkbox"/> Homogenous Area (HA #)
093020SP18	1 st Floor Publisher (32)	1'x1' z-spline Ceiling Tile	06
19	1 st Floor Studio (28)	1'x2' z-spline Ceiling Tile	07
20	↓ Advertising Storage (57)	↓	07
21	1 st Floor Waiting Rm. (37)	2'x2' z-spline Ceiling Tile	08
22	↓ General Manager (38)	↓	08
23	1 st Floor Lunch + Assembly Rm. (7)	2'x4' Ceiling Tile	09
24	↓ Composing Area - Network Rm. (64)	↓	09
25	1 st Floor Business Manager (39)	Wall Panel Adhesive	10
26	↓ Business Manager (39)	↓	10
27	1 st Floor Women's Toilet (12)	Ceramic Floor Set	11
28	↓ Passage (59)	↓	11
29	1 st Floor Women's Toilet (12)	Ceramic Floor Grout	12
30	↓ Passage (59)	↓	12
31	1 st Floor Women's Toilet (12)	Ceramic Wall Adhesive	13
32	↓	↓	13
33	↓	Ceramic Wall Grout	14
34	↓	↓	14

Relinquished By: S. Pierson / [Signature]
 Received By: [Signature]
 Relinquished By: _____
 Received By: _____

Date/Time: 10/1/20
 Date/Time: 10/2/20 1100
 Date/Time: _____
 Date/Time: _____

AMERI SCI
p3 of 5

BULK SAMPLE SHEET
 117 EAST 30TH STREET
 NEW YORK, NY 10016
 TOLL FREE (800) 705-5227
 Fax (212) 679-3114

Company: C.T. Male Associates	Project Name: 1 Venner Road	AMERISCI JOB #: #220101196
Street Address: 50 Century Hill Drive	Project Address: Amsterdam, NY	Client Project #: 18.8318
City: Latham State: New York Zip: 12110	Project Manager: Sawyer	
Phone: 518-786-7400	Analysis: <input checked="" type="checkbox"/> PLM Only <input checked="" type="checkbox"/> TEM Only <input checked="" type="checkbox"/> NY ELAP PLM/TEM (198.1/198.6/198.4) <input type="checkbox"/> ASTM Dust (Microvac) <input type="checkbox"/> ASTM Dust (Wipe) <input type="checkbox"/> Other (describe in comments)	
E-Mail: <u>m.sawyer@ctmale.com</u> & <u>s.pierson@ctmale.com</u>	TAT: Rush <input type="checkbox"/> , 12Hr <input type="checkbox"/> , 24 Hr <input type="checkbox"/> , 48 Hr <input type="checkbox"/> , 72 Hr <input type="checkbox"/> , <u>5D</u> <input checked="" type="checkbox"/> Mat'l Type: <input checked="" type="checkbox"/> Bulk <input type="checkbox"/> Air <input type="checkbox"/> Water	
Results to: Mike Sawyer & Steve Pierson	Sampled By: S. Pierson	Date Sampled: 09/30/20
Special Instructions or Comments: (Check)	Positive Stop?	

Field ID #	Sample Location	Sample Description/Material Type (for dust= size of surface area sampled)	Yes <input checked="" type="checkbox"/> No <input type="checkbox"/> Homogenous Area (HA #)
093020SP35	1 st Floor Storage (49)	Floor Tile Mastic (black)	15
36	↓	↓	15
37	1 st Floor Storage (49)	9"x9" Floor Tile	16
38	↓	↓	16
39	1 st Floor Lunch + Assembly Rm. (7)	Floor Tile Adhesive (yellow)	17
40	↓	↓	17
41	1 st Floor Lunch + Assembly Rm. (7)	12"x12" Floor Tile	18
42	↓	↓	18
43	1 st Floor Plate Rm. (79)	12"x12" Floor Tile (thin)	19
44	↓	↓	19
45	1 st Floor Storage Rm. (5)	Self-Adhesive Floor Tile (gray)	20
46	↓	↓	20
47	↓	1'x2' Self-Adhesive Floor Tile	21
48	↓	↓	21
49	1 st Floor Publisher (32)	Faux-Wood Flooring	22
50	↓	↓	22
51	1 st Floor Publisher (32) Closet (33)	Carpet Adhesive	23

Relinquished By: S. Pierson / *[Signature]*
 Received By: *[Signature]*
 Relinquished By: *[Signature]*
 Received By: *[Signature]*

Date/Time: 10/1/20
 Date/Time: 10/2/20 1100
 Date/Time: *[Blank]*
 Date/Time: *[Blank]*

AMERISCI

p4 of 5

BULK SAMPLE SHEET
 117 EAST 30TH STREET
 NEW YORK, NY 10016
 TOLL FREE (800) 705-5227
 Fax (212) 679-3114

Company: C.T. Male Associates	Project Name: 1 Venner Road	AMERISCI JOB #: #220101196
Street Address: 50 Century Hill Drive	Project Address: Amsterdam, NY	Client Project #: 18.8318
City: Latham State: New York Zip: 12110	Project Manager: Sawyer	
Phone: 518-786-7400	Analysis: <input checked="" type="checkbox"/> PLM Only <input checked="" type="checkbox"/> TEM Only <input checked="" type="checkbox"/> NY ELAP PLM/TEM (198.1/198.6/198.4) <input type="checkbox"/> ASTM Dust (Microvac) <input type="checkbox"/> ASTM Dust (Wipe) <input type="checkbox"/> Other (describe in comments)	
E-Mail: m.sawyer@ctmale.com & s.pierson@ctmale.com	TAT: Rush <input type="checkbox"/> 12Hr <input type="checkbox"/> 24 Hr <input type="checkbox"/> 48 Hr <input type="checkbox"/> 72 Hr <input checked="" type="checkbox"/> 5D <input checked="" type="checkbox"/> Mat'l Type: <input checked="" type="checkbox"/> Bulk <input type="checkbox"/> Air <input type="checkbox"/> Water	
Results to: Mike Sawyer & Steve Pierson	Sampled By: S. Pierson	Date Sampled: 09/30/20
Special Instructions or Comments: (Check)		Positive Stop?

Field ID #	Sample Location	Sample Description/Material Type (for dust= size of surface area sampled)	Yes <input checked="" type="checkbox"/> No <input type="checkbox"/> Homogenous Area (HA #)
093020SP52	1 st Floor Advertising Passage (56)	Carpet Adhesive	23
53	1 st Floor Publisher Closet (33)	Cove Base Adhesive	24
54	↓ Business Manager (39)	Cove Base Adhesive	24
55	1 st Floor Publisher Closet (33)	4" Cove Base	25
56	↓ Business Manager (39)	↓	25
57	1 st Floor Press Room (65) (stored door)	Fire Door Insulation	26
58	↓	↓	26
59	1 st Floor Business Manager (39) (above ceiling)	Pipe Fitting Insulation	27
60	↓ Men's Locker Room (62) (above ceiling)	↓	27
61	↓ Development Room (80) (above ceiling)	↓	27
62	1 st Floor Press Room (65)	Duct Insulation	28
63	↓	↓	28
64	↓	↓	28
65	1 st Floor Boiler Room (70)	Boiler Breaching Insulation	29
66	↓	↓	29
67	↓	↓	29
68	1 st Floor Boiler Room (70)	Tank Insulation	30

Relinquished By: S. Pierson
 Received By: H. Pierson
 Relinquished By: _____
 Received By: _____

Date/Time: 10/1/20
 Date/Time: 10/2/20 1100
 Date/Time: _____
 Date/Time: _____

AMERI SCI
p5 of 5

BULK SAMPLE SHEET
 117 EAST 30TH STREET
 NEW YORK, NY 10016
 TOLL FREE (800) 705-5227
 Fax (212) 679-3114

Company: C.T. Male Associates		Project Name: 1 Venner Road	AMERISCI JOB #: #220101196
Street Address: 50 Century Hill Drive		Project Address: Amsterdam, NY	Client Project #: 18.8318
City: Latham	State: New York	Zip: 12110	Project Manager: Sawyer
Phone: 518-786-7400		Analysis: <u>X</u> PLM Only <u>X</u> TEM Only <u>X</u> NY ELAP PLM/TEM (198.1/198.6/198.4) ___ ASTM Dust (Microvac) ___ ASTM Dust (Wipe) ___ Other (describe in comments)	
E-Mail: <u>m.sawyer@ctmale.com</u> & <u>s.pierson@ctmale.com</u>		TAT: Rush ___ , 12Hr ___ , 24 Hr ___ , 48 Hr ___ , 72 Hr ___ , <u>5D X</u> Mat'l Type: <u>X</u> Bulk ___ Air ___ Water	
Results to: Mike Sawyer & Steve Pierson		Sampled By: S. Pierson	
Special Instructions or Comments: (Check)		Date Sampled: 09/30/20 Positive Stop?	

Field ID #	Sample Location	Sample Description/Material Type (for dust= size of surface area sampled)	Yes <u>X</u> No ___ Homogenous Area (HA #)
093020SP69	1 st Floor Boiler Room (70)	Tank Insulation	30
70	↓	↓	30
71	1 st Floor Entry Vestibule (1)	Duct Vibration cloth	31
72	↓	↓	31
73	1 st Floor Lunch & Assembly Rm (7) (Interior)	Window Glazing Compound	32
74	↓ Publisher (32) (Interior)	↓	32
75	1 st Floor Passage (30)	Door Window Glazing Compound	33
76	↓ Machine Room (9)	↓	33
77	Exterior Entry Vestibule (1)	Door Caulk	34
78	↓	↓	34
79	Exterior Front of Building	Window Caulk	35
80	↓	↓	35

APPENDIX D

BUILDING PLAN

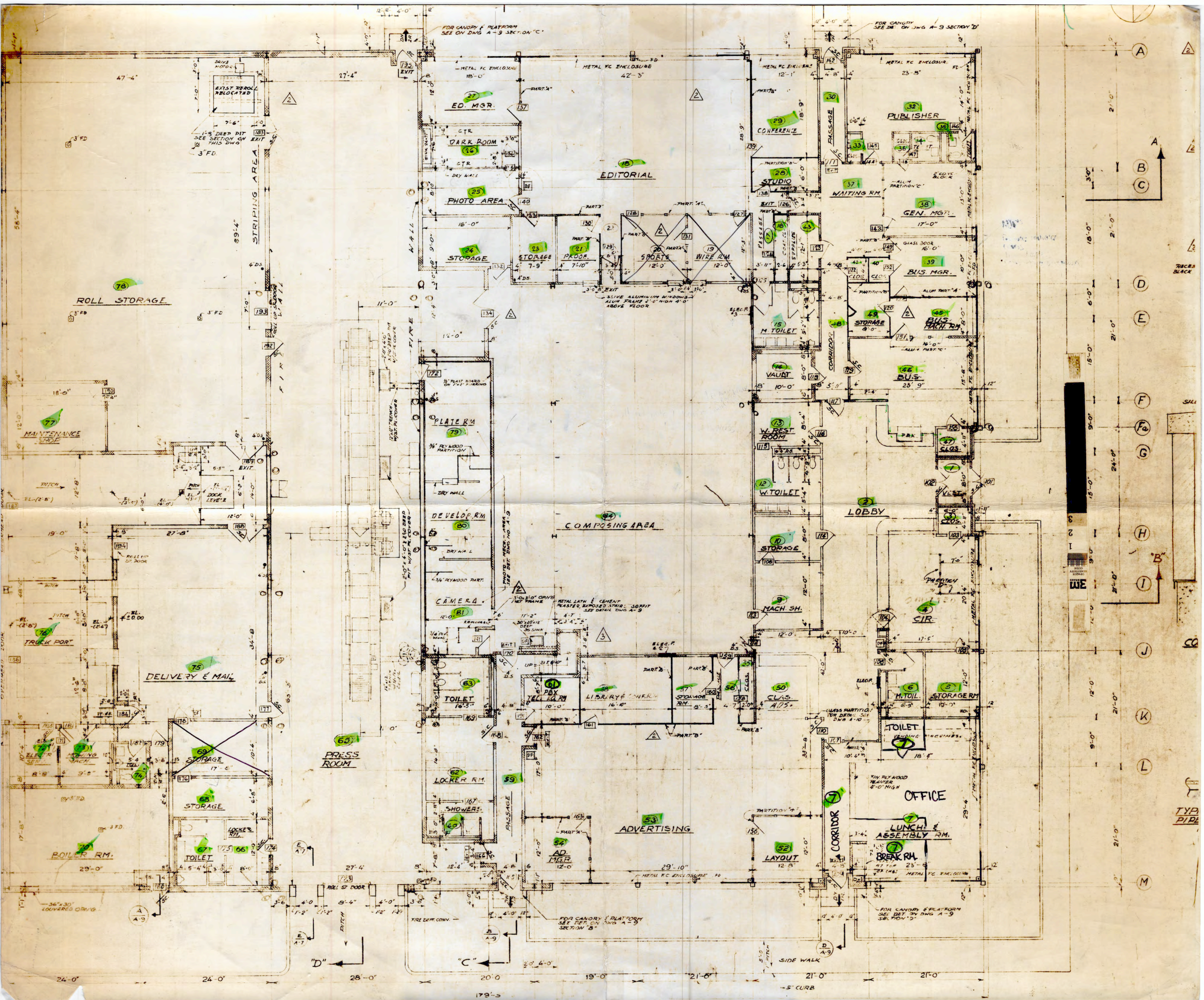

APPENDIX E

**ACM SURVEY
ABATEMENT COST ESTIMATES**

Proj. No.: 20.0649 **Date:** 10/9/2020
Project: 1 Venner Road, Amsterdam, NY

LOCATION \ MATERIAL	UNIT	QTY	UNIT PRICE	COST	TOTAL COST
Throughout					
Fire Doors					
Fire Door Insulation	Ea.	30	\$125.00	\$3,750.00	\$3,750.00
Behind Metal Radiator Covers					
Pipe Fitting Insulation	Ln. Ft.	Unknown	TBD	TBD	TBD
1st Floor					
Vestibule (1)					
Above Ceiling					
Pipe Fitting Insulation	Ln. Ft.	15	\$75.00	\$1,125.00	\$1,125.00
Duct Vibration Joint Cloth	Sq. Ft.	10	\$50.00	\$500.00	\$500.00
Lobby (2)					
Throughout					
Wall Panel Adhesive	Sq. Ft.	320	\$6.00	\$1,920.00	\$1,920.00
Circulation (4)					
Throughout					
Wall Panel Adhesive	Sq. Ft.	80	\$12.00	\$960.00	\$960.00
Storage Room (5)					
Above Ceiling					
Pipe Fitting Insulation	Ln. Ft.	Unknown	TBD	TBD	TBD
Throughout					
Floor Tile & Mastic	Sq. Ft.	120	\$9.00	\$1,080.00	\$1,080.00
(under 2 layers non-ACM tile)					
Men's Toilet (6)					
Above Ceiling/In Walls					
Pipe Fitting Insulation	Ln. Ft.	Unknown	TBD	TBD	TBD
Lunch & Assembly Area (7)					
Office Area					
Above Ceiling					
Pipe Fitting Insulation	Ln. Ft.	8	\$125.00	\$1,000.00	\$1,000.00
Lunch & Assembly Area (7)					
Break Area					
Above Ceiling					
Pipe Fitting Insulation	Ln. Ft.	Unknown	TBD	TBD	TBD
Lunch & Assembly Area (7)					
Corridor					
Above Ceiling					
Pipe Fitting Insulation	Ln. Ft.	Unknown	TBD	TBD	TBD

Proj. No.: 20.0649 **Date:** 10/9/2020
Project: 1 Venner Road, Amsterdam, NY

LOCATION \ MATERIAL	UNIT	QTY	UNIT PRICE	COST	TOTAL COST
1st Floor - Continued					
Mach. Sh. (9)					
Throughout					
Floor Tile & Mastic	Sq. Ft.	144	\$8.00	\$1,152.00	\$1,152.00
Storage (10)					
Throughout					
Floor Tile & Mastic	Sq. Ft.	96	\$8.00	\$768.00	\$768.00
Women's Toilet (12)					
Above Ceiling/In Walls					
Pipe Fitting Insulation	Ln. Ft.	Unknown	TBD	TBD	TBD
Women's Restroom (13)					
Above Ceiling					
Pipe Fitting Insulation	Ln. Ft.	Unknown	TBD	TBD	TBD
Vault (14)					
Throughout					
Floor Tile & Mastic	Sq. Ft.	80	\$12.00	\$960.00	\$960.00
Men's Toilet (15)					
Above Ceiling/In Walls					
Pipe Fitting Insulation	Ln. Ft.	16	\$100.00	\$1,600.00	\$1,600.00
Editorial (18)					
Above Ceiling					
Pipe Fitting Insulation	Ln. Ft.	25	\$100.00	\$2,500.00	\$2,500.00
Proofreading (21)					
Throughout					
Floor Tile - Not Mastic	Sq. Ft.	96	\$10.00	\$960.00	\$960.00
(under carpet)					
Storage (23)					
Throughout					
Floor Tile & Mastic	Sq. Ft.	96	\$11.00	\$1,056.00	\$1,056.00
Storage (24)					
Throughout					
Floor Tile & Mastic	Sq. Ft.	144	\$8.00	\$1,152.00	\$1,152.00

Proj. No.: 20.0649 **Date:** 10/9/2020
Project: 1 Venner Road, Amsterdam, NY

LOCATION \ MATERIAL	UNIT	QTY	UNIT PRICE	COST	TOTAL COST
1st Floor - Continued					
Photo Area/Dark Room (25-26)					
Above Ceiling					
Pipe Fitting Insulation	Ln. Ft.	5	\$200.00	\$1,000.00	\$1,000.00
Throughout					
Floor Tile Mastic	Sq. Ft.	306	\$6.00	\$1,836.00	\$1,836.00
(no tile, under carpet)					
Editorial Manager (27)					
Above Ceiling					
Pipe Fitting Insulation	Ln. Ft.	7	\$150.00	\$1,050.00	\$1,050.00
Conference (29)					
Above Ceiling					
Pipe Fitting Insulation	Ln. Ft.	8	\$150.00	\$1,200.00	\$1,200.00
Publisher (32)					
Above Ceiling					
Pipe Fitting Insulation	Ln. Ft.	Unknown	TBD	TBD	TBD
Throughout					
Wall Panel Adhesive	Sq. Ft.	608	\$4.00	\$2,432.00	\$2,432.00
General Manager Toilet (34)					
Above Ceiling/In Walls					
Pipe Fitting Insulation	Ln. Ft.	4	\$250.00	\$1,000.00	\$1,000.00
Publisher Toilet (35)					
Above Ceiling/In Walls					
Pipe Fitting Insulation	Ln. Ft.	4	\$250.00	\$1,000.00	\$1,000.00
General Manager (38)					
Above Ceiling					
Pipe Fitting Insulation	Ln. Ft.	5	\$200.00	\$1,000.00	\$1,000.00
Throughout					
Wall Panel Adhesive	Sq. Ft.	136	\$8.00	\$1,088.00	\$1,088.00
Business Manager (39)					
Above Ceiling					
Pipe Fitting Insulation	Ln. Ft.	12	\$80.00	\$960.00	\$960.00
Pipe Fitting Insulation Debris	Sq. Ft.	8	\$100.00	\$800.00	\$800.00
Throughout					
Wall Panel Adhesive	Sq. Ft.	136	\$8.00	\$1,088.00	\$1,088.00

Proj. No.: 20.0649 **Date:** 10/9/2020
Project: 1 Venner Road, Amsterdam, NY

LOCATION \ MATERIAL	UNIT	QTY	UNIT PRICE	COST	TOTAL COST
1st Floor - Continued					
Supplies (43)					
Throughout					
Floor Tile & Mastic	Sq. Ft.	72	\$14.00	\$1,008.00	\$1,008.00
Business/Business Machine Room (45-46)					
Above Ceiling					
Pipe Fitting Insulation	Ln. Ft.	4	\$250.00	\$1,000.00	\$1,000.00
Throughout					
Wall Panel Adhesive	Sq. Ft.	216	\$6.00	\$1,296.00	\$1,296.00
Storage (49)					
Throughout					
Floor Tile & Mastic	Sq. Ft.	72	\$14.00	\$1,008.00	\$1,008.00
Classified Advertising (50)					
Throughout					
Wall Panel Adhesive	Sq. Ft.	224	\$6.00	\$1,344.00	\$1,344.00
Layout (52)					
Above Ceiling					
Pipe Fitting Insulation	Ln. Ft.	2	\$500.00	\$1,000.00	\$1,000.00
Advertising (53)					
Above Ceiling					
Pipe Fitting Insulation	Ln. Ft.	14	\$100.00	\$1,400.00	\$1,400.00
Pipe Fitting Insulation Debris	Sq. Ft.	12	\$100.00	\$1,200.00	\$1,200.00
Throughout					
Wall Panel Adhesive	Sq. Ft.	304	\$6.00	\$1,824.00	\$1,824.00
Advertising Manager (54)					
Above Ceiling					
Pipe Fitting Insulation	Ln. Ft.	4	\$250.00	\$1,000.00	\$1,000.00
Closet/Passage (55-56)					
Above Ceiling					
Pipe Fitting Insulation	Ln. Ft.	3	\$300.00	\$900.00	\$900.00

Proj. No.: 20.0649 **Date:** 10/9/2020
Project: 1 Venner Road, Amsterdam, NY

LOCATION \ MATERIAL	UNIT	QTY	UNIT PRICE	COST	TOTAL COST
1st Floor - Continued					
Storage Room (57)					
Above Ceiling					
Pipe Fitting Insulation	Ln. Ft.	10	\$100.00	\$1,000.00	\$1,000.00
Pipe Fitting Insulation Debris	Sq. Ft.	2	\$250.00	\$500.00	\$500.00
Below Ceiling					
Pipe Fitting Insulation	Ln. Ft.	1	\$100.00	\$100.00	\$100.00
Throughout					
Floor Tile & Mastic	Sq. Ft.	108	\$8.00	\$864.00	\$864.00
Passage (59)					
Above Ceiling					
Pipe Fitting Insulation	Ln. Ft.	1	\$500.00	\$500.00	\$500.00
Roof Drain Insulation	Sq. Ft.	2	\$250.00	\$500.00	\$500.00
Showers (60)					
Above Ceiling/In Walls					
Pipe Fitting Insulation	Ln. Ft.	8	\$100.00	\$800.00	\$800.00
Pipe Fitting Insulation Debris	Sq. Ft.	12	\$50.00	\$600.00	\$600.00
PBX - Telephone Equipment Room (61)					
Throughout					
Floor Tile & Mastic	Sq. Ft.	90	\$12.00	\$1,080.00	\$1,080.00
Locker Room (62)					
Above Ceiling					
Pipe Fitting Insulation	Ln. Ft.	10	\$100.00	\$1,000.00	\$1,000.00
Pipe Fitting Insulation Debris	Sq. Ft.	12	\$50.00	\$600.00	\$600.00
Toilet (63)					
Above Ceiling/In Walls					
Pipe Fitting Insulation	Ln. Ft.	16	\$75.00	\$1,200.00	\$1,200.00
Pipe Fitting Insulation Debris	Sq. Ft.	12	\$50.00	\$600.00	\$600.00
Composing Area (64)					
9 Rooms & 2 Closets					
Above Ceiling					
Pipe Fitting Insulation	Ln. Ft.	40	\$100.00	\$4,000.00	\$4,000.00
Throughout					
Floor Tile & Mastic	Sq. Ft.	2,925	\$8.00	\$23,400.00	\$23,400.00
(1,460 Sq. Ft. under carpet, 300 Sq. Ft. under raised floor)					

Proj. No.: 20.0649 **Date:** 10/9/2020
Project: 1 Venner Road, Amsterdam, NY

LOCATION \ MATERIAL	UNIT	QTY	UNIT PRICE	COST	TOTAL COST
1st Floor - Continued					
Press Room (65)					
Throughout					
Pipe Fitting Insulation	Ln. Ft.	20	\$200.00	\$4,000.00	\$4,000.00
Duct Insulation	Ln. Ft.	65	\$25.00	\$1,625.00	\$1,625.00
Toilet (67)					
Above Ceiling/ In Walls					
Pipe Fitting Insulation	Ln. Ft.	12	\$100.00	\$1,200.00	\$1,200.00
Storage (68)					
Throughout					
Pipe Fitting Insulation	Ln. Ft.	11	\$100.00	\$1,100.00	\$1,100.00
Boiler Room (70)					
Throughout					
Pipe Fitting Insulation	Ln. Ft.	75	\$30.00	\$2,250.00	\$2,250.00
Breeching Insulation	Sq. Ft.	80	\$25.00	\$2,000.00	\$2,000.00
Tank Insulation	Sq. Ft.	100	\$25.00	\$2,500.00	\$2,500.00
Tank Insulation Debris	Sq. Ft.	4	\$150.00	\$600.00	\$600.00
Toilet (74)					
Above Ceiling/ In Walls					
Pipe Fitting Insulation	Ln. Ft.	10	\$100.00	\$1,000.00	\$1,000.00
Pipe Fitting Insulation Debris	Sq. Ft.	12	\$50.00	\$600.00	\$600.00
Delivery & Mail (75)					
Throughout					
Pipe Fitting Insulation	Ln. Ft.	4	\$250.00	\$1,000.00	\$1,000.00
Truck Port (76)					
Throughout					
Pipe Fitting Insulation	Ln. Ft.	20	\$100.00	\$2,000.00	\$2,000.00
Maintenance Shop (77)					
Throughout					
Pipe Fitting Insulation	Ln. Ft.	8	\$125.00	\$1,000.00	\$1,000.00
Roll Storage (78)					
Throughout					
Pipe Fitting Insulation	Ln. Ft.	30	\$75.00	\$2,250.00	\$2,250.00
Roof Drain Insulation	Sq. Ft.	2	\$250.00	\$500.00	\$500.00

Proj. No.: 20.0649 Date: 10/9/2020
Project: 1 Venner Road, Amsterdam, NY

LOCATION \ MATERIAL	UNIT	QTY	UNIT PRICE	COST	TOTAL COST
1st Floor - Continued					
Plate Room/Development Room/Camera (79-80-81)					
Above Ceiling					
Pipe Fitting Insulation	Ln. Ft.	15	\$100.00	\$1,500.00	\$1,500.00
Pipe Fitting Insulation Debris	Sq. Ft.	8	\$50.00	\$400.00	\$400.00
Throughout					
Floor Tile & Mastic	Sq. Ft.	624	\$8.00	\$4,992.00	\$4,992.00
Mezzanine					
Mechanical Room					
Throughout					
Pipe Fitting Insulation	Ln. Ft.	90	\$50.00	\$4,500.00	\$4,500.00
Pipe Fitting Insulation Debris	Sq. Ft.	10	\$100.00	\$1,000.00	\$1,000.00
Duct Vibration Joint Cloth	Sq. Ft.	24	\$50.00	\$1,200.00	\$1,200.00
2nd Floor					
Mechanical Room					
Throughout					
Pipe Fitting Insulation	Ln. Ft.	90	\$50.00	\$4,500.00	\$4,500.00
Roof Drain Insulation	Sq. Ft.	2	\$100.00	\$200.00	\$200.00
Tank Insulation	Sq. Ft.	50	\$25.00	\$1,250.00	\$1,250.00
Apartment					
Kitchen/Bath					
In Walls					
Pipe Fitting Insulation	Ln. Ft.	Unknown	TBD	TBD	TBD
Throughout					
Floor Tile & Mastic	Sq. Ft.	750	\$8.00	\$6,000.00	\$6,000.00
(196 Sq. Ft. under carpet)					
Living Room					
Wall Panel Adhesive	Sq. Ft.	448	\$6.00	\$2,688.00	\$2,688.00
SUB-TOTAL					\$136,516.00
ASSOCIATED ASBESTOS ABATEMENT COSTS (Estimated)					
Project/Air Monitoring			\$ 14,500.00		\$ 14,500.00
NYSDOL Site-Specific Variance			\$ 2,500.00		\$ 2,500.00
ESTIMATED ASSOCIATED COSTS			SUB-TOTAL		\$ 17,000.00

ESTIMATED PROJECT TOTAL

\$153,516.00